



POLYSTO
strong in hygienic construction



CATALOG
2025 English v.1

Contents

Polysto group BV
Technology

CleanSheets and panels

Prefab skirtings and kerbs

Polyethylene wall ledges
Stainless steel protection

Logistic impact protection

Stainless steel drainage
Lights, windows, doors

Installation materials

3	Why choose PolySto?
8	CleanSheet
12	CleanRock®
14	HygiSeal
18	CleanSheet
20	RamPanel
22	HygiWall
26	InsuPanel
28	RenoPanel
30	HygiCeiling
31	Consumption guidelines
32	Profiles
38	Ceiling suspension
40	Different versions and type of finishing
41	Impact levels
42	Full core PVC skirtings
43	CleanRock kerbs and skirtings
47	Consumption guidelines
48	Stainless Steel kerbs and skirtings
52	Polyethylene wall ledges
54	Stainless steel column protection
56	Stainless steel bollards
57	Stainless steel barriers
60	Prefabricated concrete kerbs
61	Polyethylene logistic kerbs
62	Stainless steel drainage
63	HygiLights
64	Hygienic Wall Boots
65	HygiCrystal
66	HygiDoors
68	Accessories and installation equipment

Why choose PolySto?

PolySto provides maximum protection for hygienic areas, from floor to ceiling.

As a Belgian company with over 30 years of expertise, we design and manufacture hygienic building materials tailored to demanding industries like food processing, pharmaceuticals, life sciences, and healthcare. Our mission is to provide durable, high-quality solutions that uphold hygiene and food safety, even in the toughest conditions.

Our product range includes prefabricated **CleanRock** kerbs, coved skirtings, polyethylene wall ledges, stainless steel posts, and bollards—all engineered for maximum hygiene and impact resistance. We also offer **CleanSheet** wall and ceiling systems, designed with anti-fungal, water-repellent, and scratch-resistant properties. These FRP solutions comply with food safety and HACCP standards, making them easy to clean and ideal for facilities aiming to achieve the highest hygiene standards.





THE IMPORTANCE OF HYGIENE

Harmful bacteria such as Listeria and Salmonella hide in voids, cracks, open joints, behind kerbs, and on corroded surfaces.

*Daily cleaning can flush these bacteria from cracks and crevices, dispersing them throughout the production area. This can lead to serious **bacterial contamination** on food production surfaces, potentially resulting in foodborne illnesses, production halts, or even complete factory shutdowns.*



A TOTAL HYGIENIC DESIGN SOLUTION

For the food and beverage industry, life sciences, and health sector



PolySto provides maximum protection for hygienic areas, from floor to ceiling!

The aim of the PolySto hygienic design concept is to enable easy cleaning and fast evacuation of humidity and biomass, preventing the growth of harmful bacteria



Humidity



Biomass

PolySto Group developed an extensive range of hygienic construction products consisting of:

- Prefabricated hygienic CleanSheet walls and ceilings
- Prefabricated hygienic CleanRock kerbs
- HygiSeal®
- Prefabricated Food Safe PVC covered skirtings
- Modular polyethylene wall ledges
- Stainless steel posts and barriers
- Stainless steel column protection
- Stainless steel drainage
- Hygienic windows and doors
- Hygienic (LED) lightings
- Hygienic wall boots

WE HAVE MORE TO OFFER

CONSULTANCY

Each project is unique. Our team of experts, active in over 100 countries worldwide can advise on how to build your project to comply with the highest level of hygienic standards.

PolySto is expert member of EHEDG, Co-author of EHEDG hygienic building guidelines, doc 44.



PROJECT CALCULATION



Project calculation from A-Z

An experienced and motivated Internal Sales team provides your tailor-made quotations.

A personal approach is key. Together with your sales representative, the internal sales team is responsible to calculate your project with the necessary technical support.

In order to prepare a swift and detailed calculation, we always ask to provide a digital CAD drawing.

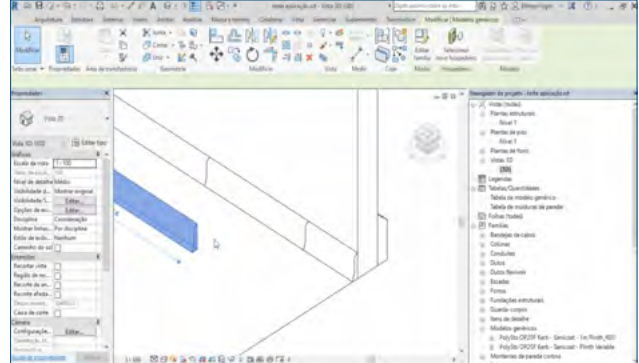

Building information modeling (BIM)

You can consult our **extensive BIM-library** in the document catalog on our [website](#).

The PolySto BIM models can be extracted, exchanged or networked to support decision-making regarding your new or renovation built assets.

Apart from detailed technical drawings, the BIM library contains a full technical description of all CleanRock kerbs which can be useful for tender and project specifications.

MASTER INSTALLERS

The approach towards new construction or renovation of your food safe areas require specialized expertise. PolySto Group looks back on **30 years of experience** in hygienic construction.

In BeNeLux we have our own **certified installation teams** who take on the daily challenges to complete hygienic renovations or new construction projects.

Through insight into the **construction details**, technical expertise and attention to safety, reliability and flexibility, we are able to offer suitable and responsible solutions for the food-safe finish of all areas where hygienic and **HACCP finish** are required, taking into account the construction costs, quality, predetermined planning and safety.



PolySto Group BV cooperates with dedicated partners and installation companies throughout the world.

To achieve the label **'master installer'** we offer specific training sessions in our academy.

Interested in becoming a Master Installer?

Contact us!

- Trained Master Installers worldwide
- Experts in PolySto hygienic construction
- Masters of installation
- Perfectionists into finest details
- PolySto **ambassadors**
- Bring **total** hygienic solutions
- Share knowledge in the **PolySto community**

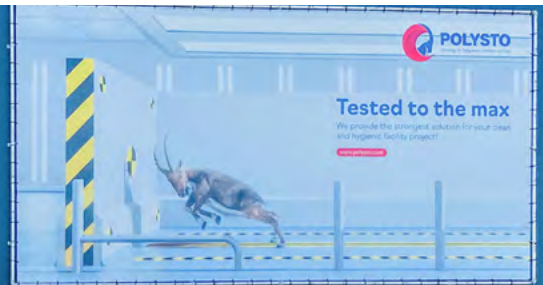

CLEANSHEET TECHNOLOGY

CLASSIC BUILDING MATERIALS

What are the problems with classic wall and ceiling building materials?



Sandwich panels



Concrete



Brick walls



Stainless steel panels



Ceramic tiles

Degradation and corrosion of wall & ceiling panels due to:



Cleaning agents - unsuitable or inappropriate use:

- Temperature
- Concentration
- Mix of detergents
- Cleaning equipment: e.g. brushes
high pressure devices



Mechanical impact

- Poor or lack of good wall protection
- Scratches and point impacts
- Normal wear and tear



Humidity

- Humid production processes
- Temperature fluctuations
- Poor or insufficient ventilation



Natural products (agressive)

- Blood
- Starch
- Salts
- ...

Resulting in:



- High risk of bacterial contamination
- Development of moulds and fungus
- Possible production interruptions or stops

WHY CLEANSHEET?

Introducing PolySto **CleanSheet** — the future of hygienic construction materials. Made from Fiberglass Reinforced Polyester (FRP), CleanSheet embodies both **strength** and **durability**. It stands apart with its resistance to rust, decay, and its minimal maintenance needs, making it a superior alternative to traditional building materials.

Suitable for various applications, including walls, ceilings, and cladding. CleanSheet is a sound choice for those seeking an efficient and long-lasting construction solution.



Smooth (+film),
Smooth matt (+film)
Smooth glossy (+ film)
Smooth + SR film

Embossed
Embossed + SR film

Non-corrosive / chemical resistant

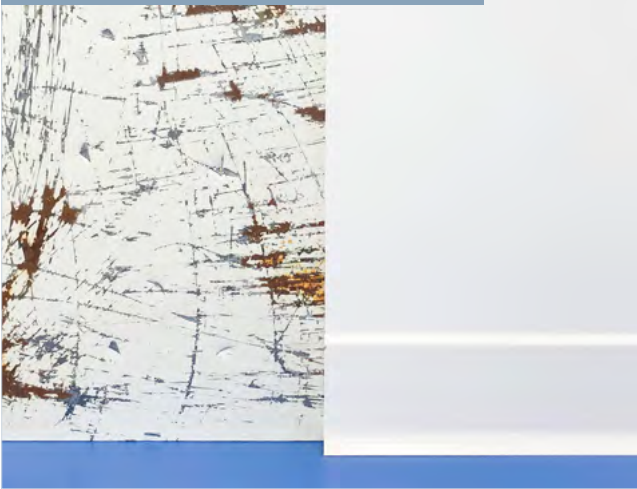

Easy to clean



Very quick and easy installation



Extreme low bacterial adhesion

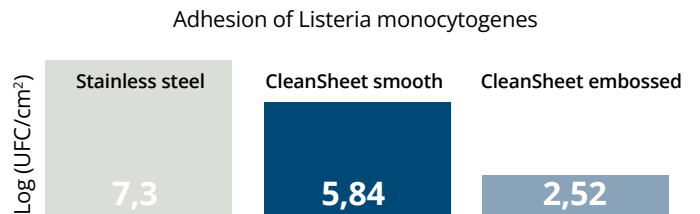

CLEANSHEET

Finishing options

EMBOSSED

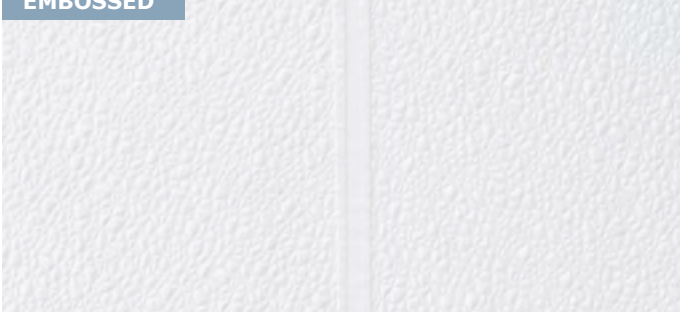

- Lowest bacterial adhesion
- Ideal for daily industrial foam cleaning
- 30% less foam consumption
- Diffused light reflection for relaxed atmosphere

SMOOTH



- Perfect for dry environments
- Sleek and polished appearance

SMOOTH MAT



- Low reflection
- Matt look
- Pharma and Cleanroom

SMOOTH GLOSSY



- Extra smooth
- Pharma and Cleanroom

Application

Directly adhered to all **flat and smooth** surfaces, such as:

- Sandwichpanels
- Concrete/cement walls
- Ceramic tiles
- Plaster, gypsum board, cement board
- OSB-panel

Euro Class

CleanSheets are available in **2 fire classes**

- Euro Class E
- Euro Class B-S2,D0



CLEANSHEET page 18

Fiber glass reinforced composite polyester sheet for the hygienic and durable protection of walls and ceilings.

- Installation on smooth, straight surfaces - f.e. concrete, tiles, sandwich panels, etc...
- For renovation and new build projects



RAMPANEL page 20

Cement-based support laminated with CleanSheet. High-impact solution ideal for refurbishing walls in disrepair or for rooms demanding superior fire resistance and thermal stability.

- Installation on uneven surfaces which demand high strength. F.e. concrete, tiles, sandwich panels, metal studs, etc...
- Impact and scratch proof
- For renovation and new build projects



HYGIWALL page 22

Premium sandwich construction panel solution with a PIR or mineral wool core, tailored for optimal insulation. Each panel is seamlessly laminated on one or both sides with our durable PolySto CleanSheet.

- For renovation and new build constructions
- Ideal for box-in-box projects
- For inner, non-supporting walls and self-supported ceilings
- HygiWall panels produced up to 11 meters length



INSUPANEL page 26

A laminated insulation panel, with PolySto CleanSheet, designed for walls and ceilings that demand extra insulation.

- For renovation and new build
- Lightweight suitable for ceiling renovations
- When extra insulation is needed



RENOPANEL page 28

An advanced, lightweight panel constructed from robust polypropylene with high-grade PolySto CleanSheet lamination.

- For renovation and new build
- Lightweight suitable for ceiling renovations



HYGICEILING page 30

Hygienic and washable CleanSheet ceiling tiles, designed for suspended ceilings, offering an easily maintainable solution for diverse environments.

- For renovation and new build
- Washable in industrial dishwasher



CLEANROCK TECHNOLOGY

What are the problems with classic wall protection building materials?



Concrete kerbs with resin-epoxy coating:

- Very long installation times
- Aggressive water/concrete mixture causes corrosion to sandwich panels
- Physical impacts causes cracks
- Difficult and expensive to maintain
- Water and biomass infiltration cause growth of harmful bacteria



Resin and tile covered skirtings:

- Expensive and brittle
- Not a wall protection
- Due to temperature changes, impact ruptures the skirting
- Infiltrated water in the floor evaporates and causes the resin floor to break



Stainless steel shells filled on site with concrete:

- Very complex installation with skilled labor and specialized tools.
- Voids behind stainless steel surface can harbor bacteria
- Difficult to repair or maintain
- Cold bridge effect
- Corrosion and scratch sensitive



Hollow, flexible PVC covered skirtings:

- Very brittle
- Hollow spaces behind the surface which is ideal for bacteria growth
- Weak and chemically not stable
- Flexible rubber joints are not watertight and chemical resistant

Resulting in:

- High risk of bacterial contamination
- Possible production interruptions or stops
- High installation and maintenance costs

CleanRock

CleanRock is the **patented core material** used in PolySto kerbs. The composition has been developed based on more than 30 years of experience in the food processing industry.

Prefabricated CleanRock kerbs are composed of a mixture of polyester resins, quartz granulates and additives. The **unique composition** allows to prevent contaminations with Salmonella and Listeria. CleanRock is ideal for **food safe environments** that have to comply with HACCP, EU, USDA, GFSI, BRC and other food safety standards.



5 x stronger than concrete

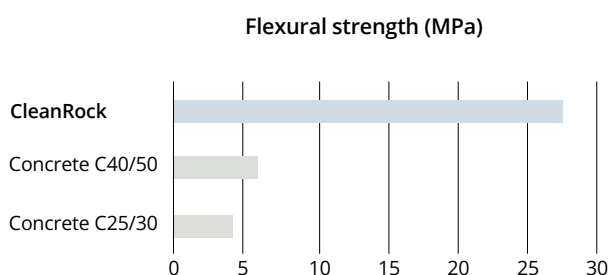

No water absorption!

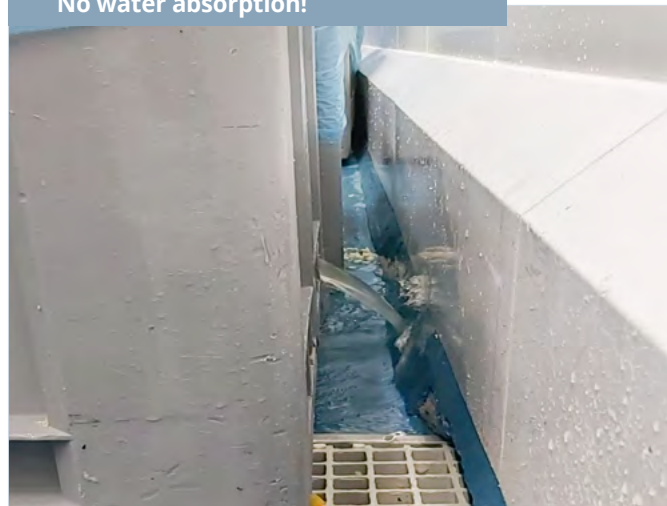

Double water barrier

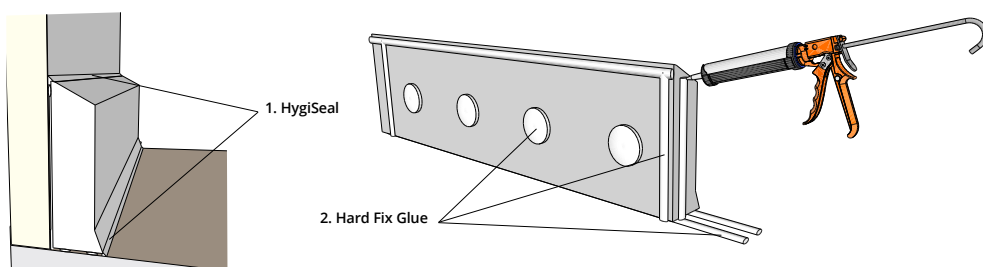

Prefabricated & modular system

- ✓ Installed before or after floor installation
- ✓ Fast installation
- ✓ Easy replacement

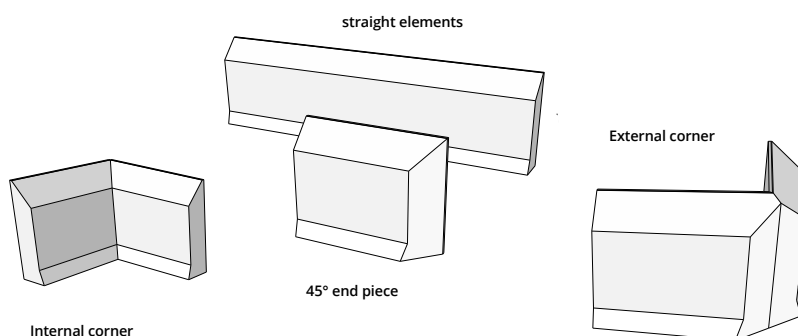

HYGISEAL

What are the problems with classic sealants in the food Industry?



Silicone joints

- Poor resistance to high pressure cleaning
- Anti-fungal agents are rinsed out by cleaning
- (Black) mould on silicone joints
- High maintenance cost
- Higher risk for production interruption due to maintenance
- High risk of bacteria outbreak

WHY HYGISEAL?

HygiSeal 3.1 is our latest innovation in the field of chemical welding, specifically designed for joints using a single-component hybrid sealant. HygiSeal joints create a **seamless**, enduring, and **fungus-repellent** connection between PolySto components, as well as between floors and walls. Engineered to withstand the challenges of **high-pressure cleaning**, these joints retain their **durability** even when exposed to the most demanding cleaning processes.

The unique composition of HygiSeal 3.1 provides a hard and smooth surface, which significantly **reduces bacterial adhesion** compared to traditional food-safe silicones. HygiSeal is the perfect solution for industries that demand strict hygiene standards.

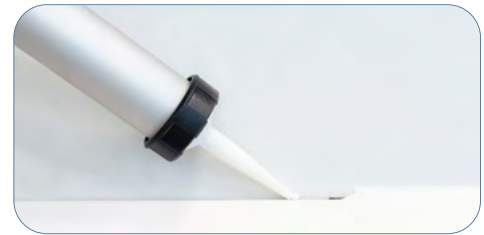

The total hygienic design solution for sealing of:

- Kerbs and skirtings
- Windows
- Doors
- Sandwich panels
- Walls
- Ceilings
-

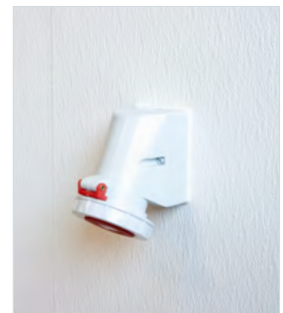
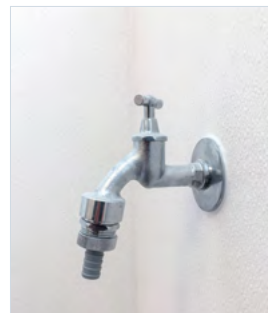

Available in



PROJECTS

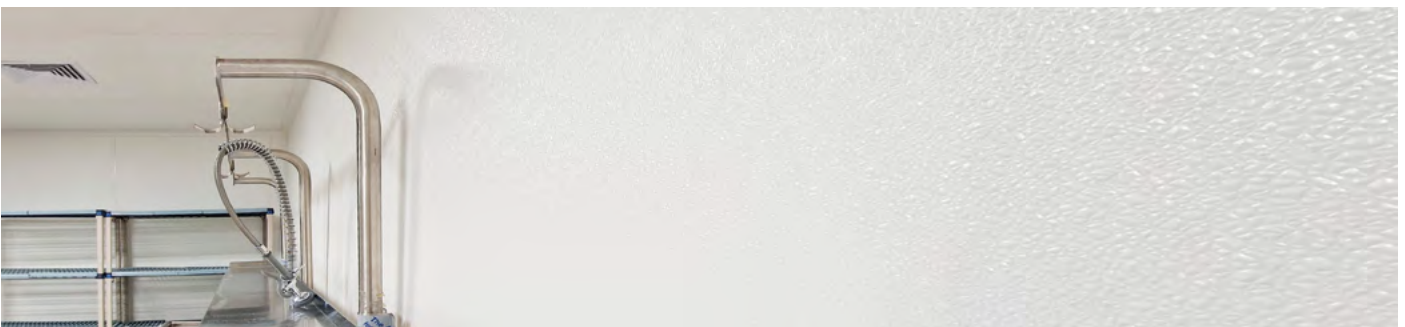
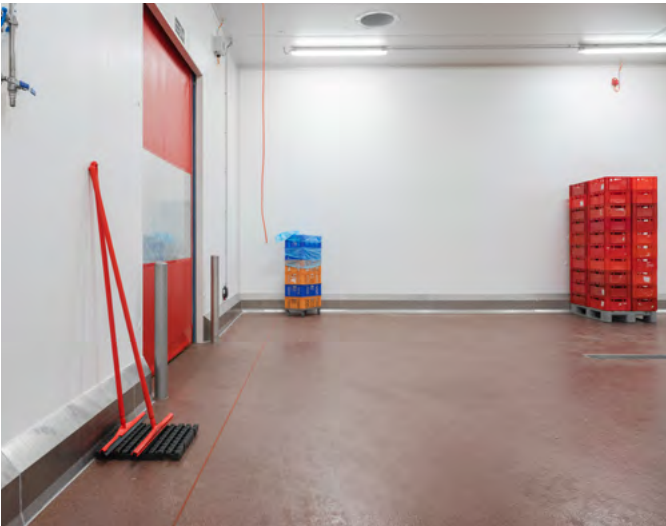
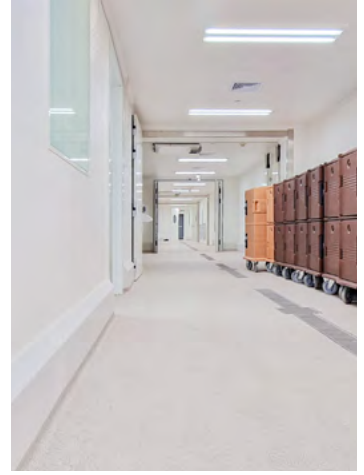
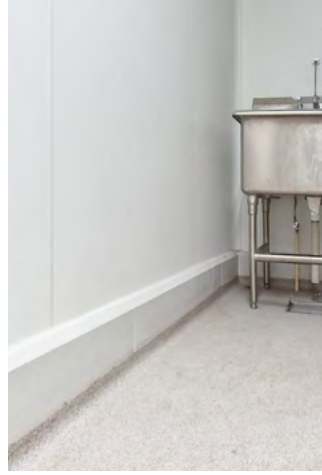

PROJECTS



PROJECTS



CLEANSHEET

Fiber glass reinforced composite polyester sheet for the hygienic and durable protection of walls and ceilings.
The PolySto **CleanSheet** is available with an embossed, smooth, smooth matt and smooth glossy (+film) finishing.

The PolySto CleanSheet is the face material for the products RamPanel, HygiWall, InsuPanel, RenoPanel and HygiCeiling.

Euro Class E	Euro Class B-S2,d0	Description	Sheet size (m)	# per pallet
F2,3E_2	-	CleanSheet embossed 2,3 mm	1,2 x 2 (2,4 m2)	100 pc
F2,3E_2,5	FFRB2,3E_2,5	CleanSheet embossed 2,3 mm	1,2 x 2,5 (3 m2)	100 pc
F2,3E_2,75	-	CleanSheet embossed 2,3 mm	1,2 x 2,75 (3,3 m2)	100 pc
F2,3E_3	FFRB2,3E_3	CleanSheet embossed 2,3 mm	1,2 x 3 (3,6 m2)	100 pc
F2,3E_3,5	-	CleanSheet embossed 2,3 mm	1,2 x 3,5 (4,2 m2)	50 pc
F2,3E_4	-	CleanSheet embossed 2,3 mm	1,2 x 4 (4,8 m2)	25 pc
F2,3E_M2	-	CleanSheet embossed 2,3 mm - custom made	1,2 x ...	-
F2,3E_200	FFRB2,3E_200	CleanSheet embossed 2,3 mm on coil	1,2 x 200 (240 m2)	1 pc
F2S_2,5	FFRB2S_2,5	CleanSheet smooth 2 mm + film	1,2 x 2,5 (3 m2)	100 pc
F2S_3	FFRB2S_3	CleanSheet smooth 2 mm + film	1,2 x 3 (3,6 m2)	100 pc
F2S_3,5	-	CleanSheet smooth 2 mm + film	1,2 x 3,5 (4,2 m2)	50 pc
F2S_4	-	CleanSheet smooth 2 mm + film	1,2 x 4 (4,8 m2)	25 pc
F2S_M2	-	CleanSheet smooth 2 mm + film - custom made	1,2 x ...	-
F2S_250	-	CleanSheet smooth 2 mm + film on coil	1,2 x 250 (300 m2)	1 pc
F2SG_3	-	CleanSheet smooth glossy 2 mm + film	1,2 x 3 (3,6 m2)	100 pc
F2SM_2,6	-	CleanSheet smooth matt 2 mm + film	1,2 x 2,6 (3,12 m2)	100 pc
F2SM_3	FFRB2SM_3	CleanSheet smooth matt 2 mm + film	1,2 x 3 (3,6 m2)	100 pc
F2,3E_3_RAL9006	-	CleanSheet embossed 2,3 mm RAL 9006	1,2 x 3 (3,6 m2)	100 pc
F3E_2,5	-	CleanSheet embossed 3 mm	1,2 x 2,5 (3 m2)	100 pc
F3E_3	-	CleanSheet embossed 3 mm	1,2 x 3 (3,6 m2)	50 pc
F3S_3	-	CleanSheet smooth 3 mm + film	1,2 x 3 (3,6 m2)	50 pc
F2,3ESR_3	-	CleanSheet Smoke Room embossed 2,3 mm + SR film	1,2 x 3 (3,6 m2)	100 pc
F2,3ESR_M2	-	CleanSheet Smoke Room embossed 2,3 mm + SR film - custom	1,2 x ...	-
F2SSR_M2	-	CleanSheet Smoke Room smooth 2 mm + SR film - custom	1,2 x ...	-

- indicates not available in Euro Class B-S2,d0

	Embossed - 2,3 mm	Smooth, matt or glossy - 2 mm
Weight/m ²	+ - 3 kg/m ²	+ - 3.2 kg/m ²
Colour	standard RAL 9016 (hygienic white)	
Temperature range	-60 °C / +60 °C	
Tolerance length/width	0.2 x 0.5 %	
HS-Code	39 21 90 10	

Profiles for finishing CleanSheets

Page 32

Other thicknesses and lengths available on demand.
All other RAL colours available on demand (min. 500 m² / colour).



CleanSheet with very strong HygiSeal 3.1 joint.



CleanSheet finished with PVC profiles.



CleanSheet 2,3 mm embossed.



CLEANSHEET

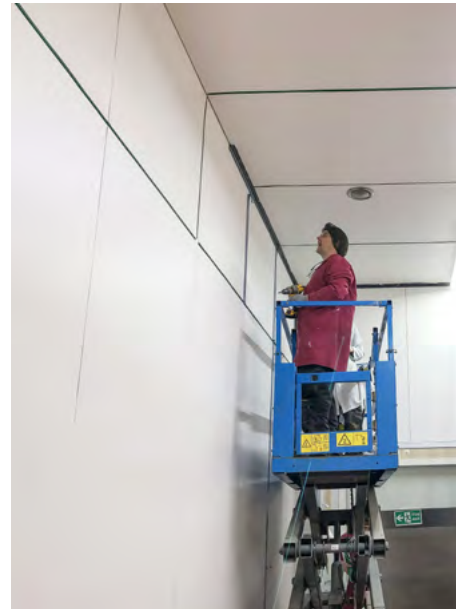



RAMANEL

RamPanel, cement-based support laminated with CleanSheet, is a high-impact solution ideal for refurbishing walls or for rooms demanding superior fire resistance and thermal stability. The PolySto RamPanel can serve as a robust firewall. The cement-based support holds Euro Class A2-S1,d0 certification.

Euro Class E	Euro Class B-S2,d0	Description	Sheet size (m)	# per pallet
F1,5E_RC6_2,6F	FFRB1,5E_RC6_2,6F	RamPanel CleanSheet embossed 1,5 mm + 6 mm cement panel	1,2 x 2,6 (3,12 m ²)	35 pc
F1,5E_RC6_3F	FFRB1,5E_RC6_3F	RamPanel CleanSheet embossed 1,5 mm + 6 mm cement panel	1,2 x 3 (3,6 m ²)	35 pc
F1,5S_RC6_2,6F	FFRB1,5S_RC6_2,6F	RamPanel CleanSheet smooth 1,5 mm + 6 mm cement panel	1,2 x 2,6 (3,12 m ²)	35 pc
F1,5S_RC6_3F	FFRB1,5S_RC6_3F	RamPanel CleanSheet smooth 1,5 mm + 6 mm cement panel	1,2 x 3 (3,6 m ²)	35 pc

	Embossed - 1,5 mm	Smooth (1,5 mm), matt (2mm) or glossy (2 mm)
Weight/m²	+ - 10,8 kg/m ²	+ - 11 kg/m ²
Colour	standard RAL 9016 (hygienic white)	
Temperature range	-60°C / +60°C	
Panel material	Fibre cement (A2,s1-d0)	
Tolerance lenght/width	0.2 x 0.5 %	
HS-Code	39 21 90 10	

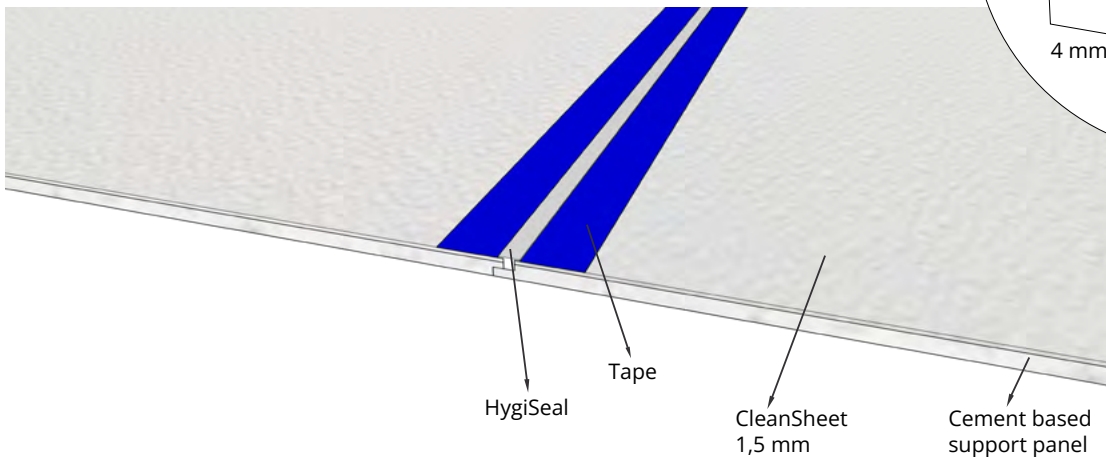
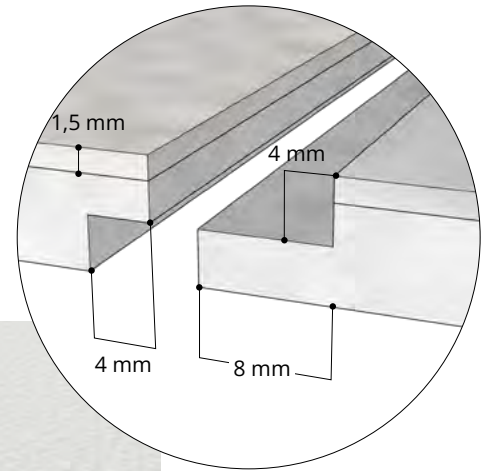

Profiles for finishing RamPanel

Page 33

Other lengths available on demand up to 3,75 meter.
All other RAL colours available on demand (min. 500 m² / colour).



RamPanel prepared with blue tape for HygiSeal 3.1 installation.



RamPanel in a bakery.



RamPanel can be installed on metal studs.



RAMPANEL



BEFORE

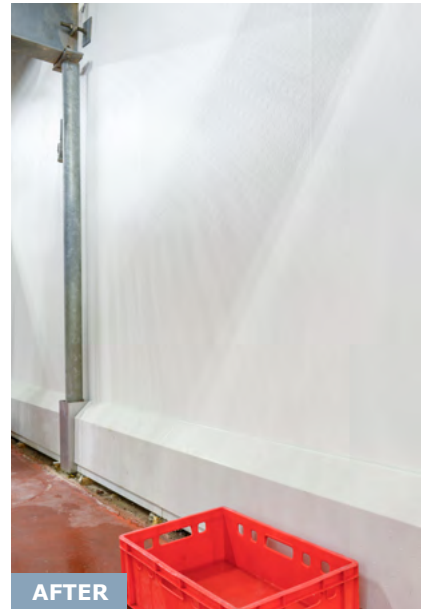

AFTER





HYGIWALL

HygiWall is a premium sandwich panel solution with a choice of PIR or mineral wool core, tailored for optimal insulation. Each panel is seamlessly laminated on one or both sides with our durable PolySto CleanSheet, perfect for creating hygienic walls, ceilings, and modular box-in-box constructions.

1-sided laminated			
Euro Class E	Euro Class B-S2,d0	Description	# per pallet
HW60JI_1,5E	HW60JI_FFRB1,5E	HygiWall 60 mm steel sandwich panel 1-sided CleanSheet 1,5 mm embossed	+/- 16 pc
HW80JI_1,5E	HW80JI_FFRB1,5E	HygiWall 80 mm steel sandwich panel 1-sided CleanSheet 1,5 mm embossed	+/- 12 pc
HW100JI_1,5E	HW100JI_FFRB1,5E	HygiWall 100 mm steel sandwich panel 1-sided CleanSheet 1,5 mm embossed	+/- 10 pc
HW60JI_1,5S	HW60JI_FFRB1,5S	HygiWall 60 mm steel sandwich panel 1-sided CleanSheet 1,5 mm smooth	+/- 16 pc
HW80JI_1,5S	HW80JI_FFRB1,5S	HygiWall 80 mm steel sandwich panel 1-sided CleanSheet 1,5 mm smooth	+/- 12 pc
HW100JI_1,5S	HW100JI_FFRB1,5S	HygiWall 100 mm steel sandwich panel 1-sided CleanSheet 1,5 mm smooth	+/- 10 pc

2-sided laminated			
Euro Class E	Euro Class B-S2,d0	Description	# per pallet
HW60JI_1,5E_1,5E	HW60JI_FFRB1,5E_1,5E	HygiWall 60 mm steel sandwich panel 2-sided CleanSheet 1,5 mm embossed	+/- 16 pc
HW80JI_1,5E_1,5E	HW80JI_FFRB1,5E_1,5E	HygiWall 80 mm steel sandwich panel 2-sided CleanSheet 1,5 mm embossed	+/- 12 pc
HW100JI_1,5E_1,5E	HW100JI_FFRB1,5E_1,5E	HygiWall 100 mm steel sandwich panel 2-sided CleanSheet 1,5 mm embossed	+/- 10 pc
HW60JI_1,5S_1,5S	HW60JI_FFRB1,5S_1,5S	HygiWall 60 mm steel sandwich panel 2-sided CleanSheet 1,5 mm smooth	+/- 16 pc
HW80JI_1,5S_1,5S	HW80JI_FFRB1,5S_1,5S	HygiWall 80 mm steel sandwich panel 2-sided CleanSheet 1,5 mm smooth	+/- 12 pc
HW100JI_1,5S_1,5S	HW100JI_FFRB1,5S_1,5S	HygiWall 100 mm steel sandwich panel 2-sided CleanSheet 1,5 mm smooth	+/- 10 pc

HygiWall, 2-sided laminated, with CleanSheet embossed on the A-side and CleanSheet smooth on the B-side, is available upon request.

	Embossed - 1,5 mm	Smooth (1,5 mm), matt (2mm) or glossy (2 mm)
Colour	standard RAL 9016 (hygienic white)	
Temperature range	-60°C / +60°C	
Panel material	Sandwich panel with PIR core Euroclass B-s1,d0 or FM approved Sandwich panel with mineral wool core Euroclass A2-s1d0	
HS-Code	39 21 90 10	

Other lengths available on demand. 2 sided CleanSheet is optional. All other RAL colours available on demand (min. 500 m² / colour).

Consumption HygiSeal joints (+/- 80 cc/m)

width joint + 2 mm x height joint + 2 mm = consumption / meter



HygiWall as partition wall.



HygiWall in a poultry slaughterhouse



HygiWall in a ready meal facility.



HYGIWALL AS A WALL PANEL

HygiWall, laminated 1 or 2-sided with CleanSheet for separation wall or box-in-box.

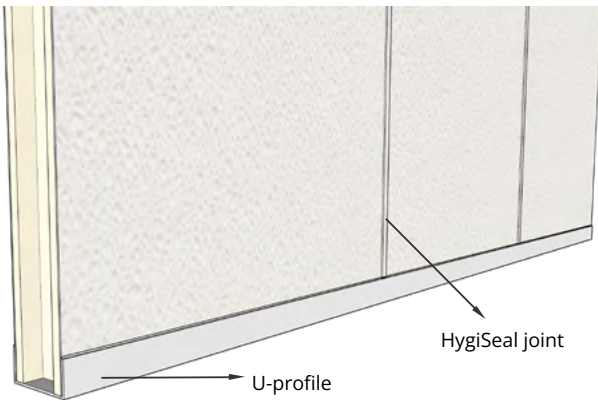

HYGIWALL AS A CEILING PANEL

HygiWall, laminated 1 sided with CleanSheet for ceiling applications.

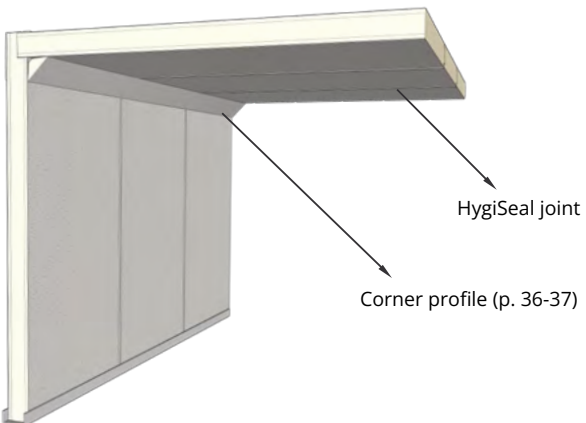

Brewery laboratory build with **HygiWall**.



HygiWall in a ready meal facility.



HygiWall ceiling suspension (Aluminium T-profile).

HYGIWALL

Fast and **easy** construction with PolySto HygiWall, providing durable, hygienic wall solutions ideal for food processing and healthcare facilities. Box-in-box designs for renovation or new construction.



Full core **inner corner profiles**.

More info page 34-37



Threaded rod ceiling suspension **'Mushroom'**, designed for secure and adjustable support of fixtures.



One-sided HygiWall with PIR or mineral wool core. Available in smooth or embossed finishing (laminated CleanSheet).

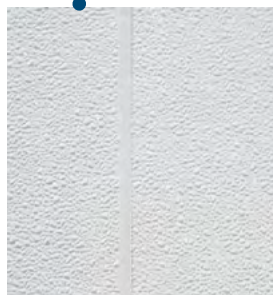
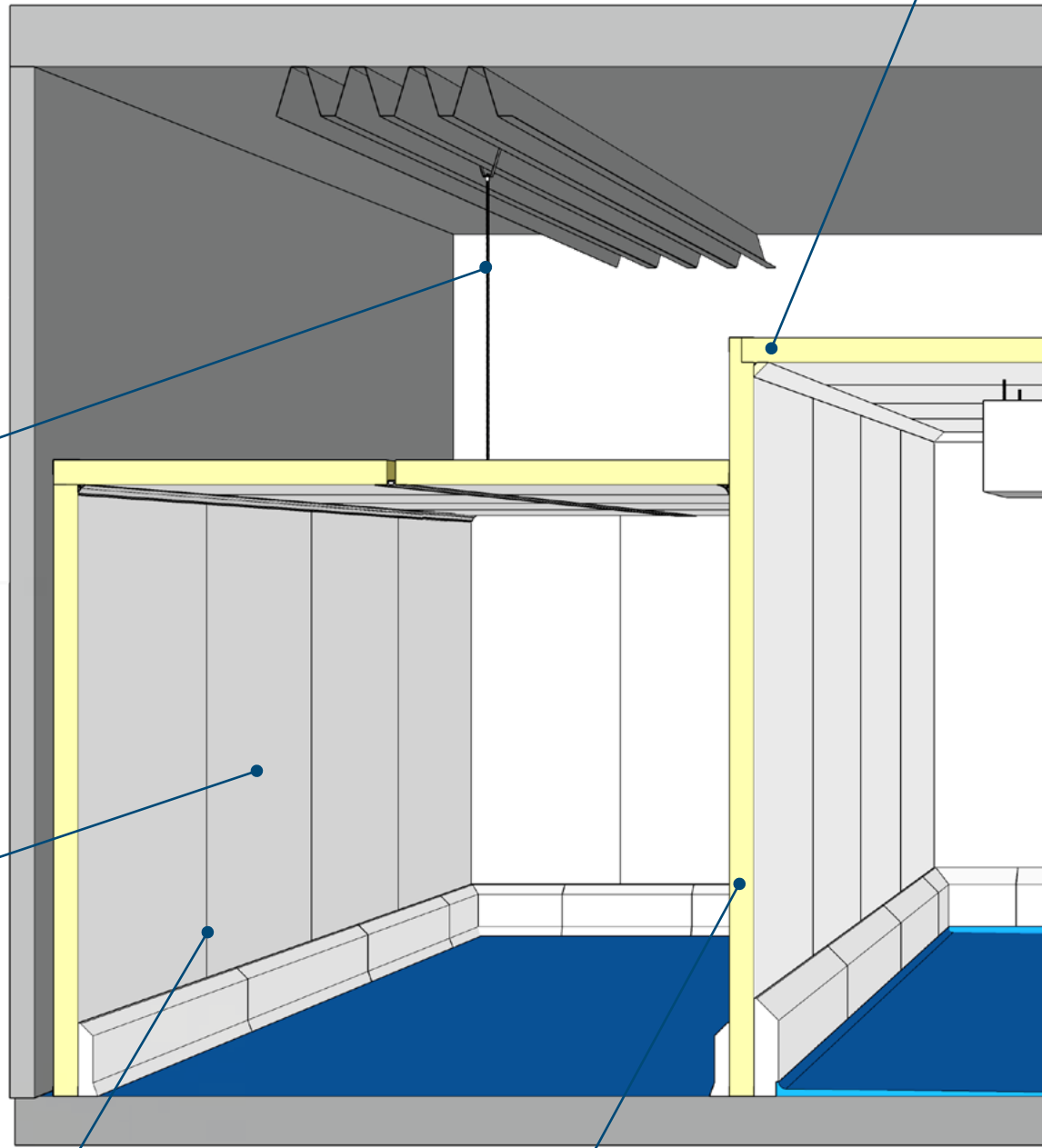

HygiSeal, a versatile, non-porous chemical weld sealant that provides resistance to high-pressure cleaning and chemicals.

More info page 14



Double-sided HygiWall, ideal where durable, easily cleanable, and hygienic wall solutions are needed on both sides.

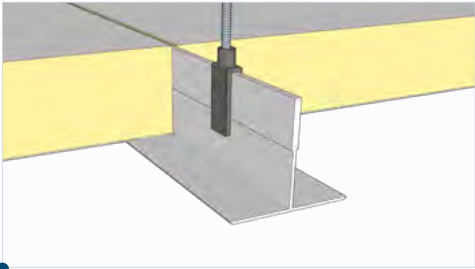

Threaded rod ceiling suspension 'T-profile'.

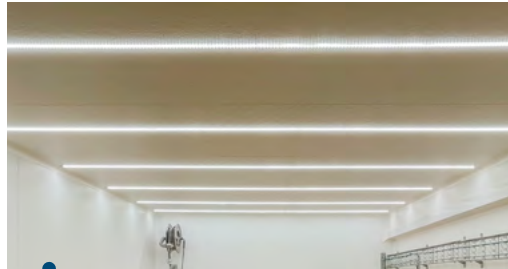

Hygienic LED strips
bright, energy-efficient
lighting, easy to clean
and maintain

More info page 59

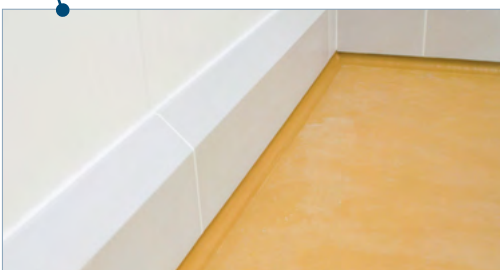
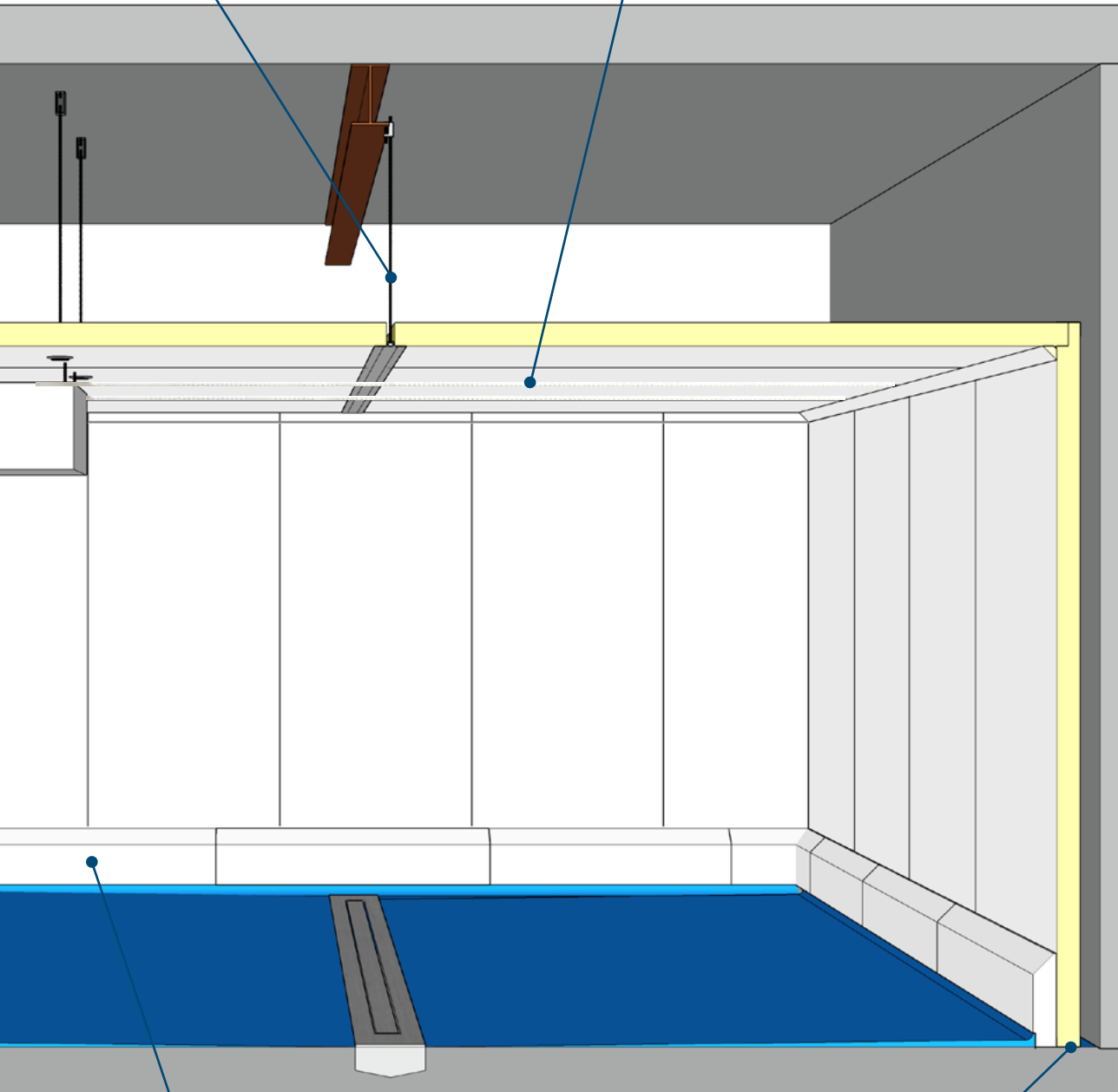

PolySto CleanRock kerbs
high-quality, ideal for food
industry environments due to
their high impact resistance
and easy-to-clean surfaces.

More info page 13



PVC or stainless steel **U-profile**

INSUPANEL

InsuPanel is a laminated insulation panel, with PolySto CleanSheet, designed for walls and ceilings, is an excellent choice for both renovation projects and new constructions that demand extra insulation. Its lightweight nature makes it especially suitable for ceiling refurbishments. InsuPanel is available with embossed, smooth, matt or glossy finish.

1-sided CleanSheet for ceiling application

Euro Class E	Euro Class B-S2,d0	Description	Sheet size (m)	# per pallet
1,5E_PIR3_3	FFRB1,5E_PIR3_3	CleanSheet embossed 1,5 mm + 30 mm PIR + Aluclad	1,2 x 3 (3,6 m2)	+ 32 pc
1,5E_PIR4_3	FFRB1,5E_PIR4_3	CleanSheet embossed 1,5 mm + 40 mm PIR + Aluclad	1,2 x 3 (3,6 m2)	+ 24 pc
1,5E_PIR6_3	FFRB1,5E_PIR6_3	CleanSheet embossed 1,5 mm + 60 mm PIR + Aluclad	1,2 x 3 (3,6 m2)	+ 16 pc

2-sided CleanSheet for wall structures

Euro Class E	Euro Class B-S2,d0	Description
2,3E_PIR8_2,3E_M2	FFRB2,3E_PIR8_FFRB2,3E_M2	CleanSheet embossed 2,3 mm + 80 mm PIR + CleanSheet embossed 2,3 mm
2,3E_PIR10_2,3E_M2	FFRB2,3E_PIR10_FFRB2,3E_M2	CleanSheet embossed 2,3 mm + 100 mm PIR + CleanSheet embossed 2,3 mm

	Embossed - 1,5 mm
Colour	standard RAL 9016 (hygienic white)
Temperature range	-60°C / +60°C
Panel material	PIR insulation board - C-s2,d0
Tolerance length/width	0,2 x 0,5 %
HS-Code	39 21 90 10

Other thicknesses available on demand (30-100mm). Custom length up to 5 meter. All other RAL colours available on demand (min. 500 m² / colour).

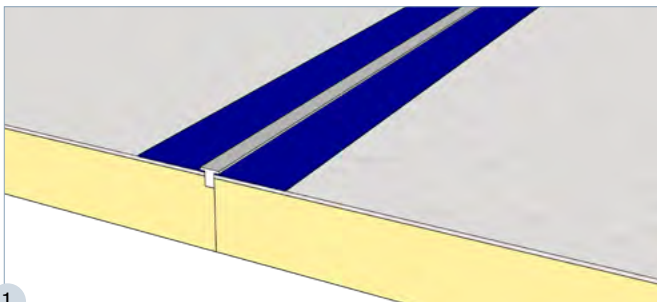

1 InsuPanel with HygiSeal joint.

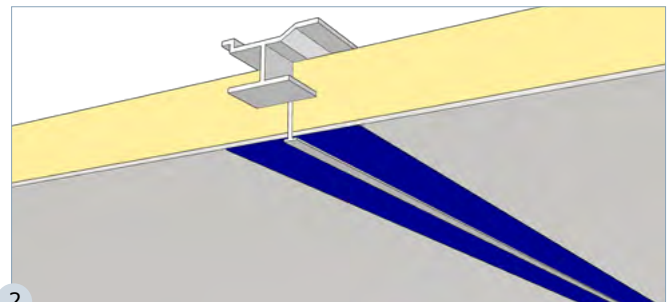

2 InsuPanel with H-profile, finished with HygiSeal joint

Profiles for finishing InsuPanel

Page 34



FRP **InsuPanel** as panel and ceiling in a cold store.



INSUPANEL



RENOPANEL

The PolySto **RenoPanel** is an advanced, lightweight panel constructed from robust polypropylene (honeycomb structure) with high-grade PolySto CleanSheet lamination. The RenoPanel is a hygienic, easy-to-install solution to renovate your ceiling. Connection between panels with HygiSeal or omega-profiles

Euro Class E	Description	Sheet size (m)	# per pallet
F1,5E_PP10_2,6	RenoPanel CleanSheet embossed 1,5 mm + 10 mm polypropylene	1,2 x 2,6 (3,12 m ²)	50 pc
F1,5E_PP10_3	RenoPanel CleanSheet embossed 1,5 mm + 10 mm polypropylene	1,2 x 3 (3,6 m ²)	50 pc
F1,5S_PP10_2,6	RenoPanel CleanSheet smooth 1,5 mm + film + 10 mm polypropylene	1,2 x 2,6 (3,12 m ²)	50 pc
F1,5S_PP10_3	RenoPanel CleanSheet smooth 1,5 mm + film + 10 mm polypropylene	1,2 x 3 (3,6 m ²)	50 pc

	Embossed - 1,5 mm	Smooth (1,5 mm), matt (2mm) or glossy (2 mm)
Weight/m²	+ - 3,25 kg/m ²	+ - 3,50 kg/m ²
Colour	standard RAL 9016 (hygienic white)	
Temperature range	0 °C / +60 °C	
Panel material	Polypropylene	
Tolerance length/width	0,4 x 0,15 %	
HS-Code	39 21 90 10	

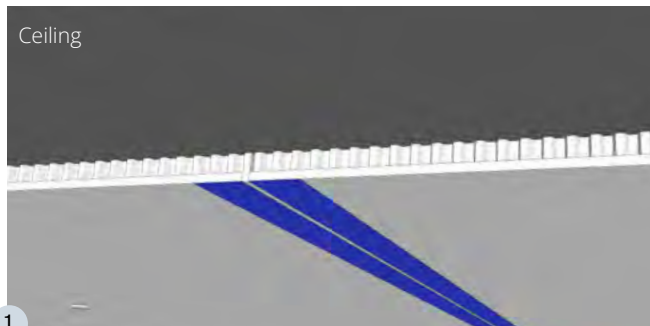

1 RenoPanel with HygiSeal joint.

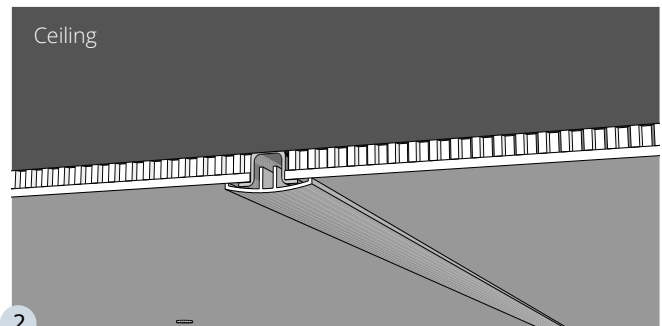

2 RenoPanel with omega profile.

Profiles for finishing RenoPanel

Page 33

Other lengths available on demand up to 5 meter.
All other RAL colours available on demand (min. 500 m² / colour).



RenoPanel as hygienic ceiling in a potato processing facility.



RenoPanel as hygienic ceiling in a meat processing facility.



RENOPANEL

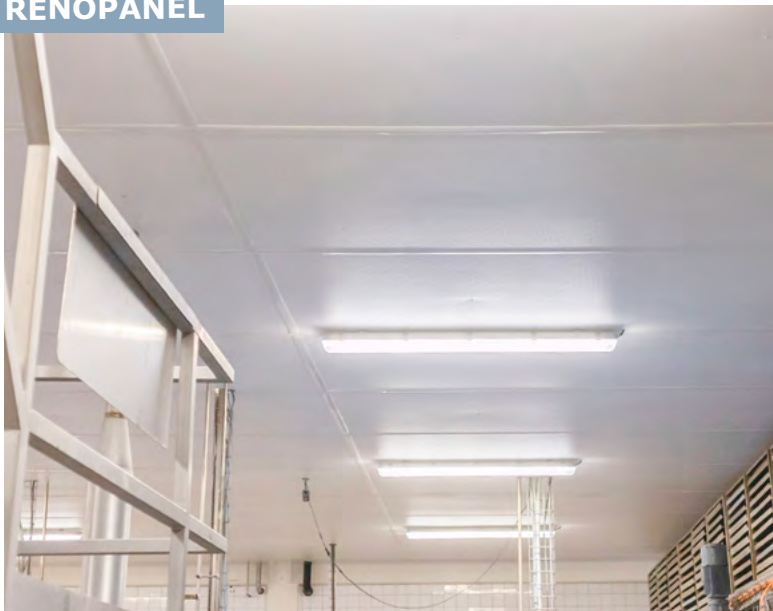

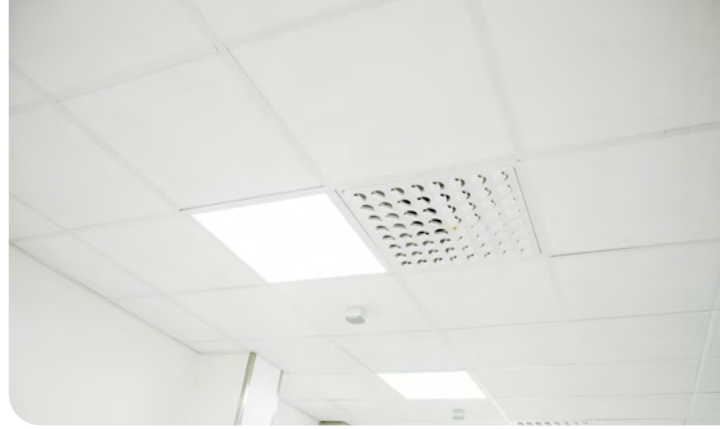

HYGICEILING

Hygienic and washable CleanSheet ceiling tiles, designed for suspended ceilings, offering an easily maintainable solution for diverse environments.

Euro Class E

	Description	Sheet size (mm)	# per pallet
F3E_0,6	HygiCeiling CleanSheet embossed 3 mm, Euro Class E	595 x 595 (0,354 m ²)	+ - 400 pc
F3E_1,2	HygiCeiling CleanSheet embossed 3 mm, Euro Class E	1195 x 595 (0,711 m ²)	+ - 200 pc
F3S_0,6	HygiCeiling CleanSheet smooth 3 mm, Euro Class E	595 x 595 (0,354 m ²)	+ - 400 pc
F3S_1,2	HygiCeiling CleanSheet smooth 3 mm, Euro Class E	1195 x 595 (0,711 m ²)	+ - 200 pc

Euro Class B-S2,d0

Other RAL colours available on demand (min. 500 m²/colour).

	Description	Sheet size (mm)	# per pallet
FFRB2,3EC_0,6	HygiCeiling, Fire retardant Euro Class B-S2,d0 CleanSheet embossed 2,3 mm	595 x 595 (0,354 m ²)	+ - 400 pc
FFRB2,3EC_1,2	HygiCeiling, Fire retardant Euro Class B-S2,d0 CleanSheet embossed 2,3 mm	1195 x 595 (0,711 m ²)	+ - 200 pc
FFRB2,3SC_0,6	HygiCeiling, Fire retardant Euro Class B-S2,d0 CleanSheet smooth 2,3 mm	595 x 595 (0,354 m ²)	+ - 400 pc
FFRB2,3SC_1,2	HygiCeiling, Fire retardant Euro Class B-S2,d0 CleanSheet smooth 2,3 mm	1195 x 595 (0,711 m ²)	+ - 200 pc

HYGICEILING STRUCTURES (ANTI-CORROSION)

	Description	# per box
CMC_LP_3,05	CMC T24 L edge profile, white, anti-corrosion, 3050 x 24 mm	40 pc
CMC_MP_3,6	CMC T24 main runner profile, white, anti-corrosion, 3600 x 24 mm	25 pc
CMC_CP_1,2	CMC T24 cross profile, white, anti-corrosion, 1200 x 24 mm	50 pc
CMC_CP_0,6	CMC T24 cross profile, white, anti-corrosion, 600 x 24 mm	75 pc
CMC_H_100/190	CMC T24 hanger 100 - 190 mm	100 pc
CMC_H_200/390	CMC T24 hanger 200 - 390 mm	100 pc
CMC_H_300/590	CMC T24 hanger 300 - 590 mm	100 pc
CMC_H_500/990	CMC T24 hanger 500 - 990 mm	100 pc
CMC_H_1000/1290	CMC T24 hanger 1.000 - 1.290 mm	50 pc
CMC_H_1200/1490	CMC T24 hanger 1.200 - 1.490 mm	50 pc
CMC_HDC1_100	CMC T24 ceiling clips HDC1	100 pc

Ceiling structures for the HygiCeiling tiles are available in full packages only. Standard colour: White RAL 9016.



HygiCeiling 595x595mm tiles in a hospital area.



Installation of HygiCeiling.

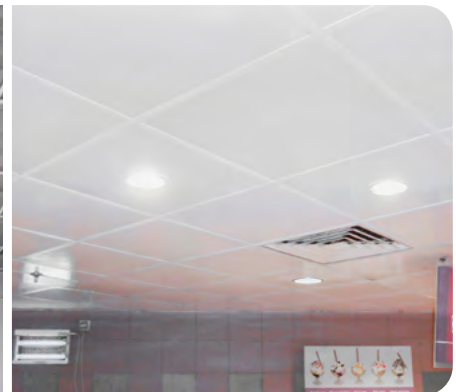

HygiCeiling in a supermarket.



CONSUMPTION GUIDELINES

Sheets and panels

The consumptions listed below in cc are per square meter of CleanSheet or laminated CleanSheet panel.

Example: 1 square meter of RamPanel requires 600cc of Hard Fix Glue. The joints can be finished with 40cc of HygiSeal. HygiSeal, sealant and Hard Fix Glue are delivered in bags of 600cc.

	Product	Hard Fix Glue / m ²	HygiSeal / m ²	Optional sealant (in combination with profiles) / m ²
Consumption	CleanSheet	600 cc	40 cc	150 cc
	RamPanel	600 cc	40 cc	/
	HygiWall	*	80 cc	80 cc
	InsuPanel	600 cc	40 cc	150 cc
	RenoPanel	600 cc	125 cc	150 cc

* The consumption of Hard Fix Glue for HygiWall serves as a guideline for applying glue in the U-profile (100 cc / running meter) and between the male and female connections (80 cc / running meter).

The estimated **installation times** include the following steps: cutting, applying profiles, glueing, and joint sealing.

Height wall = 1 panel length

Product	Installers needed for walls	Installers needed for ceilings	Renovation		New build	
			Small project < 100 m ² per day (8 hours)	Big project > 100 m ² per day (8 hours)	Small project < 250 m ² per day (8 hours)	Big project > 250 m ² per day (8 hours)
CleanSheet	2	3	30 m ²	50 m ²	40 m ²	60 m ²
RamPanel	2	/	30 m ²	50 m ²	40 m ²	60 m ²
HygiWall	2	3	50 m ²	70 m ²	70 m ²	90 m ²
InsuPanel	2	3	30 m ²	50 m ²	40 m ²	60 m ²
RenoPanel	2	3	30 m ²	50 m ²	40 m ²	60 m ²
HygiCeiling	/	3	40 m ²	50 m ²	50 m ²	60 m ²

Example: For a small project with an area less than 100 m², two installers are capable of mounting up to a total of 30 m² of CleanSheet per day.

Please note that these estimations are based on our experience and are non-binding. They are subject to the expertise of the installers and the conditions at the job site. Polysto Group BV cannot be held responsible for additional labor costs when these estimations are exceeded.

It is important to understand that each implementation has its own unique construction solution, which depends on the specific circumstances at the construction site.

When preparing a quotation, we consistently assume typical scenarios. To ensure the most accurate and detailed work, we kindly ask that you provide ample photographic or video evidence of the existing conditions when submitting price inquiries. This will help us better understand the unique requirements of your project and provide a more accurate estimation for your specific needs.



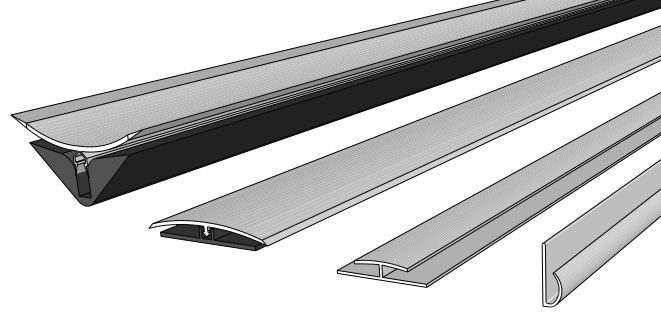

PROFILES

PVC, FRP or stainless steel profiles to finish sheets and panels.

CLEANSHEET

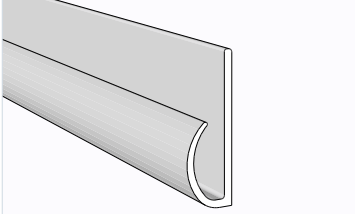

PFU_S_3	
Dimension	3.050 x 8 x 18 mm
Thickness	+/- 1,2 mm
Weight	0,12 kg/pc
Application	Start / end profile
Material	PVC
Suitable for	FRP sheets

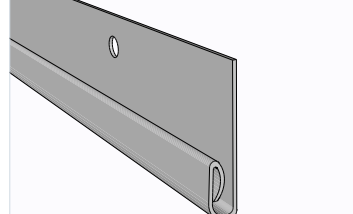

PFU_304_FRP_3	
Dimension	40-6-14 mm / 3.000 mm
Thickness	0,8 mm
Weight	1 kg/pc
Application	Start / end profile
Material	Stainless steel
Suitable for	FRP sheets

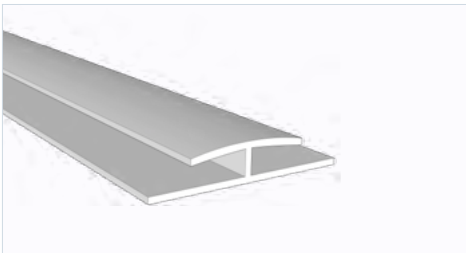

PFH_S_3	
Dimension	3.000 x 32 x 4 mm
Thickness	+/- 1 mm
Weight	0,12 kg/pc
Application	Connection
Material	PVC
Suitable for	FRP sheets

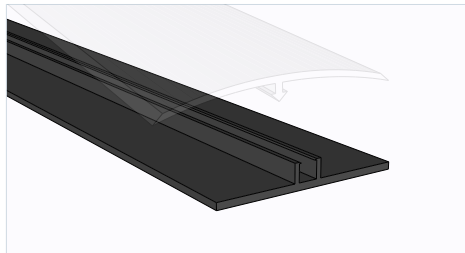

PFH_2B_3	
Dimension	3.000 x 5 x 40 mm
Thickness	+/- 2 mm
Weight	0,38 kg/pc
Application	Connection / base part
Material	PVC
Suitable for	FRP sheets

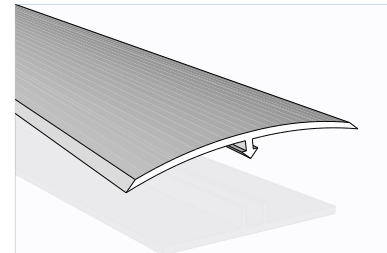

PFH_2C_3	
Dimension	3.000 x 5 x 50 mm
Thickness	+/- 2 mm
Weight	0,40 kg/pc
Application	Connection / cover part
Material	PVC
Suitable for	FRP sheets

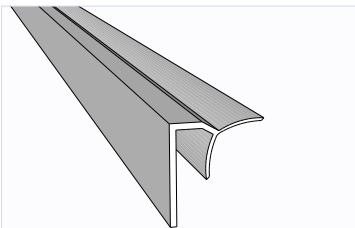

PFWIC_P_3	
Dimension	3000 x 8 x 18 mm
Thickness	+/- 1 mm
Weight	0,12 kg/pc
Application	Internal corner
Material	PVC
Suitable for	FRP sheets

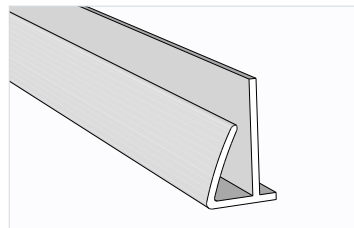

PFOC_S_3	
Dimension	3.000 x 8 x 16 mm
Thickness	+/- 2 mm
Weight	0,12 kg/pc
Application	External corner
Material	PVC
Suitable for	FRP sheets



The maximum ambient temperature for PVC profiles is 60°C.

HS-Code PVC profiles	39 25 90 10
HS-Code FRP profiles	39 21 90 10
HS-Code stainless steel profiles	72 16 21 00

RAMPANEL / RENOPANEL

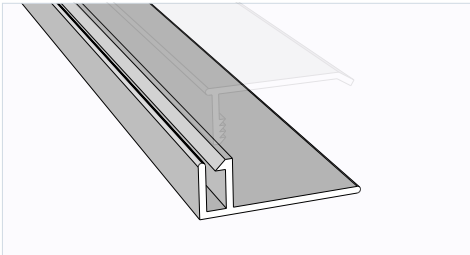

PFUS_P_2B_3	
Dimension	3.000 x 12 x 35 mm
Thickness	+ - 2 mm
Weight	0,42 kg/pc
Application	Start / end profile
Material	PVC
Suitable for	RamPanel / RenoPanel

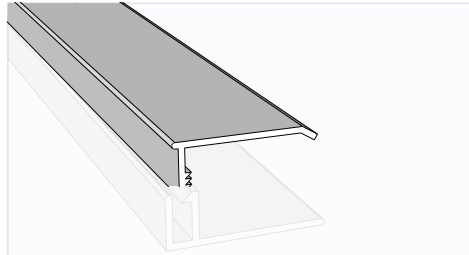

PFUS_P_2C_3	
Dimension	3.000 x 13 x 35 mm
Thickness	+ - 2 mm
Weight	0,38 kg/pc
Application	Start / end profile
Material	PVC
Suitable for	RamPanel / RenoPanel

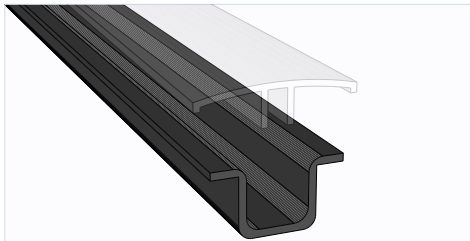

PFO_P_2B_3	
Dimension	3.000 x 12 x 30 mm
Thickness	+ - 2 mm
Weight	0,48 kg/pc
Application	Connection / base part
Material	PVC
Suitable for	RenoPanel

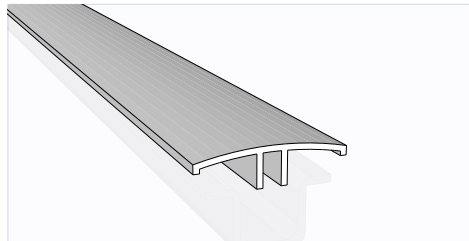

PFO_P_2C_3	
Dimension	3.000 x 11 x 50 mm
Thickness	+ - 1,5 mm
Weight	1,48 kg/pc
Application	Connection / cover part
Material	PVC
Suitable for	RenoPanel

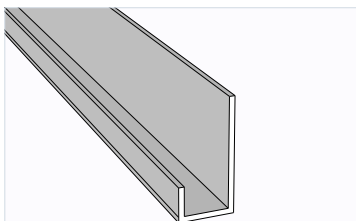

PFU_P_1_3	
Dimension	3000 x 12 x 30 mm
Thickness	+ - 2 mm
Weight	0,45 kg/pc
Application	Start / end profile
Material	PVC
Suitable for	RenoPanel
HS-Code	39 16 20 00

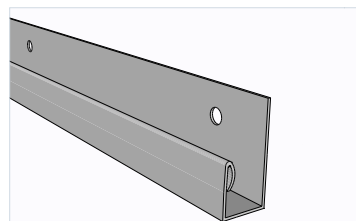

PFU_304_RENO_3	
Dimension	30-9-15 mm / 3.000 mm
Thickness	0,8 mm
Weight	1,5 kg/pc
Application	Start / end profile
Material	Stainless steel
Suitable for	RamPanel



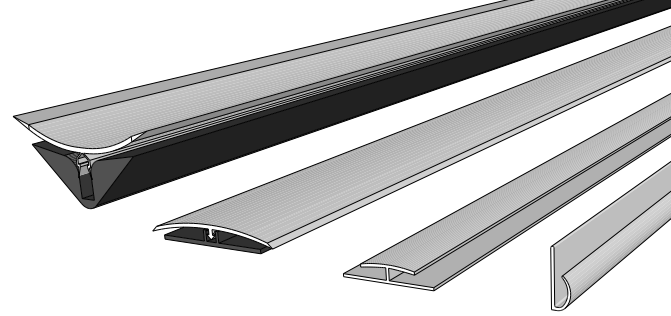

PROFILES

PVC, FRP or stainless steel profiles to finish sheets and panels.

INSUPANEL

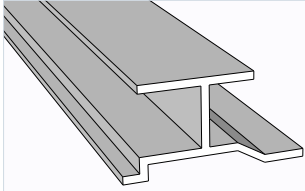

PFH_MF_3	
Dimension	3.000 x 20 x 45 mm
Thickness	+ - 2 mm
Weight	0,75 kg/pc
Application	H-profile for mounting
Material	PVC
Suitable for	InsuPanel
HS-Code	39 25 90 10



ROUNDED COVING

Aluminium base with PVC cover part. Rounded coving suitable for CleanSheet, HygiWall, RamPanel, InsuPanel, RenoPanel, sandwich panels, etc...

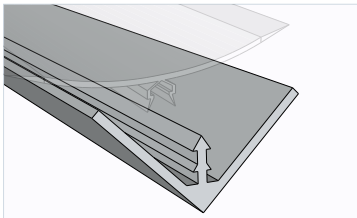

PFWCC_2_BAP_3	
Dimension	3.000 x 40 x 40 mm
Thickness	+ - 2 mm
Weight	0,87 kg/pc
Application	Base part
Material	Aluminium
HS-Code	76 04 29 90

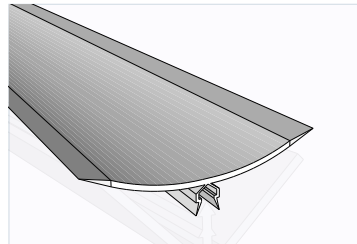

PFWCC_2_100C_3	
Dimension	3.000 x 10 x 100 mm
Thickness	+ - 2 mm
Weight	0,58 kg/pc
Application	Cover part
Material	PVC
HS-Code	39 25 90 10

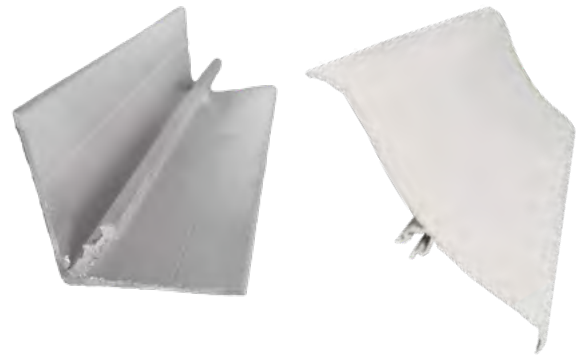

PFWCC_C_3IN	
3 way internal corner	
Dimension	100 x 100 mm
Weight	0,20 kg/pc
Material	PVC
Use with	PFWCC_2_100
HS-Code	39 25 90 10

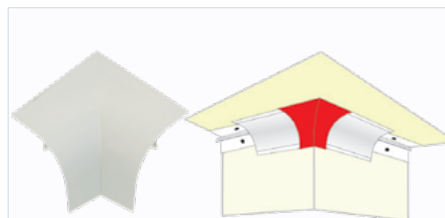

PFWCC_C_2EX	
2 way external corner	
Dimension	100 x 100 mm
Weight	0,20 kg/pc
Material	PVC
Use with	PFWCC_2_100
HS-Code	39 25 90 10

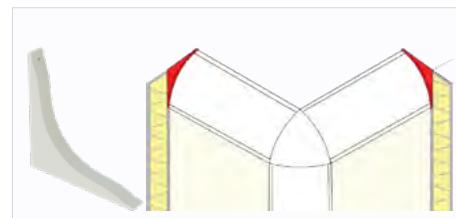

PFWCC_C_EP	
End piece	
Dimension	100 mm
Weight	0,10 kg/pc
Material	PVC
Use with	PFWCC_2_100
HS-Code	39 25 90 10

The maximum ambient temperature for PVC profiles is 60°C.

ROUNDED COVING

Full-core PVC base with PVC cover part suitable for CleanSheet, RamPanel, InsuPanel & RenoPanel.

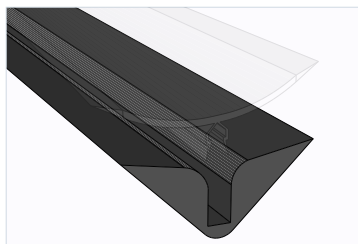

PFAPP_2_65B_3	
Dimension	3.000 x 35 x 35 mm
Thickness	+/- 10 mm
Weight	1,49 kg/pc
Application	Base part
Material	Full PVC
HS-Code	39 25 90 80

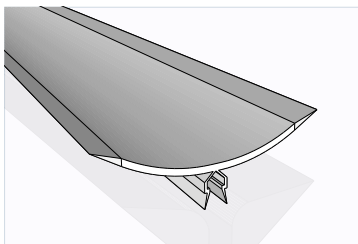

PFAPP_2_65C_3	
Dimension	3.000 x 16 x 65 mm
Thickness	+/- 2 mm
Weight	0,44 kg/pc
Application	Cover part
Material	PVC
HS-Code	39 25 90 80



PFAPP_C_2IN	
Internal corner part for 2 horizontal connections	
Dimension	65 x 65 mm
Weight	0,013 kg/pc
Material	PVC
Use with	PFAPP_2_65
HS-Code	39 25 90 80



PFAPP_C_3IN	
Internal corner part for 2 horizontal connections and 1 vertical	
Dimension	65 x 65 mm
Weight	0,013 kg/pc
Material	PVC
Use with	PFAPP_2_65
HS-Code	39 25 90 80

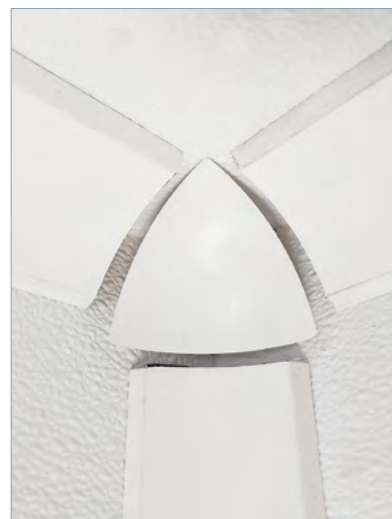

PFAPP_C_2EX	
External corner part for 2 horizontal connections	
Dimension	65 x 65 mm
Weight	0,013 kg/pc
Material	PVC
Use with	PFAPP_2_65
HS-Code	39 25 90 80

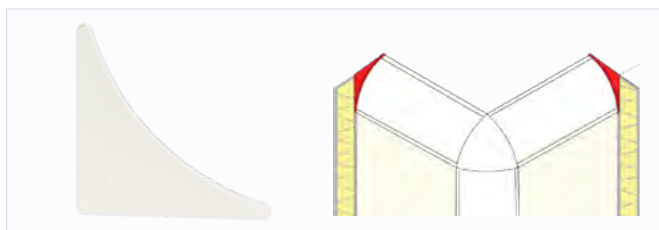

PFAPP_C_EP	
End piece	
Dimension	65 x 65 mm
Weight	0,01 kg/pc
Material	PVC
Use with	PFAPP_2_65
HS-Code	39 25 90 80

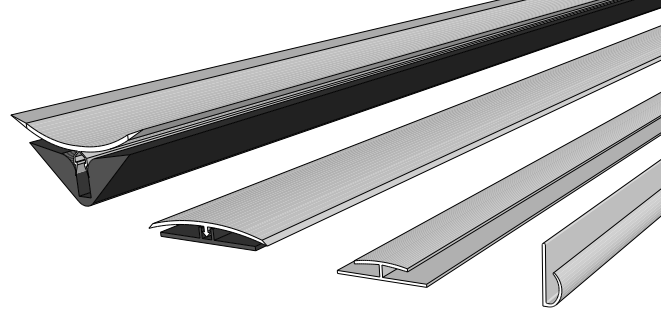

PROFILES

PVC, FRP or stainless steel profiles to finish sheets and panels.

CORNER AND COVER PROFILES

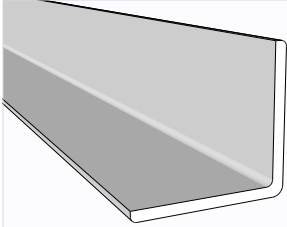

PFLC_40*40*3_3	
Dimension	3.000 x 40 x 40 mm
Thickness	3 mm
Weight	1,06 kg/pc
Application	External corner
Material	PVC
HS-Code	39 16 20 00

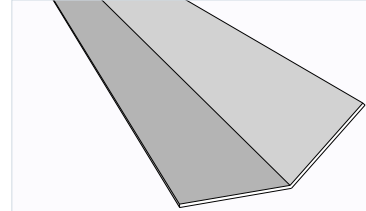

PFPC_P_3	
Dimension	3.000 x 50 x 50 mm
Thickness	1,6 mm
Weight	0,60 kg/pc
Application	Pliable corner (IN & OUT)
Material	PVC
HS-Code	39 25 90 10

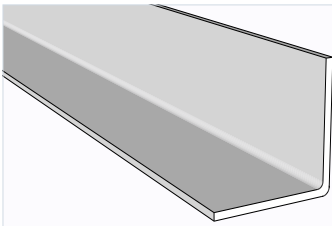

PFLPI_50x50_3	
Dimension	3.000 x 50 x 50 mm
Thickness	3 mm
Weight	3 kg/pc
Application	Internal corner
Material	FRP
HS-Code	39 21 90 10

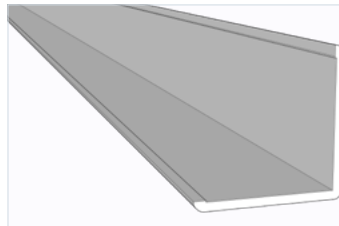

PFLP_50x50_R7_3	
Dimension	3.000 x 50 x 50 mm
Thickness	3 mm
Weight	3 kg/pc
Application	External corner
Material	FRP
HS-Code	39 21 90 10

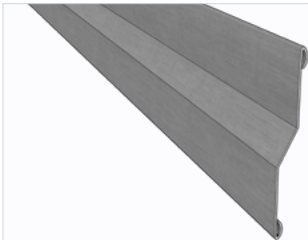

PFZ_304_3	
Dimension	30-20-30 mm / 3.000 mm
Thickness	0,8 mm
Weight	1,5 kg/pc
Application	Cover profile
Material	Stainless steel
Suitable for	RamPanel
HS-Code	72 16 21 00

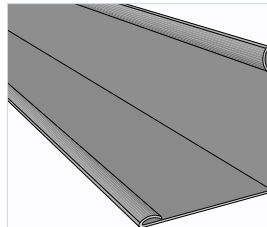
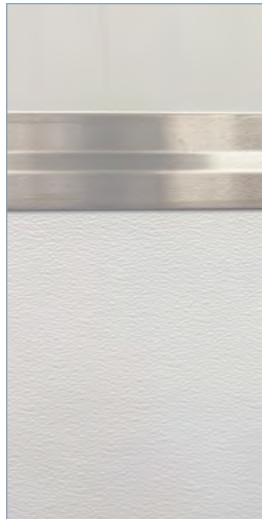

PFL_304_40*40_3	
Dimension	3.000 x 40 x 40 mm
Thickness	0,8 mm
Weight	1,5 kg/pc
Application	External corner
Material	Stainless steel
HS-Code	72 16 21 00

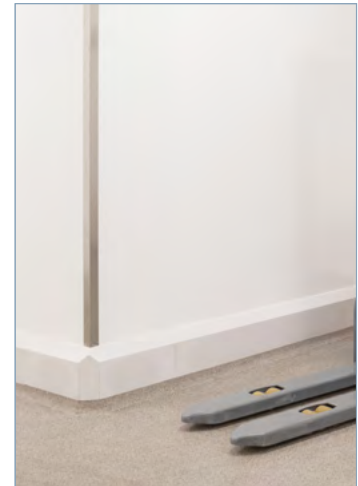

The maximum ambient temperature for PVC profiles is 60°C.

CLEANSHEET INNER CORNER

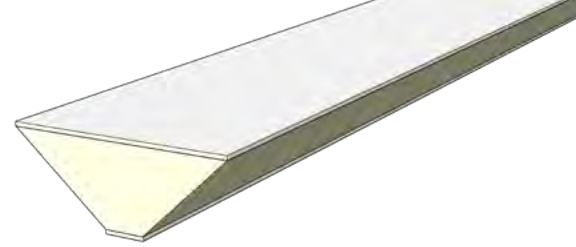

CLEANSHEET INNER CORNER	
PF_INSU_1,5S	30mm PIR + 1,5 mm CleanSheet smooth
PF_INSU_1,5E	30 mm PIR + 1,5 mm CleanSheet embossed
PF_INSU_FFRB1,5S	30mm PIR + 1,5mm CleanSheet smooth B,s2-d0
PF_INSU_FFRB1,5E	30mm PIR + 1,5mm CleanSheet embossed B,s2-d0

Dimension	80mm x 33 mm
Length	3.000 mm
Thickness	CleanSheet 1,5 mm
Weight	0,83 kg/pc
Application	Inner corner profile
Material	PIR insulation board CleanSheet Euroclass E / optional Euroclass B,s2-d0
Finish	Available in Embossed or Smooth CleanSheet surface
Suitable for	CleanSheet, HygiWall, RamPanel, InsuPanel, sandwich panels, etc...
HS-Code	39 25 90 10

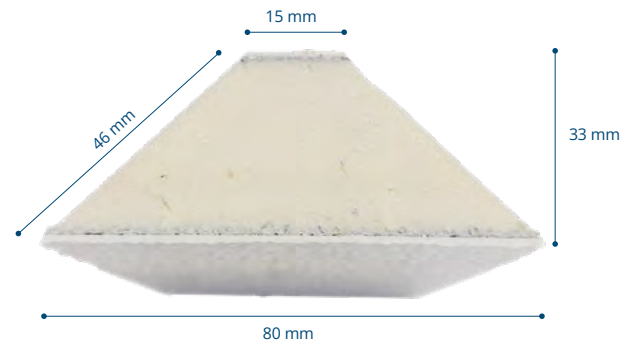

The **CleanSheet inner corner**, crafted from PIR insulation board and CleanSheet, is engineered to meet HACCP regulations, featuring a HygiSeal joint connection.

- New construction or renovation with new HygiWall.
- Renovation with CleanSheet, RamPanel, InsuPanel
- Avoid aluminum coving profiles and hollow spaces
- Double water barrier (Hard Fix Glue + HygiSeal)
- Temperature range: -60°C / +60°C

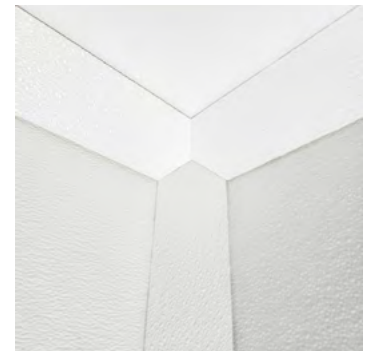

CEILING SUSPENSION FOR HYGIWALL

NEW

SUSPENSION T-PROFILE

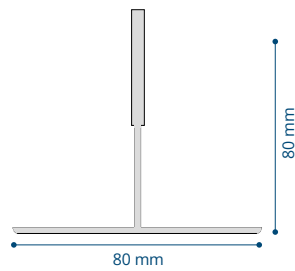
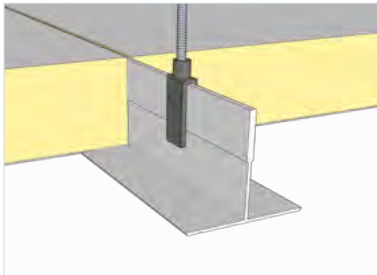

CS_FRP_T_80

Dimension	4.000 x 80 x 80 mm
Thickness	4 mm
Colour	RAL 9010
Weight	5,30 kg/pc
Application	Suspension profile
Material	FRP
Max. charge per hanging point	375 kg/m

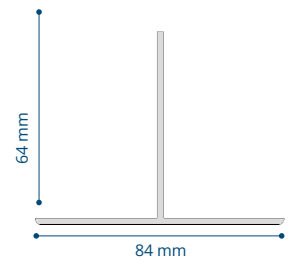
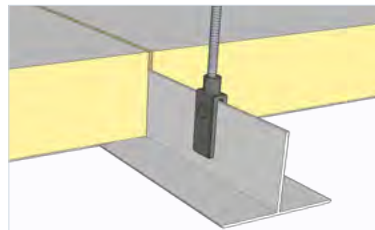

CS_ALU_T_84

Dimension	4.000 x 84 x 64 mm
Thickness	3,5 mm
Colour	RAL 9010
Weight	6,20 kg/pc
Application	Suspension profile
Material	Aluminium
Max. charge per hanging point	700 kg/m



CS_T_FX

Dimension	40 mm / M10
Weight	0,10 kg/pc
Material	Galvanized steel
Application	Fixation for M10 thread



CS_T_CN

Dimension	200 x 46 mm
Weight	0,8 kg/pc
Material	Steel
Application	Connector plate & pin



CS_THREAD_M10

Dimension	M10 - 2.000 mm
Weight	1,20 kg/pc
Material	Galvanized steel
Wire	Suspension thread

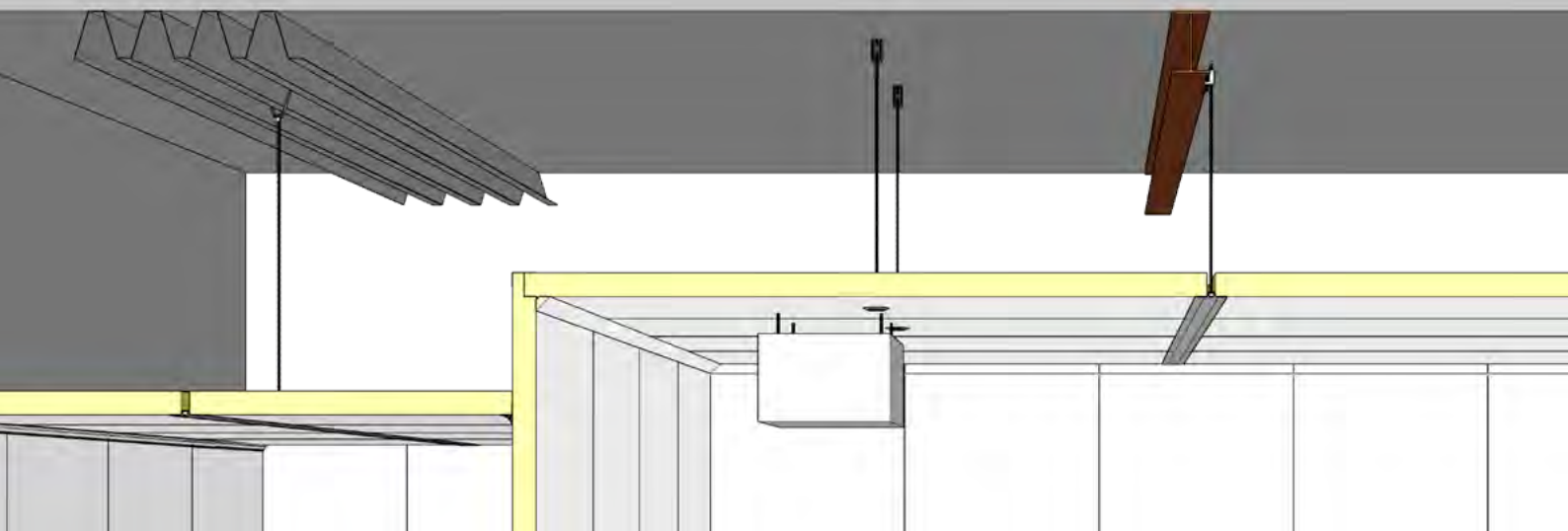

POM INSERT (MUSHROOM)

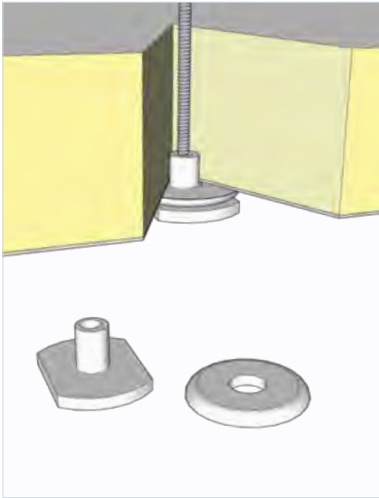

CS_POM_SCREW10	
Dimension	32 x 22 mm
Thickness	+ - 6 mm
Colour	RAL 9010
Weight	0,05 kg/pc
Application	Insert for hanging of panels / objects
Material	poly acetal
Pulling force	Max 1.000 kg

CS_POM_WASH10	
Dimension	ø60 mm
Thickness	+ - 6 mm
Colour	RAL 9010
Weight	0,05 kg/pc
Application	Insert for hanging of panels / objects
Material	poly acetal
Pulling force	Max 1.000 kg

ACCESSORIES SUSPENSION

CS_TIGHT_M10	
Dimension	120x60x50mm
Thickness	+ - 4 mm
Weight	0,30 kg/pc
Application	Tightening tool threaded rod
Material	Galvanized steel

CS_CLAMP_M10	
Weight	0,20 kg/pc
Application	Girder clamp M10
Material	Galvanized steel
Pulling force	Max 230 kg

CS_ALUTAPE	
Width	50 mm / 50m
Thickness	50µ
Weight	0,60 kg/pc
Application	Insulation airtight tape
Material	PP, coated with aluminum

PU_FOAM	
Package	750 ml
Application	Insulating panels
Material	Polyurethane
Weight	1,5 kg
HS-Code	39 09 50 10

Other ceiling suspension systems available upon request.

PREFAB KERBS

3 types of finishing



NATURAL

Strong and durable CleanRock kerb with a monolithic and smooth surface.

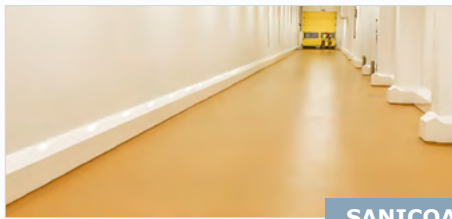

SANICOAT

High-care CleanRock kerb with smooth gelcoat (polyester base) to provide extra protection against aggressive cleaning agents and chemicals like salt, acids, blood, starch and lactic acid.

Other colours available on request. RAL 9010



STAINLESS STEEL

1,2 mm 1.4306 Stainless steel kerbs with concrete core.

Custom sizes are possible on request.

5 different versions

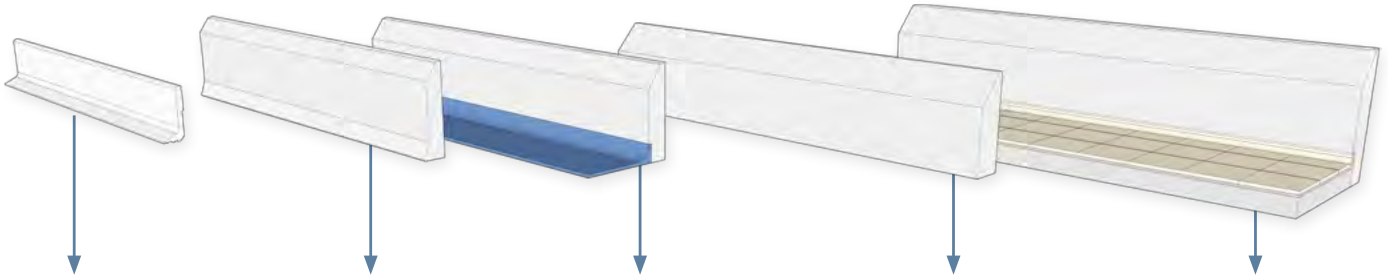

Full core PVC skirtings

- Polished concrete floors
- Liquid floors
- Cast resin floors
- Troweled floors
- Tile floors

F-type (Foot)

- Polished concrete floors
- Liquid floors
- Cast resin floors
- Troweled floors
- Tile floors

RB-type (Rebate)

- Cast resin floors
- Troweled floors
- Vinyl and liquid floors

R-type (Straight)

- Freezers and low-care logistic areas
- Polished concrete floors
- Liquid floors
- Cast resin & troweled floors

RBT-type (Rebate tile)

- Designed for tile floors
- Suitable for troweled floors

IMPACT LEVELS

IMPACT LEVEL 1

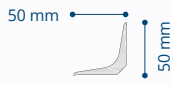

PVFCF

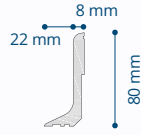

PV8F

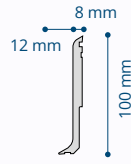

PV10F

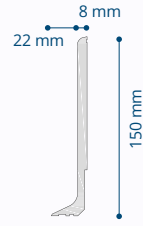

PV15F

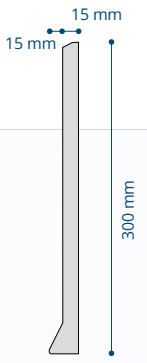

OP30SF

IMPACT LEVEL 2



Manual trolleys up to max. 200 kg total weight

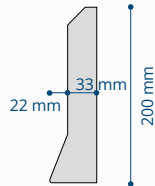

OP20F

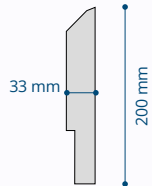

OP20RB

Rebate
10 x 60 mmH

IMPACT LEVEL 3

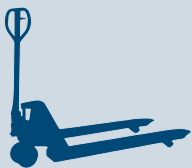

Manual pallet truck up to max. 900 kg total weight

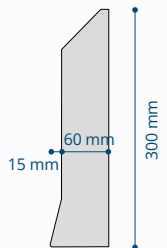

OP30F

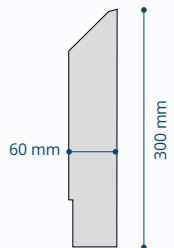

OP30RB4

Rebate
4 x 60 mmH

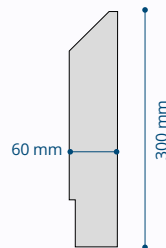

OP30RB10

Rebate
10 x 60 mmH

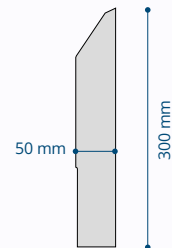

OP30RBCR

Rebate
2 x 100 mmH

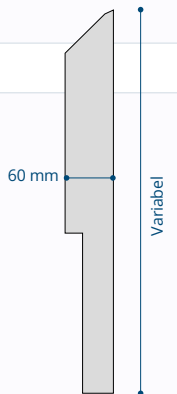

OP48RBT

Rebate
22 x 200 mmH

IMPACT LEVEL 4



Electric pallet trucks up to max. 1500 kg total weight

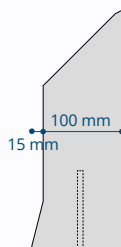

IP30F

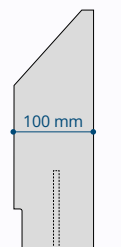

IP30RB

Rebate
10 x 50 mmH

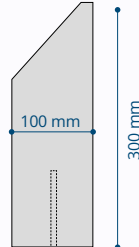

IP30R

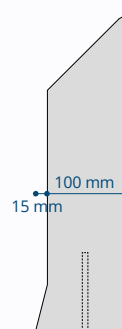

IP40F



IP40RB

Rebate
12 x 50 mmH

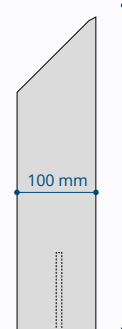

IP40R

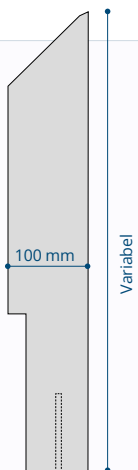

IP58RBT

Rebate
22 x 200 mmH

IMPACT LEVEL 5*

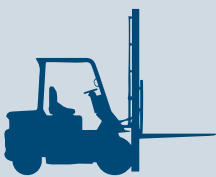

Engine driven pallet trucks up to max. 4000 kg total weight

* Impact class 5 can be reached when installing kerbs including chemical anchorage. Consult the installation instructions for chemical anchorage for more information.

Other types and models available upon request (height, thickness, finish).



FULL CORE PVC SKIRTINGS

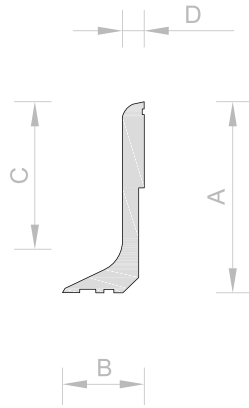
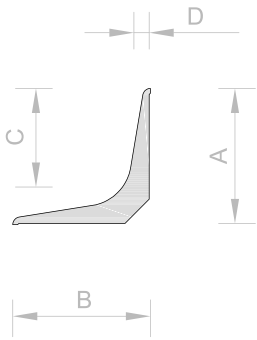

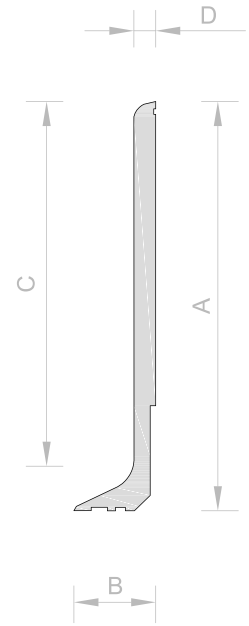
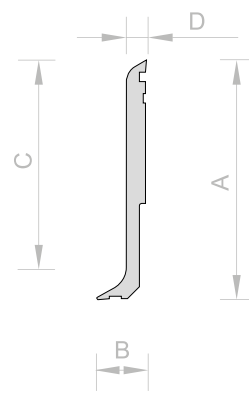

NEW



	Impact class	Length	A	B	C	D	Weight / pc	# per pallet
PVFCF	1	2.000 mm	50 mm	50 mm	35 mm	8 mm	2 kg	500 pc
PV8F	1	2.000 mm	80 mm	30 mm	50 mm	8 mm	2 kg	500 pc
PV10F	1	2.000 mm	100 mm	17 mm	87 mm	8 mm	2,2 kg	500 pc
PV15F	1	2.000 mm	150 mm	30 mm	120 mm	8 mm	4 kg	250 pc

	Internal corner (IN)	
	Length	Weight / pc
PVFCF	160 / 160 mm	0,36 kg
PV8F	60 / 60 mm	0,07 kg
PV10F	140 / 140 mm	0,40 kg
PV15F	60 / 60 mm	0,11 kg

	External corner (EX)	
	Length	Weight / pc
	160 / 160 mm	0,36 kg
	160 / 160 mm	0,36 kg
	150 / 150 mm	0,40 kg
	160 / 160 mm	0,72 kg

Standard colour:  

Other RAL colour (from 500m) on request

HS-Code PVC skirtings 39 18 10 10



PolySto prefabricated **PV15F** full core PVC skirting installed against a FRP embossed sheet, finished with HygiSeal.



PREFAB CLEANROCK KERBS



FOOT TYPE

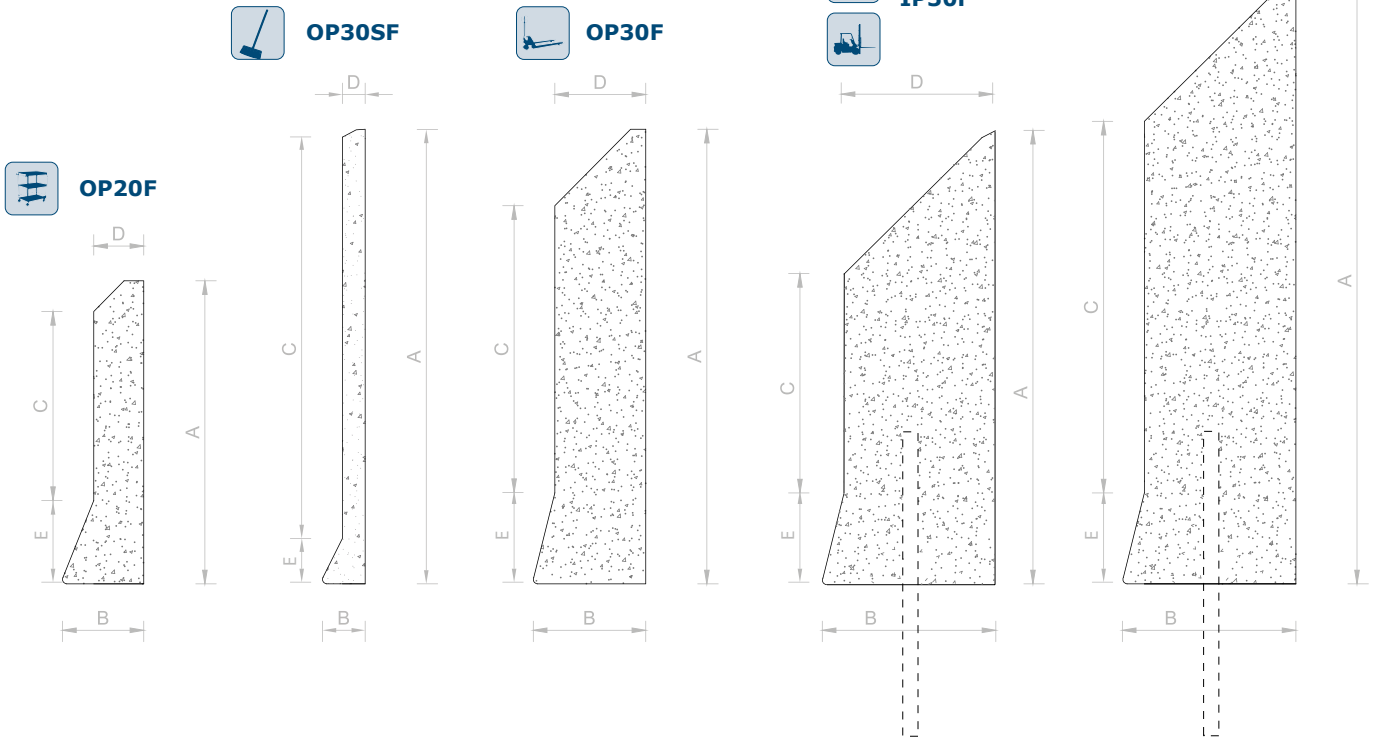

	Impact class	Length	A	B	C	D	E	Weight / pc	# per pallet
OP20F	2	1.000 mm	200 mm	55 mm	122 mm	33 mm	55 mm	15,6 kg	50 pc
OP30SF	1	1.500 mm	300 mm	30 mm	268 mm	15 mm	25 mm	15,2 kg	50 pc
OP30F	3	1.500 mm	300 mm	75 mm	187 mm	60 mm	55 mm	60,2 kg	20 pc
IP30F	4 or 5*	1.500 mm	300 mm	115 mm	148 mm	100 mm	55 mm	93 kg	12 pc
IP40F	4 or 5*	1.500 mm	400 mm	115 mm	248 mm	100 mm	55 mm	124,2 kg	12 pc

	Internal corner (IN)			External corner (EX)			End piece left (EL) or right (ER)		
	Length	Weight / pc	# per pallet	Length	Weight / pc	# per pallet	Length	Weight / pc	# per pallet
OP20F	2 x 500 mm	15,6 kg	50 pc	2 x 450 mm	15,6 kg	50 pc	500 mm	7,8 kg	100 pc
OP30F	2 x 500 mm	37,6 kg	20 pc	2 x 450 mm	37,6 kg	20 pc	500 mm	18,8 kg	40 pc
IP30F	2 x 500 mm	56,5 kg	12 pc	2 x 450 mm	56,5 kg	12 pc	500 mm	28,30 kg	24 pc
IP40F	2 x 500 mm	75,5 kg	12 pc	2 x 450 mm	75,5 kg	12 pc	500 mm	37,75 kg	24 pc

* Impact class 5 can be reached when installing kerbs including chemical anchorage.
Straight elements of 1.500 mm need 4 drillings. Elements of 500 mm need 2 drillings per piece.

HS-Code CleanRock kerbs 39 25 90 80

Additional options for CleanRock kerbs	
UITSP_ACHTER_KL	UITSP_ACHTER_GR
 Kerbs impact level 3, 4 and 5	 Kerbs impact level 4 and 5
Additional rebate applied in the backside of the kerb to cover existing covered skirtings or other objects	
ANC150	Chemical anchorage - 4 drillings / kerb - ø 10 mm - 150 mmL
ANC200	Chemical anchorage - 4 drillings / kerb - ø 10 mm - 200 mmL
RAL	Sanicoat gelcoat is RAL 9010. Other RAL colour available on request



PolySto prefabricated IP40F Natural CleanRock kerb.



PREFAB CLEANROCK KERBS

WITH REBATE FOR CAST FLOORING

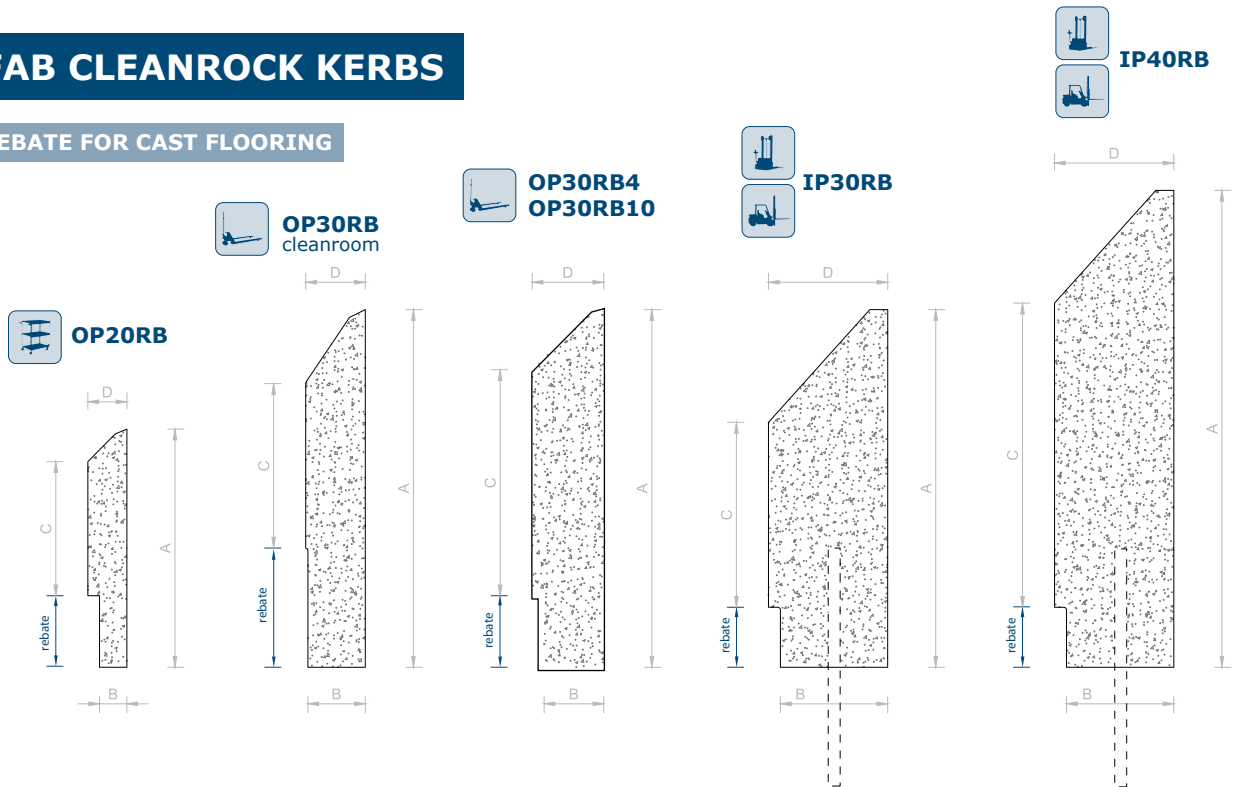

	Impact class	Length	Rebate	A	B	C	D	Weight / pc	# per pallet
OP20RB	2	1.000 mm	10 x 60 mmH	200 mm	23 mm	117 mm	33 mm	13,2 kg	50 pc
OP30RBCR	3	1.500 mm	2 x 100 mmH	300 mm	48 mm	141 mm	50 mm	45 kg	20 pc
OP30RB4	3	1.500 mm	4 x 60 mmH	300 mm	56 mm	184 mm	60 mm	55,4 kg	20 pc
OP30RB10	3	1.500 mm	10 x 60 mmH	300 mm	50 mm	184 mm	60 mm	55,4 kg	20 pc
IP30RB	4 or 5*	1.500 mm	10 x 50 mmH	300 mm	90 mm	162 mm	100 mm	84 kg	12 pc
IP40RB	4 or 5*	1.500 mm	12 x 50 mmH	400 mm	88 mm	259 mm	100 mm	127 kg	12 pc

	Internal corner (IN)			External corner (EX)			End piece left (EL) or right (ER)		
	Length	Weight / pc	# per pallet	Length	Weight / pc	# per pallet	Length	Weight / pc	# per pallet
OP20RB	2 x 500 mm	12 kg	50 pc	2 x 450 mm	12 kg	50 pc	500 mm	6 kg	100 pc
OP30RBCR	2 x 1.500 mm	87 kg	10 pc	2 x 1.450 mm	87 kg	10 pc	1.500 mm	43,5 kg	20 pc
OP30RB4	2 x 500 mm	33,2 kg	20 pc	2 x 450 mm	33,2 kg	20 pc	500 mm	16,6 kg	40 pc
OP30RB10	2 x 500 mm	33,2 kg	20 pc	2 x 450 mm	33,2 kg	20 pc	500 mm	16,6 kg	40 pc
IP30RB	2 x 500 mm	56,4 kg	12 pc	2 x 450 mm	56,8 kg	12 pc	500 mm	28,4 kg	24 pc
IP40RB	2 x 500 mm	77 kg	12 pc	2 x 450 mm	76,8 kg	12 pc	500 mm	38,4 kg	24 pc

* Impact class 5 can be reached when installing kerbs including chemical anchorage.
Straight elements of 1.500 mm need 4 drillings. Elements of 500 mm need 2 drillings per piece.

HS-Code CleanRock kerbs 39 25 90 80



PolySto prefabricated **OP30RB Natural** CleanRock kerb with rebate for cast flooring.



PolySto prefabricated **IP40RB SaniCoat** CleanRock kerb with a resin floor applied into the rebate.



PREFAB CLEANROCK KERBS

STRAIGHT FOR LOGISTIC AREAS & FREEZERS

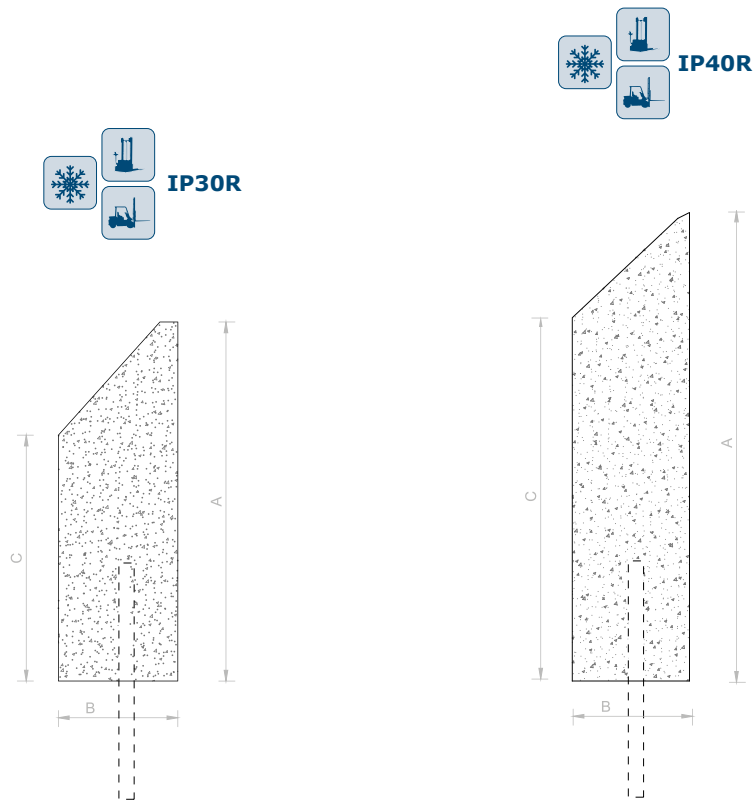

	Impact class	Length	A	B	C	Weight / pc	# per pallet
IP30R	4 or 5*	1.500 mm	300 mm	100 mm	208 mm	93,6 kg	12 pc
IP40R	4 or 5*	1.500 mm	400 mm	100 mm	307 mm	122 kg	12 pc

	Internal corner (IN)			External corner (EX)			End piece left (EL) or right (ER)		
	Length	Weight / pc	# per pallet	Length	Weight / pc	# per pallet	Length	Weight / pc	# per pallet
IP30R	2 x 500 mm	58 kg	12 pc	2 x 450 mm	58 kg	12 pc	500 mm	29 kg	24 pc
IP40R	2 x 500 mm	82 kg	12 pc	2 x 450 mm	82 kg	12 pc	500 mm	1 kg	24 pc

* Impact class 5 can be reached when installing kerbs including chemical anchorage.
Straight elements of 1.500 mm need 4 drillings. Elements of 500 mm need 2 drillings per piece.

HS-Code CleanRock kerbs 39 25 90 80

Chemical anchorage is not possible in (shock) freezers!

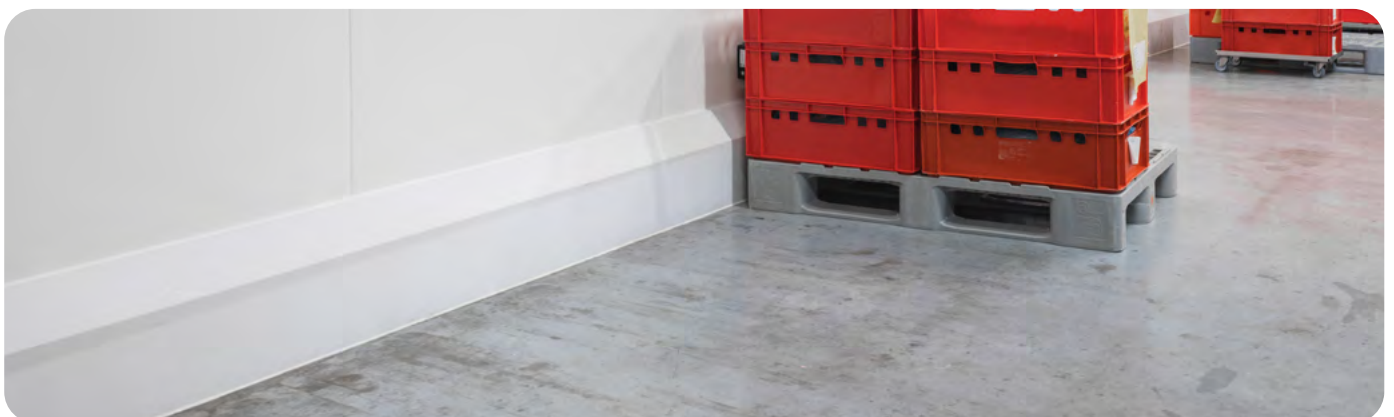

PolySto prefabricated **IP30R Natural** CleanRock kerb.





PREFAB CLEANROCK KERBS

WITH REBATE FOR TILED FLOORING

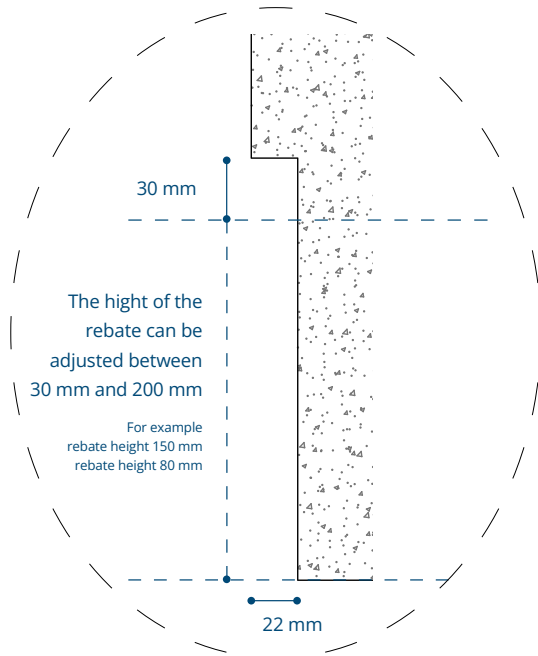

OP48RBT

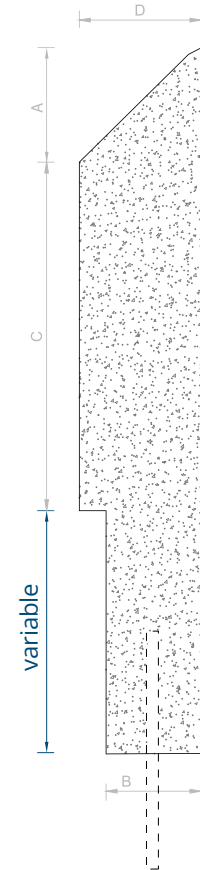
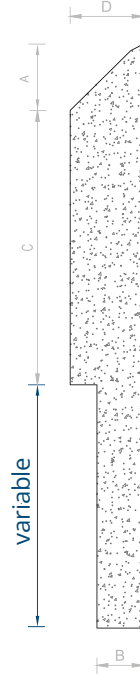

	Impact class	Length	Rebate	A	B	C	D	Weight / pc	# per pallet
OP48RBT	3	1.500 mm	22 x 200 mmH	55 mm	38 mm	225 mm	60 mm	82 kg	20 pc
IP58RBT	4 or 5*	1.500 mm	22 x 200 mmH	95 mm	78 mm	285 mm	100 mm	159 kg	6 pc

	Internal corner (IN)			External corner (EX)			End piece left (EL) or right (ER)		
	Length	Weight / pc	# per pallet	Length	Weight / pc	# per pallet	Length	Weight / pc	# per pallet
OP48RBT	2 x 500 mm	54,5 kg	10 pc	2 x 450 mm	54,5 kg	10 pc	500 mm	27,25 kg	20 pc
IP58RBT	2 x 500 mm	106 kg	6 pc	2 x 450 mm	106 kg	6 pc	500 mm	53 kg	12 pc

* Impact class 5 can be reached when installing kerbs including chemical anchorage.
Straight elements of 1.500 mm need 4 drillings. Elements of 500 mm need 2 drillings per piece.

HS-Code CleanRock kerbs 39 25 90 80



PolySto prefabricated CleanRock kerbs with rebate for hexagonal tiled floors.



CONSUMPTION GUIDELINES

The consumptions listed below in cc are per linear meter of PolySto kerb.

Example: 1 meter of Polysto OP30F requires 450cc of Hard Fix Glue and when sealant is required a total of 290cc. HygiSeal, sealant and Hard Fix Glue are delivered in bags of 600cc. Chemfix in tubes of 410 cc.



	Product	Top & vertical joint	Bottom joint	Hard Fix Glue	Optional Chemfix per drilling	Installers	Installation of kerbs	
		HygiSeal or sealant	HygiSeal or sealant				m/day sealant	m/day HygiSeal
PVC	PVFCF	60 cc	60 cc	120 cc	/	1	40	25
	PV8F	60 cc	60 cc	120 cc	/	1	40	25
	PV10F	60 cc	60 cc	150 cc	/	1	40	25
	PV15F	65 cc	100 cc	150 cc	/	1	40	25
SaniCoat	OP20F	140 cc	100 cc	300 cc	/	1	40	20
	OP20RB	135 cc	/	300 cc	/	1	40	25
	OP30F	140 cc	150 cc	450 cc	/	2	40	30
	OP30SF	140 cc	150 cc	300 cc	/	1	40	30
	OP30RB	135 cc	/	450 cc	/	2	40	35
	OP30RBCR	95 cc	/	450 cc	/	2	40	35
	OP48RBT	140 cc	/	600 cc	/	2	30	25
	IP30F	150 cc	200 cc	600 cc	70 cc	2	30	20
	IP30R	205 cc	200 cc	600 cc	70 cc	2	30	20
	IP30RB	200 cc	/	600 cc	70 cc	2	30	25
	IP40F	150 cc	200 cc	650 cc	70 cc	2	30	20
	IP40R	150cc	200 cc	650 cc	70 cc	2	30	20
	IP40RB	205 cc	/	650 cc	70 cc	2	30	25
	IP58RBT	150 cc	/	800 cc	70 cc	2	30	25

	Product	HygiSeal or sealant	HygiSeal or sealant	Hard Fix Glue	Optional Chemfix per drilling	Installers	m/day sealant	m/day HygiSeal
Natural	OP20F	140 cc	100 cc	300 cc	/	1	40	20
	OP20RB	135 cc	/	300 cc	/	1	40	25
	OP30F	140 cc	150 cc	450 cc	/	2	40	30
	OP30SF	140 cc	150 cc	300 cc	/	1	40	30
	OP30RB	135 cc	/	450 cc	/	2	40	35
	OP48RBT	140 cc	/	450 cc	/	2	30	25
	IP30F	205 cc	200 cc	600 cc	70 cc	2	30	20
	IP30R	205 cc	200 cc	600 cc	70 cc	2	30	20
	IP30RB	200 cc	/	600 cc	70 cc	2	30	25
	IP40F	150 cc	200 cc	650 cc	70 cc	2	30	20
	IP40R	150cc	200 cc	650 cc	70 cc	2	30	20
	IP40RB	205 cc	/	650 cc	70 cc	2	30	25
	IP58RBT	150 cc	/	800 cc	70 cc	2	30	25

	Product	Top joint	Bottom joint	Vertical joint	Hard Fix Glue	Optional Chemfix per drilling	Installers	Installation of kerbs	
		HygiSeal or sealant	HygiSeal or sealant	HygiSeal RAL7004				m/day sealant	m/day HygiSeal
Stainless Steel	PV10Fi	50 cc	60 cc	10 cc	150 cc	/	1	40	25
	OP20Fi	85 cc	100 cc	20 cc	300 cc	/	1	40	20
	OP20Rbi	85 cc	/	15 cc	300 cc	/	1	40	25
	OP30SFi	85 cc	150 cc	20 cc	300 cc	/	1	40	30
	OCS30F	60 cc	150 cc	20 cc	450 cc	/	2	40	30
	OCS30RB	60 cc	/	15 cc	450 cc	/	2	40	35
	ICS30F	60 cc	200 cc	20 cc	600 cc	70 cc	2	30	20
	ICS30R	60 cc	200 cc	20 cc	600 cc	70 cc	2	30	20
	ICS30RB	60 cc	/	20 cc	600 cc	70 cc	2	30	25
	ICS40F	60 cc	200 cc	30 cc	650 cc	70 cc	2	30	20
	ICS40R	60 cc	200 cc	25 cc	650 cc	70 cc	2	30	20
	ICS40RB	60 cc	/	25 cc	650 cc	70 cc	2	30	25
	ICS50R	60 cc	200 cc	30 cc	700 cc	70 cc	2	30	20
	ICS50RB	60 cc	/	30 cc	700 cc	70 cc	2	30	25

* We strongly suggest to apply Sealant or HygiSeal in the same colour of the wall panel.

These estimates are based on our experience and are non-binding. They depend on installer expertise and site conditions. Polysto Group BV is not responsible for extra labor costs if estimates are exceeded.

Each implementation requires a unique construction solution, influenced by the size of the joints to be filled with sealant or HygiSeal.

If installing Polysto kerbs with chemical anchorage, an extra installer is needed to drill into the construction floor using Polysto drilling molds (refer to chemical anchorage installation instructions).

During the quotation phase, floor type and joint size are not always known. Initial calculations assume silicone for the bottom joint as standard. For flat (unstructured) floors with bottom joints no larger than 5 mm, HygiSeal may be used instead.

PREFAB STAINLESS STEEL SKIRTINGS

FOOT TYPE

NEW



PV10Fi

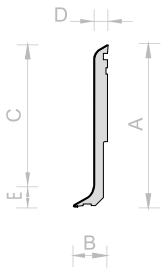

OP20Fi

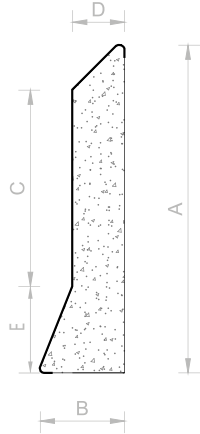

OP20RBi

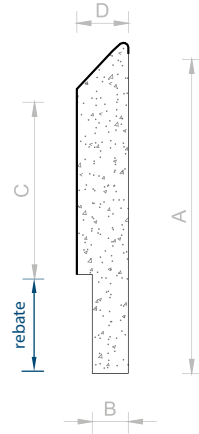

OP30SFi

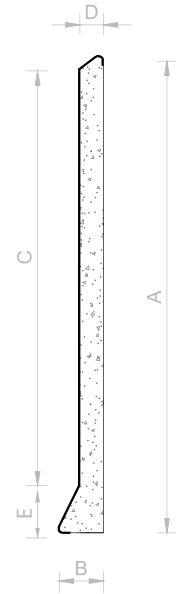

	Impact class	Length	A	B	C	D	E	Rebate	Weight / pc	# per pallet
PV10Fi	1	2.000 mm	102 mm	18 mm	87 mm	9 mm	15 mm	x	3,3 kg	250 pc
OP20Fi	2	1.000 mm	213 mm	59 mm	124 mm	33 mm	55 mm	x	15 kg	50 pc
OP20RBi	3	1.000 mm	213 mm	23 mm	120 mm	33 mm	/	10 x 60 mmH	14 kg	50 pc
OP30SFi	1	1.500 mm	300 mm	30 mm	268 mm	15 mm	20 mm	x	15 kg	50 pc

	Internal corner (IN)			External corner (EX)			End piece left (EL) or right (ER)		
	Length	Weight / pc	# per pallet	Length	Weight / pc	# per pallet	Length	Weight / pc	# per pallet
PV10Fi	2 x 140 mm	0,55 kg	/	2 x 150 mm	0,55 kg	/	102/18 mm	0,10 kg	/
OP20Fi	2 x 500 mm	15 kg	50 pc	2 x 450 mm	15 kg	50 pc	500 mm	7,5 kg	100 pc
OP20RBi	2 x 500 mm	14 kg	50 pc	2 x 450 mm	14 kg	50 pc	500 mm	7 kg	100 pc

The skirting PV10Fi has a full recycled PVC core.
The skirtings OP20Fi, OP20RBi and OP30SFi have a CleanRock core.

HS-Code stainless steel skirtings 39 25 90 80



PolySto prefabricated **OP20Fi stainless steel** kerb with CleanRock core.



PREFAB STAINLESS STEEL CONCRETE KERBS

FOOT TYPE

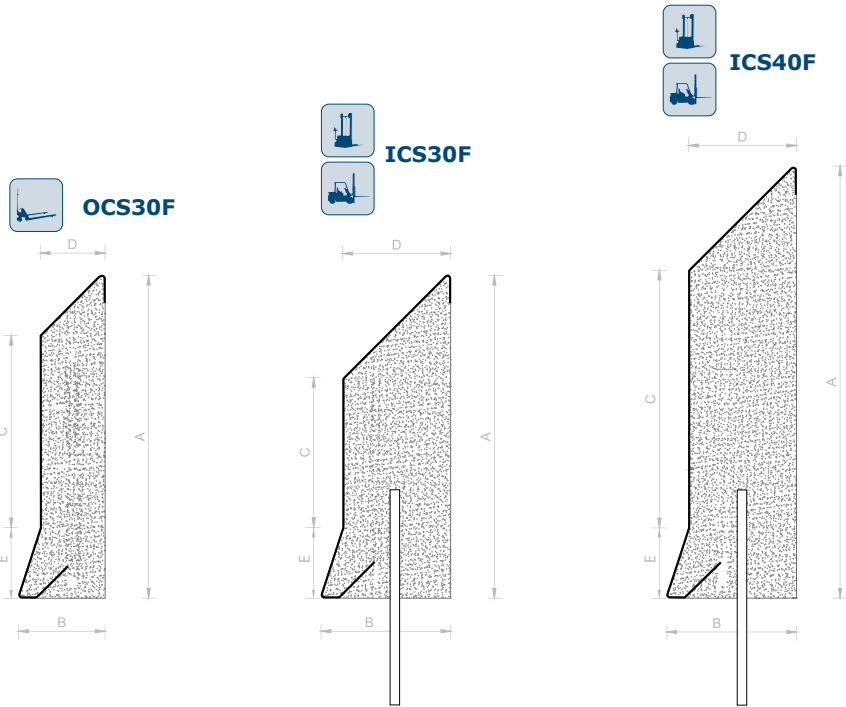

	Impact class	Length	A	B	C	D	E	Weight / pc	# per pallet
OCS30F	3	1.500 mm	300 mm	73 mm	177 mm	60 mm	55 mm	57,8 kg	20 pc
ICS30F	4 or 5*	1.500 mm	300 mm	115 mm	137 mm	100 mm	55 mm	100 kg	12 pc
ICS40F	4 or 5*	1.500 mm	400 mm	115 mm	237 mm	100 mm	55 mm	124 kg	12 pc

	Internal corner (IN)			External corner (EX)			End piece left (EL) or right (ER)		
	Length	Weight / pc	# per pallet	Length	Weight / pc	# per pallet	Length	Weight / pc	# per pallet
OCS30F	2 x 500 mm	38,5 kg	20 pc	2 x 450 mm	38,5 kg	20 pc	500 mm	19,25 kg	40 pc
ICS30F	2 x 500 mm	67 kg	12 pc	2 x 450 mm	67 kg	12 pc	500 mm	33 kg	24 pc
ICS40F	2 x 500 mm	84 kg	12 pc	2 x 450 mm	84 kg	12 pc	500 mm	84 kg	12 pc

* Impact class 5 can be reached when installing kerbs including chemical anchorage.

HS-Code stainless steel kerbs 39 25 90 80

Additional options for Stainless steel kerbs	
UITSP_ACHTER_KL	
Kerbs impact level 4 and 5	
Additional rebate applied in the backside of the kerb to cover existing coved skirtings or other objects	
ANC150	Chemical anchorage - 4 drillings / kerb - ø 10 mm - 150 mmL
ANC200	Chemical anchorage - 4 drillings / kerb - ø 10 mm - 200 mmL

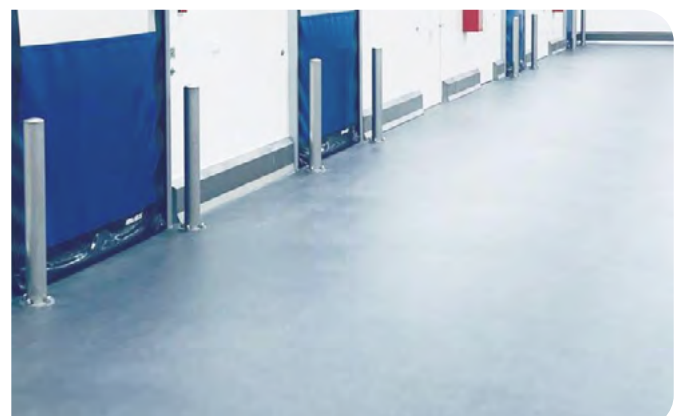

PolySto prefabricated **OCS30F** stainless steel kerb with concrete core installed on top of a cast floor.



PREFAB STAINLESS STEEL CONCRETE KERBS

WITH REBATE FOR CAST FLOORING

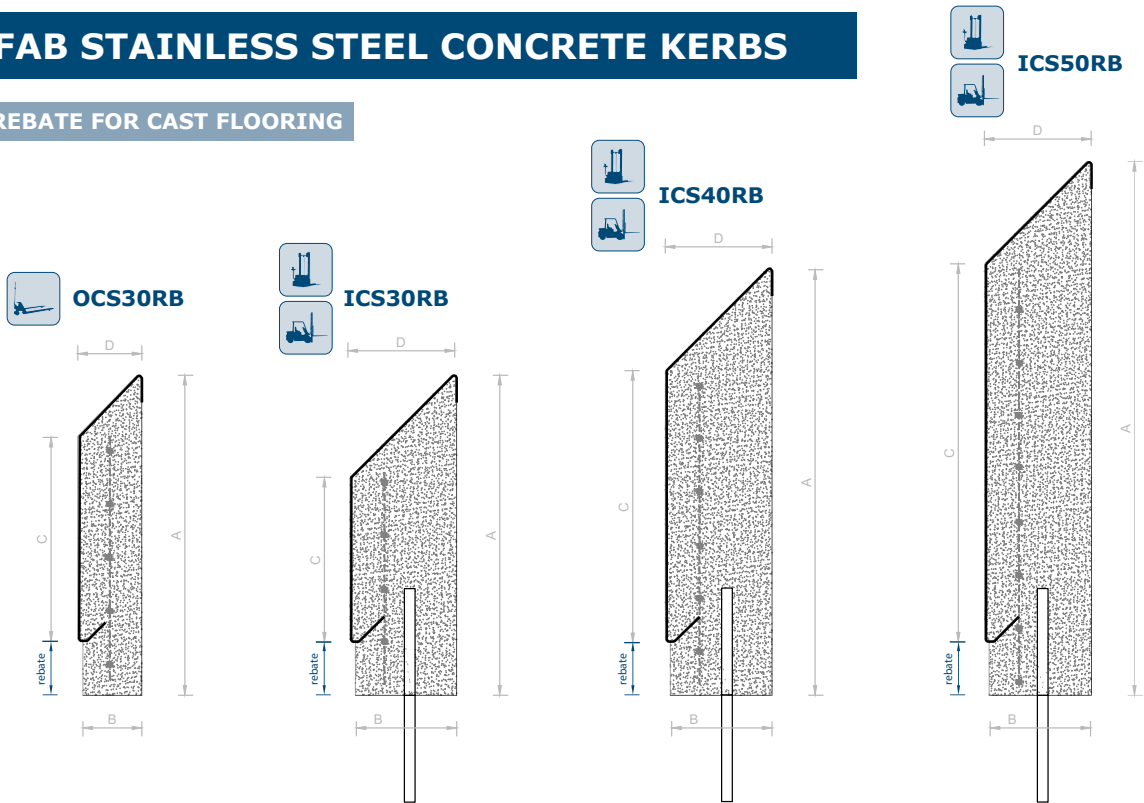

	Impact class	Length	Rebate	A	B	C	D	Weight / pc	# per pallet
OCS30RB	3	1.500 mm	5 x 50 mmH	300 mm	55 mm	192 mm	60 mm	55,5 kg	20 pc
ICS30RB	4 or 5*	1.500 mm	5 x 50 mmH	300 mm	95 mm	154 mm	100 mm	84 kg	12 pc
ICS40RB	4 or 5*	1.500 mm	5 x 50 mmH	400 mm	95 mm	253 mm	100 mm	123 kg	12 pc
ICS50RB	4 or 5*	1.500 mm	5 x 50 mmH	500 mm	95 mm	353 mm	100 mm	135 kg	10 pc

	Internal corner (IN)			External corner (EX)			End piece left (EL) or right (ER)		
	Length	Weight / pc	# per pallet	Length	Weight / pc	# per pallet	Length	Weight / pc	# per pallet
OCS30RB	2 x 500 mm	37 kg	20 pc	2 x 450 mm	37 kg	20 pc	500 mm	18,5 kg	40 pc
ICS30RB	2 x 500 mm	56 kg	12 pc	2 x 450 mm	56 kg	12 pc	500 mm	28 kg	24 pc
ICS40RB	2 x 500 mm	82 kg	12 pc	2 x 450 mm	82 kg	12 pc	500 mm	41 kg	24 pc
ICS50RB	2 x 500 mm	90 kg	6 pc	2 x 450 mm	90 kg	6 pc	500 mm	45 kg	12 pc

* Impact class 5 can be reached when installing kerbs including chemical anchorage.

HS-Code stainless steel kerbs 39 25 90 80



PolySto prefabricated **ICS40RB** stainless steel kerb with concrete core with a resin floor applied into the rebate.



PREFAB STAINLESS STEEL CONCRETE KERBS

STRAIGHT FOR LOGISTIC AREAS & FREEZERS



ICS30R

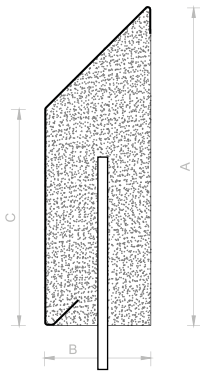

ICS40R

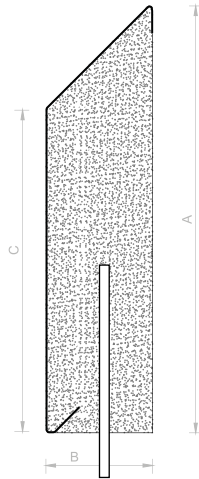

ICS50R

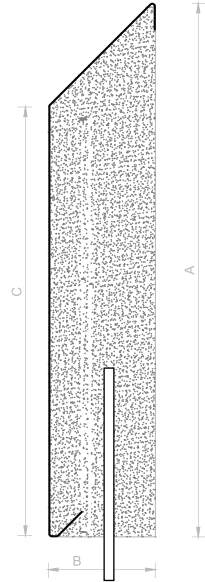

	Impact class	Length	A	B	C	Weight / pc	# per pallet
ICS30R	4 or 5*	1.500 mm	300 mm	100 mm	192 mm	84 kg	12 pc
ICS40R	4 or 5*	1.500 mm	400 mm	100 mm	154 mm	124 kg	12 pc
ICS50R	4 or 5*	1.500 mm	500 mm	100 mm	253 mm	138 kg	10 pc

	Internal corner (IN)			External corner (EX)			End piece left (EL) or right (ER)		
	Length	Weight / pc	# per pallet	Length	Weight / pc	# per pallet	Length	Weight / pc	# per pallet
ICS30R	2 x 500 mm	56 kg	12 pc	2 x 450 mm	56 kg	12 pc	500 mm	28 kg	24 pc
ICS40R	2 x 500 mm	84 kg	12 pc	2 x 450 mm	84 kg	12 pc	500 mm	42 kg	24 pc
ICS50R	2 x 500 mm	92 kg	6 pc	2 x 450 mm	92 kg	6 pc	500 mm	46 kg	12 pc

* Impact class 5 can be reached when installing kerbs including chemical anchorage.
Straight elements of 1.500 mm need 4 drillings. Elements of 500 mm need 2 drillings per piece.

HS-Code stainless steel kerbs 39 25 90 80

Chemical anchorage is not possible in (shock) freezers!

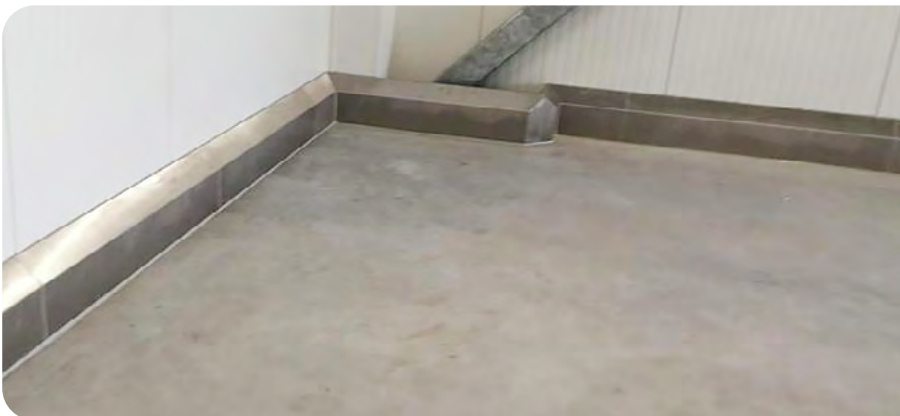

PolySto prefabricated ICS30R stainless steel kerb with concrete core.



POLYETHYLENE WALL PROTECTION

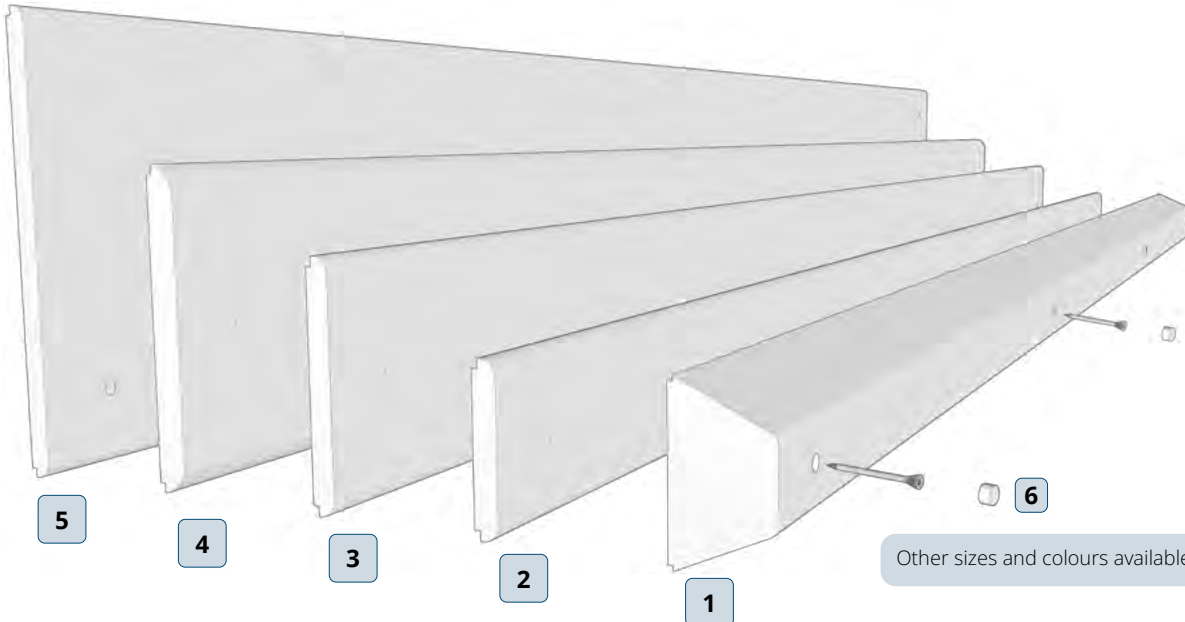

	No.	Length	Height	Thickness	# drillings	Colour	Weight / pc	# per pallet
PE2000x100x60	1	2.000 mm	100 mm	60 mm	4 pc	White	11,50 kg	80 pc
PE2000x100x15	2	2.000 mm	100 mm	15 mm	4 pc	White	2,88 kg	250 pc
PE2000x100x15_DARKGREY	2	2.000 mm	100 mm	15 mm	4 pc	Dark Grey	2,88 kg	250 pc
PE2000x150x15	3	2.000 mm	150 mm	15 mm	4 pc	White	4,32 kg	150 pc
PE2000x200x20	4	2.000 mm	200 mm	20 mm	4 pc	White	7,68 kg	100 pc
PE2000x300x15	5	2.000 mm	300 mm	15 mm	8 pc	White	8,64 kg	75 pc
PEDOPJES	6	10 mm cover cap for hidden screw fixation						

PE500					
Temperature range	-100°C / +80°C				
Density	0,96 g/cm ³ (DIN EN ISO 1183-1)				
PE strips are marked as „FoodClass“.					
HS-Code	39 26 90 97				
Estimated Installation time	<table border="0"> <tr> <td>Mounted on sandwich panel:</td> <td>Mounted with plug on kerb or solid wall:</td> </tr> <tr> <td>100 meter a day with 2 installers</td> <td>50 meter a day with 2 installers</td> </tr> </table>	Mounted on sandwich panel:	Mounted with plug on kerb or solid wall:	100 meter a day with 2 installers	50 meter a day with 2 installers
Mounted on sandwich panel:	Mounted with plug on kerb or solid wall:				
100 meter a day with 2 installers	50 meter a day with 2 installers				

EXTREME IMPACT

Installing a polyethylene strip either on the front of the kerb or directly next to the wall panel provides optimal protection against **heavy impacts** in areas with frequent internal traffic and constant collisions, especially against the sharp edges of Euronorm bins.”

Custom sizes available upon request!

Consumption	
Hard Fix Glue	250 cc / lm
HygiSeal (top joint)	25 cc / lm

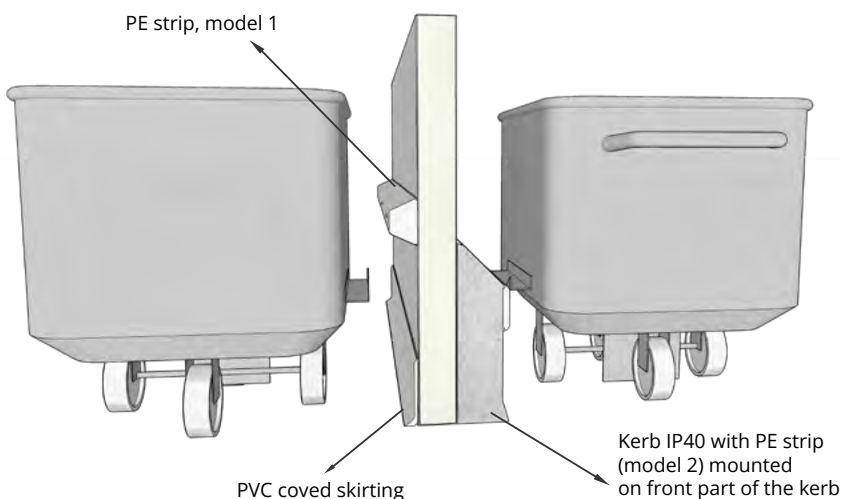

PE WALL PROTECTION



STAINLESS STEEL COLUMN PROTECTION

PolySto Column Boxes are stainless steel shells designed to provide effective impact protection for both drainage systems and columns. Specifically created for installation alongside PolySto prefabricated kerbs, these durable solutions help protect critical infrastructure from the impacts of daily transport activities.

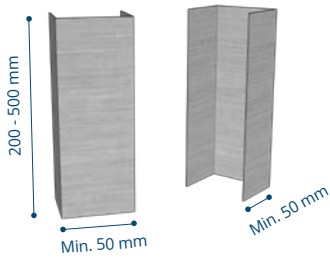

	BOX_U
Material	Stainless Steel
Thickness	1,2 mm
Finishing	Vertically brushed
Height	200 - 500 mm
Application	Budget solution to protect drainage pipes and small (steel) columns
HS-Code	72 19 11 00

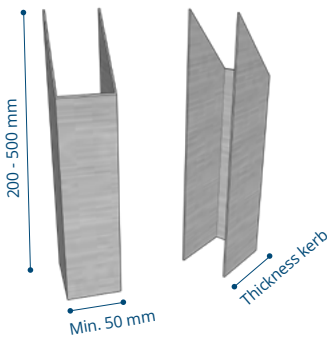

	BOX_Y
Material	Stainless Steel
Thickness	1,2 mm
Finishing	Vertically brushed
Height	200 - 500 mm
Application	Stainless Steel box in shape of PolySto kerb (from impact level 3) to protect drainage pipes and small (steel) columns
HS-Code	72 19 11 00

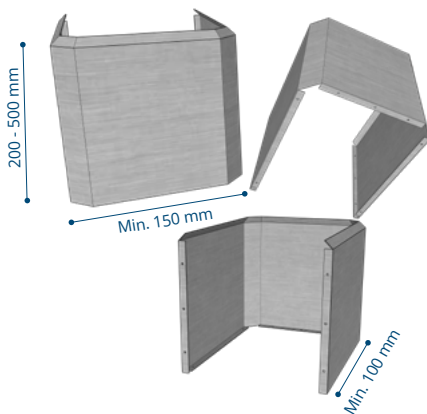

	BOX_S
Material	Stainless Steel
Thickness	1,2 mm
Finishing	Vertically brushed
Height	200 - 500 mm
Application	Premium solution to protect drainage pipes and (steel) columns
HS-Code	72 19 11 00

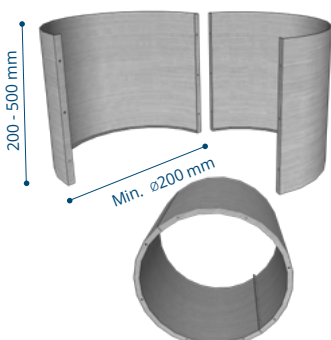

	BOX_R
Material	Stainless Steel
Thickness	1,2 mm
Finishing	Vertically brushed
Height	200 - 500 mm
Application	Rounded column box to protect stand alone (steel) columns. Delivered in 2 pieces
HS-Code	72 19 11 00



Custom shapes and sizes available on request.

COLUMN PROTECTION

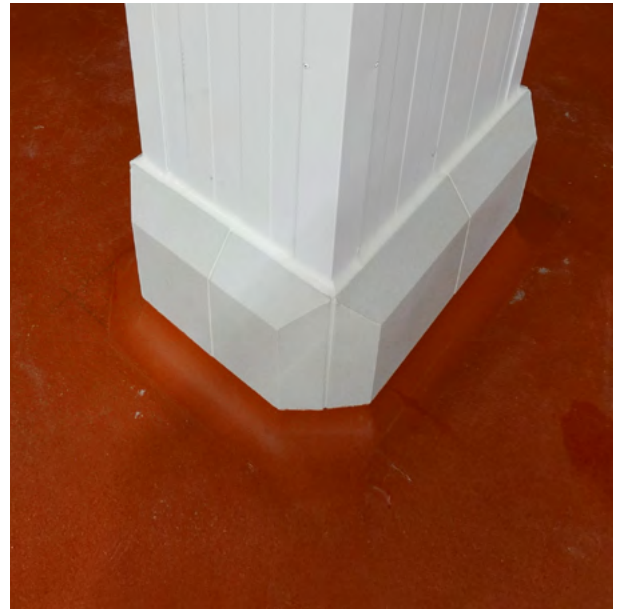
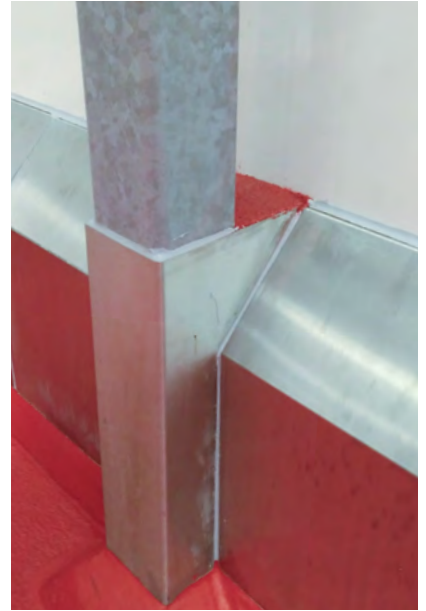

STAINLESS STEEL BOLLARDS

WITH CONCRETE CORE

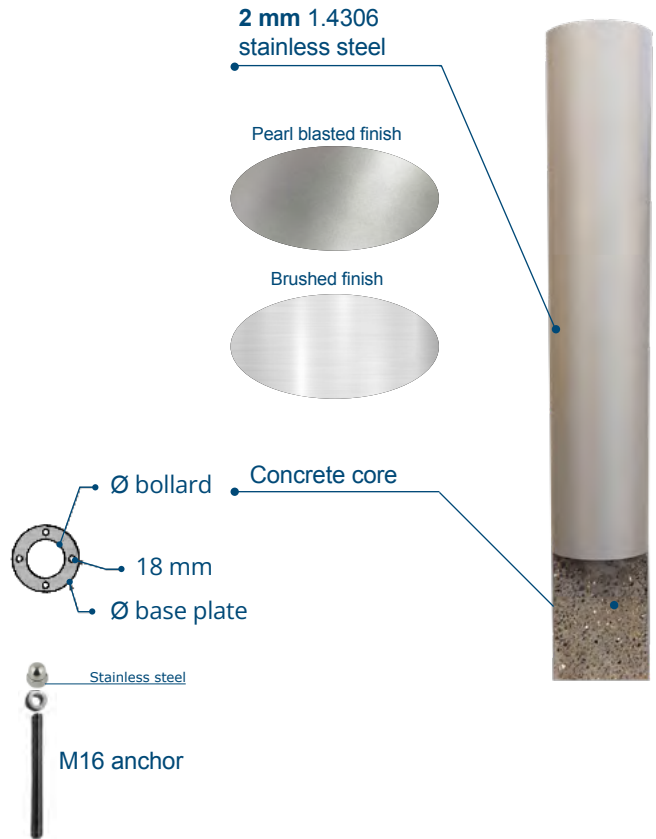
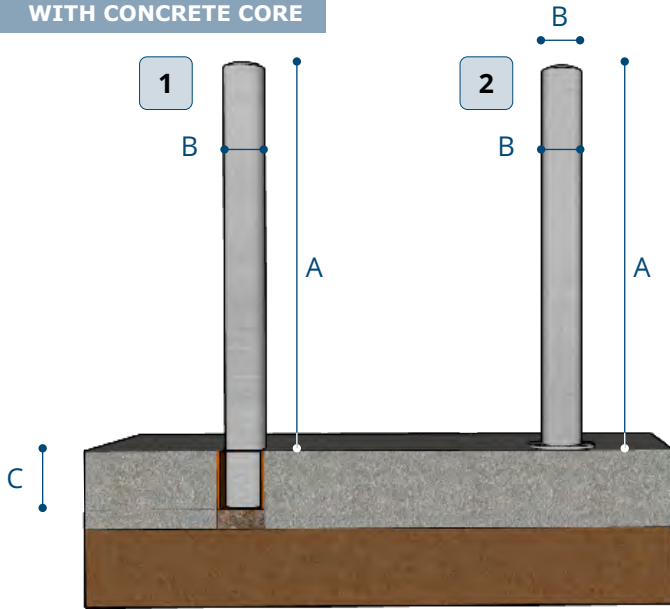

1 Stainless steel bollard for core drilling



	Impact class	A	B	C	# Chemfix	# HygiSeal	Weight / pc	# per pallet
P60/600+150	2	600 mm	Ø 60 mm	150 mm	250 cc	30 cc	7,5 kg	34 pc
P89/750+150	3	750 mm	Ø 89 mm	150 mm	350 cc	45 cc	17,5 kg	30 pc
P104/750+150	3	750 mm	Ø 104 mm	150 mm	410 cc	50 cc	21 kg	25 pc
P204/750+150	5	750 mm	Ø 204 mm	150 mm	820 cc	100 cc	75 kg	7 pc
P89/1000+150	3	1.000 mm	Ø 89 mm	150 mm	350 cc	45 cc	21,5 kg	30 pc
P104/1000+150	3	1.000 mm	Ø 104 mm	150 mm	410 cc	50 cc	28 kg	25 pc
P154/1000+150	4	1.000 mm	Ø 154 mm	150 mm	550 cc	75 cc	54 kg	12 pc
P204/1000+150	5	1.000 mm	Ø 204 mm	150 mm	820 cc	100 cc	100 kg	7 pc

2 Stainless steel bollard with base plate (flange)

HS-Code stainless steel bollards 73 26 90 98

	Impact class	A	B	Ø base plate	# Chemfix	# HygiSeal	Weight / pc	# per pallet
P60/600FL	2	600 mm	Ø 60 mm	Ø 131 mm	80 cc	30 cc	7,5 kg	20 pc
P89/750FL	2	750 mm	Ø 89 mm	Ø 159 mm	80 cc	45 cc	13 kg	15 pc
P104/750FL	2	750 mm	Ø 104 mm	Ø 175 mm	80 cc	50 cc	17 kg	15 pc
P89/1000FL	2	1.000 mm	Ø 89 mm	Ø 159 mm	80 cc	45 cc	13 kg	15 pc
P104/1000FL	2	1.000 mm	Ø 104 mm	Ø 175 mm	80 cc	50 cc	24 kg	15 pc
P154/1000FL	3	1.000 mm	Ø 154 mm	Ø 225 mm	80 cc	75 cc	49 kg	6 pc



STAINLESS STEEL h-BARRIERS

WITH CONCRETE CORE

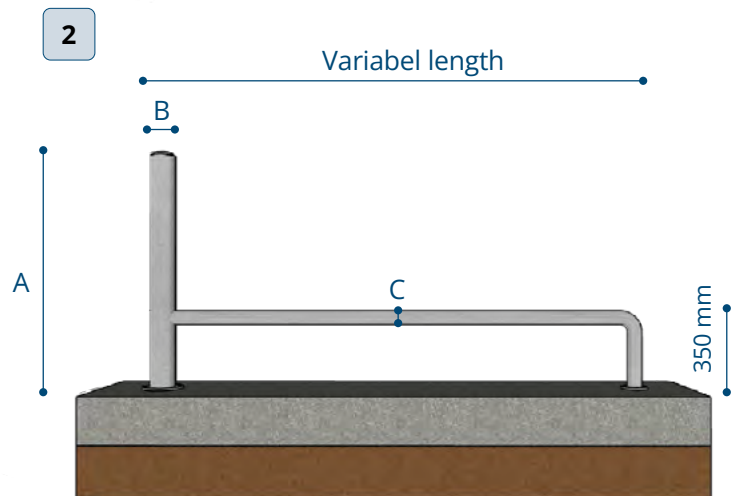
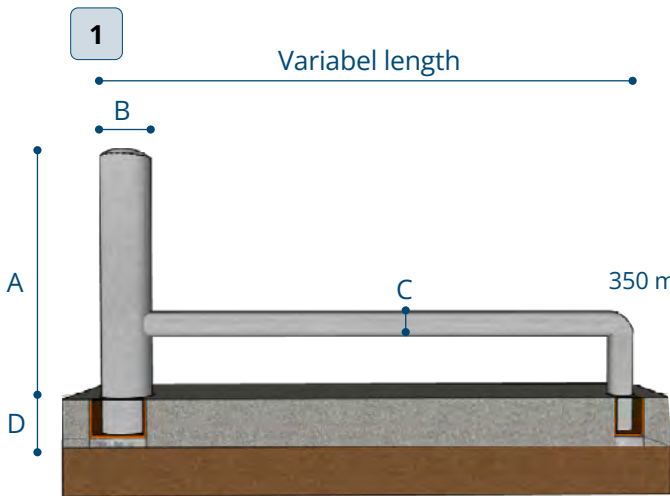

1 Stainless steel H-barrier for core drilling



	Impact class	A	B	C	D	# Chemfix	# HygiSeal
h_B_104/60/750+150	3	750 mm	Ø 104 mm	Ø 60 mm	150 mm	660 cc	80 cc
h_B_104/89/750+150	3	750 mm	Ø 104 mm	Ø 89 mm	150 mm	760 cc	95 cc
h_B_154/89/1000+150	4	1.000 mm	Ø 154 mm	Ø 89 mm	150 mm	900 cc	120 cc
h_B_154/104/1000+150	4	1.000 mm	Ø 154 mm	Ø 104 mm	150 mm	960 cc	125 cc
h_B_204/104/1000+150	5	1.000 mm	Ø 204 mm	Ø 104 mm	150 mm	1.230 cc	150 cc
h_B_204/154/1000+150	5	1.000 mm	Ø 204 mm	Ø 154 mm	150 mm	1.370 cc	175 cc

2 Stainless steel H-barrier with base plate (flange)

HS-Code stainless steel barriers 73 26 90 98

	Impact class	A	B	C	Ø base plate	# Chemfix	# HygiSeal
h_B_104/60/750FL	2	750 mm	Ø 104 mm	Ø 60 mm	Ø 175 mm	660 cc	80 cc
h_B_104/89/750FL	2	750 mm	Ø 104 mm	Ø 89 mm	Ø 175 mm	760 cc	95 cc
h_B_154/89/1000FL	3	1.000 mm	Ø 154 mm	Ø 89 mm	Ø 225 mm	900 cc	120 cc
h_B_154/104/1000FL	3	1.000 mm	Ø 154 mm	Ø 104 mm	Ø 225 mm	960 cc	125 cc
h_B_204/104/1000FL	3	1.000 mm	Ø 204 mm	Ø 104 mm	Ø 275 mm	1.230 cc	150 cc
h_B_204/154/1000FL	3	1.000 mm	Ø 204 mm	Ø 154 mm	Ø 275 mm	1.370 cc	175 cc



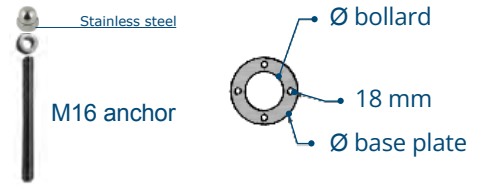

STAINLESS STEEL U-BARRIER

WITH CONCRETE CORE

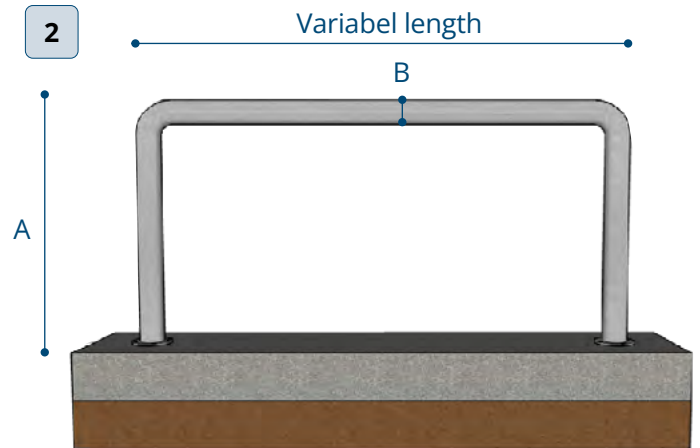
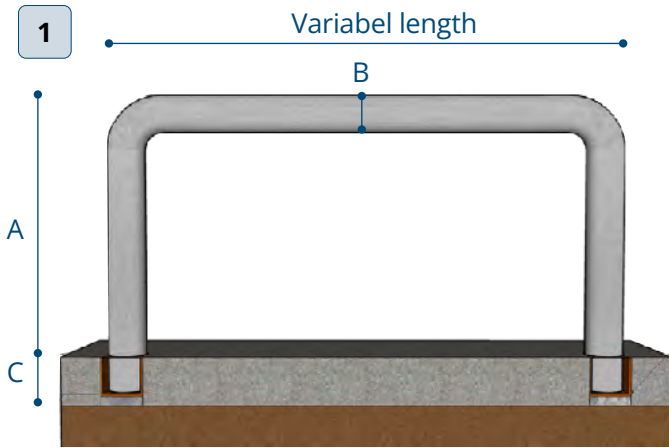

1 Stainless steel U-barrier for core drilling



	Impact class	A	B	C	# Chemfix	# HygiSeal
U_B_60/750+150	2	750 mm	Ø 60 mm	150 mm	500 cc	60 cc
U_B_89/750+150	3	750 mm	Ø 89 mm	150 mm	700 cc	90 cc
U_B_104/750+150	3	750 mm	Ø 104 mm	150 mm	820 cc	100 cc
U_B_154/750+150	4	750 mm	Ø 154 mm	150 mm	1.100 cc	150 cc
U_B_204/750+150	5	750 mm	Ø 204 mm	150 mm	1.640 cc	200 cc
U_B_60/1000+150	2	1.000 mm	Ø 60 mm	150 mm	500 cc	60 cc
U_B_89/1000+150	3	1.000 mm	Ø 89 mm	150 mm	700 cc	90 cc
U_B_104/1000+150	3	1.000 mm	Ø 104 mm	150 mm	820 cc	100 cc
U_B_154/1000+150	4	1.000 mm	Ø 154 mm	150 mm	1.100 cc	150 cc
U_B_204/1000+150	5	1.000 mm	Ø 204 mm	150 mm	1.640 cc	200 cc

2 Stainless steel U-barrier with base plate (flange)

HS-Code stainless steel barriers 73 26 90 98

	Impact class	A	B	Ø base plate	# Chemfix	# HygiSeal
U_B_60/750FL	2	750 mm	Ø 60 mm	Ø 131 mm	160 cc	60 cc
U_B_89/750FL	2	750 mm	Ø 89 mm	Ø 159 mm	160 cc	90 cc
U_B_104/750FL	2	750 mm	Ø 104 mm	Ø 175 mm	160 cc	100 cc
U_B_154/750FL	3	750 mm	Ø 154 mm	Ø 225 mm	160 cc	150 cc
U_B_204/750FL	3	750 mm	Ø 204 mm	Ø 275 mm	160 cc	200 cc
U_B_60/1000FL	2	1.000 mm	Ø 60 mm	Ø 131 mm	160 cc	60 cc
U_B_89/1000FL	2	1.000 mm	Ø 89 mm	Ø 159 mm	160 cc	90 cc
U_B_104/1000FL	2	1.000 mm	Ø 104 mm	Ø 175 mm	160 cc	100 cc
U_B_154/1000FL	3	1.000 mm	Ø 154 mm	Ø 225 mm	160 cc	150 cc
U_B_204/1000FL	3	1.000 mm	Ø 204 mm	Ø 275 mm	160 cc	200 cc

The U-barrier is also available with additional intermediate tube. Length and height variabel on request.

Article code = DU_B_...



STAINLESS STEEL PI-BARRIER

WITH CONCRETE CORE

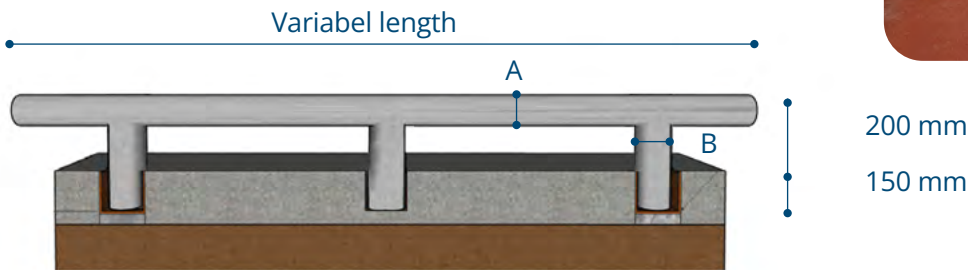

Stainless steel PI-barrier for core drilling



	Impact class	Length	# foot	A	B	# Chemfix	# HygiSeal
PI_B_89/60/200+150	3	<2.200 mm	2	Ø 89 mm	Ø 60 mm	500 cc	60 cc
PI_B_104/89/200+150	3	<2.200 mm	2	Ø 104 mm	Ø 89 mm	700 cc	90 cc
PI_B_89/60/200+150 3P	3	>2.200 < 3.000 mm	3	Ø 89 mm	Ø 60 mm	750 cc	90 cc
PI_B_104/89/200+150 3P	3	>2.200 < 3.000 mm	3	Ø 104 mm	Ø 89 mm	1.050 cc	135 cc

HS-Code stainless steel barriers 73 26 90 98

STAINLESS STEEL CUSTOM SIZED-BARRIER

WITH CONCRETE CORE

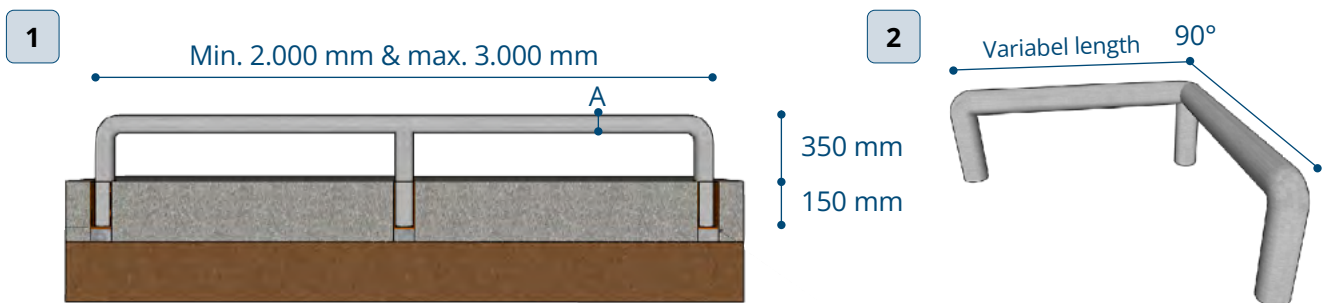

1 Stainless steel Custom sized-barrier for core drilling

	Impact class	Height	A	# Chemfix	# HygiSeal
TU_B_60/350+150	2	350 + 150 mm	Ø 60 mm	750 cc	90 cc
TU_B_89/350+150	3	350 + 150 mm	Ø 89 mm	1.050 cc	135 cc
TU_B_104/350+150	4	350 + 150 mm	Ø 104 mm	1.230 cc	150 cc

2 Stainless steel Custom sized corner-barrier for core drilling

	Impact class	Height	A	# Chemfix	# HygiSeal
LU_B_60/350+150	2	350 + 150 mm	Ø 60 mm	750 cc	90 cc
LU_B_89/350+150	3	350 + 150 mm	Ø 89 mm	1.050 cc	135 cc
LU_B_104/350+150	4	350 + 150 mm	Ø 104 mm	1.230 cc	150 cc

INSTALLATION TIMES

	Core drilling in construction floor		With base plate (4 M16 anchors)	
Bollards	30 min	1 installer	20 min	1 installer
Barriers	1 hour	2 installers	40 min	2 installers

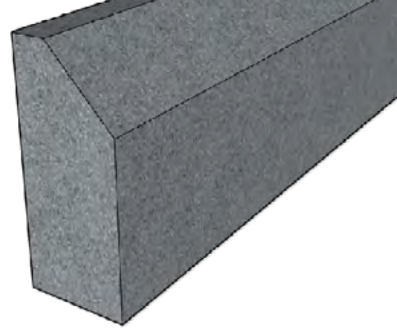

LOGISTIC IMPACT PROTECTION

PREFABRICATED CONCRETE KERB IBR35

PolySto IBR35, a full core concrete kerb, perfectly suited as a robust wall protection in logistics spaces and freezer environments. This concrete logistic kerb can not be applied in area's where hygiene and food safety standards are required. For hygienic wall protection please consult our **CleanRock or stainless steel range**.



IBR35



Internal corner

External corner

End piece

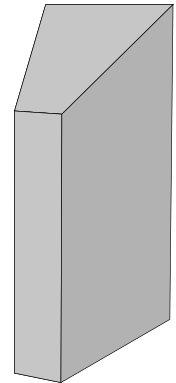
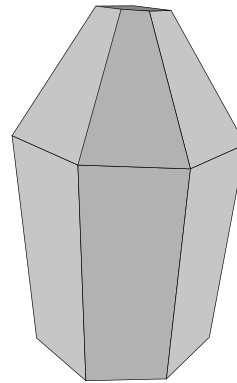
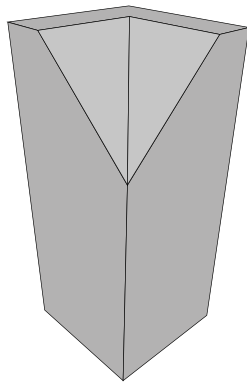
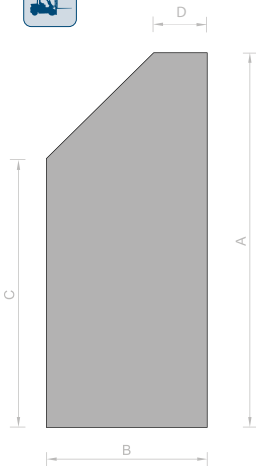

	Impact class	Length	A	B	C	D	Weight / pc	# per pallet
IBR35	4 or 5*	1.000 mm	350 mm	150 mm	250 mm	50 mm	120 kg	12 pc

IBR35	Internal corner (IN)			External corner (EX)			End piece left (EL) or right (ER)		
	Length	Weight / pc	# per pallet	Length	Weight / pc	# per pallet	Length	Weight / pc	# per pallet
	150/150 mm	15 kg	70 pc	150/150 mm	15 kg	70 pc	150/150 mm	15 kg	70 pc

* Impact class 5 can be reached when installing kerbs including chemical anchorage. Drilling for anchorage to be performed on site using drilling mold.

HS-Code concrete kerbs 39 25 90 80



POLYETHYLENE LOGISTIC KERB

PolySto designed a very strong polyethylene wall protection to avoid heavy damages in busy warehousing environments. A galvanized L-profile is mounted on the construction floor using M16 anchors. A single (or double) PE500 kerb is installed on top of the galvanized L-profile and secured using hexagonal bolts every 50 cm.

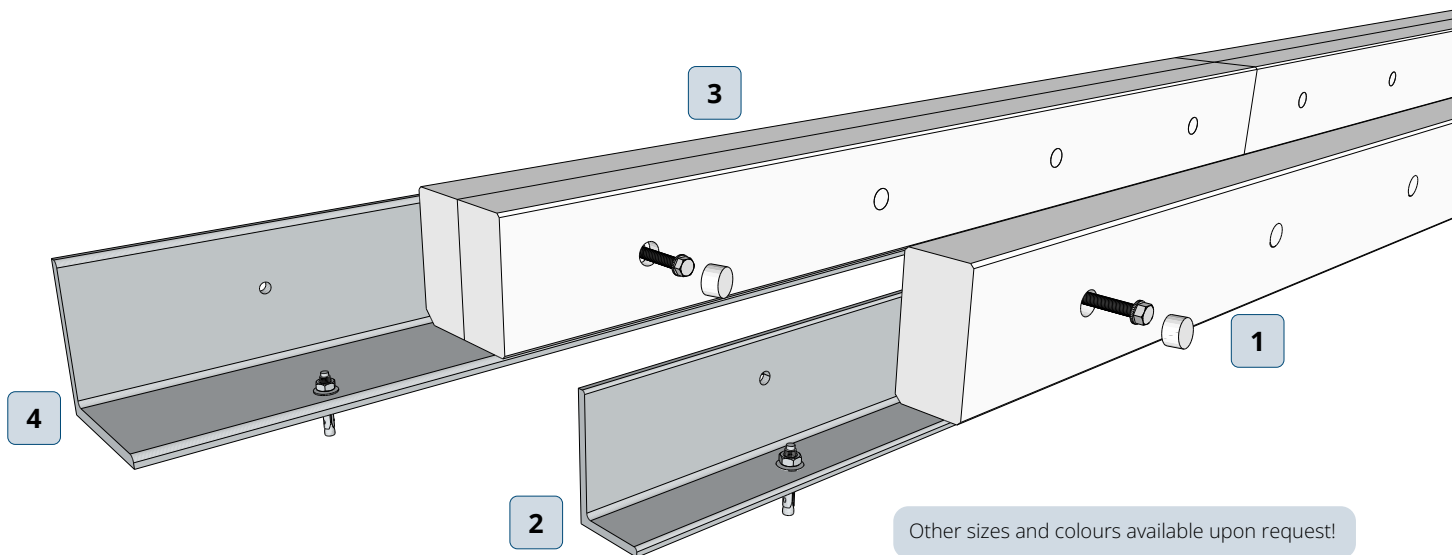

Other sizes and colours available upon request!

	No.	Length	Height	Width	Thickness	# drillings	Weight / pc
PE2000x200x100	1	2.000 mm	200 mm	-	100 mm	every 50 cm	38,40 kg
GALVA PROFILE 10	2	5.990 mm	150 mm	90 mm	10 mm	every 50 cm	116,40 kg
PE2000x200x200	3	2.000 mm	200 mm	-	2 x 100 mm	every 50 cm	296,40 kg
GALVA PROFILE 16	4	5.990 mm	200 mm	200 mm	16 mm	every 50 cm	8,64 kg

	PE500
Colour	standard Natural (white)
Temperature range	-100°C / +80°C
Density	0,96 g/cm ³ (DIN EN ISO 1183-1)
HS-Code	39 26 90 97

This PE logistic kerb can not be applied in area's where hygiene and food safety standards are required.

For hygienic wall protection please consult our **CleanRock range**.

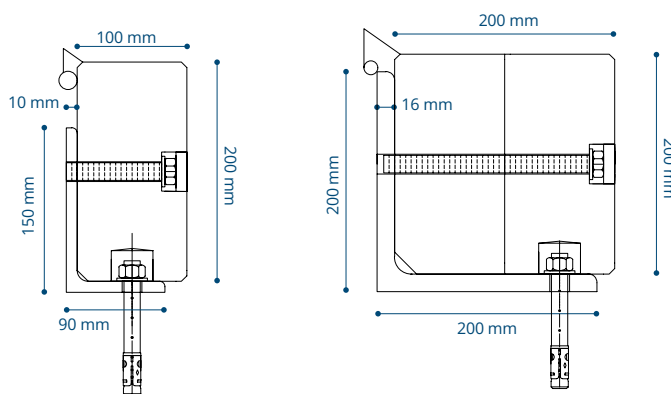

STAINLESS STEEL DRAINAGE SYSTEMS

LINEAR DRAINAGE

Round channels

- Fast transfer of fluids to the outlet
- Reduction of bacteria accumulation
- Ecology & efficiency
- Stainless steel AISI304/316 / 2 mm thickness
- Reinforced edges
- Different gratings available
- Load class M 125 kN

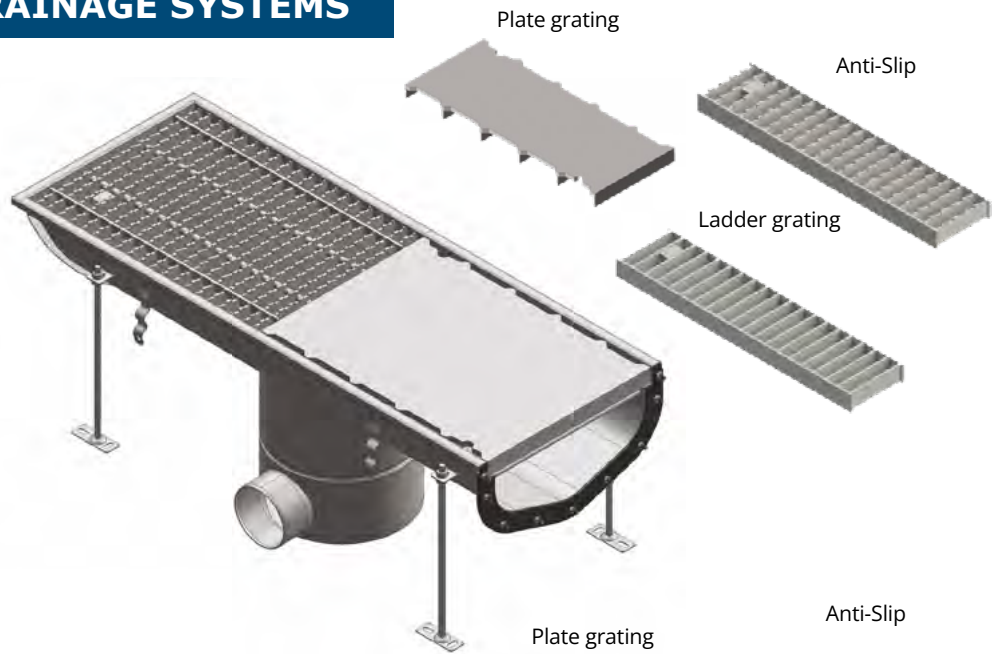

POINT DRAINAGE

Point floor drains

- Highest hygienic design
- Different grates available depending on application
- Easy installation
- Hygienic trap design
- Easy and effective cleaning
- Waste basket/sediment
- Stainless steel AISI304/316 / 2 mm thickness



HYGILIGHT

HYGILIGHT RECESSED



LPRE4000	
Led Panel Recessed	
Dimension	595 x 595 x 16 mm
Material	Aluminum
Power	40 Watt
Lumen	4.000 Lm
Colour temp.	4.000 K
IP rating	IP65
HS-Code	94 05 10 98



CRRE6600	
Led Panel Clean Room Recessed	
Dimension	600 x 600 mm
Material	Zinc coated CRCA sheet finished in epoxy polyester Tempered Glazing
Output	139 lm/W
Colour temp.	4.000 K
Lumen	3 x 2.200 Lm
IP rating	IP 65 (bottom) / IP 54
HS-Code	94 05 10 98



CRRE4400	
Led Panel Clean Room Recessed	
Dimension	300 x 600 mm
Material	Zinc coated CRCA sheet finished in epoxy polyester Tempered Glazing
Output	137 lm/W
Colour temp.	4.000 K
Lumen	2 x 2.200 Lm
IP rating	IP 65 (bottom) / IP 54
HS-Code	94 05 10 98

HYGILIGHT SURFACE MOUNTED



CRSM6600	
Led Panel Clean Room Surface mounted	
Dimension	625 x 625 mm
Material	Zinc coated CRCA sheet finished in epoxy polyester Tempered Glazing
Output	139 lm/W
Colour temp.	4.000 K
Lumen	3 x 2.200 Lm
IP rating	IP 65 (bottom)
HS-Code	94 05 10 98



CRSM4400	
Led Panel Clean Room Surface mounted	
Dimension	314 x 625 mm
Material	Zinc coated CRCA sheet finished in epoxy polyester Tempered Glazing
Output	137 lm/W
Colour temp.	4.000 K
Lumen	2 x 2.200 Lm
IP rating	IP 65 (bottom)
HS-Code	94 05 10 98

LED STRIPS



LED STRIPS	
Dimension	5.000 mm. Option to cut every 10 cm
Size	12x4mm
Lumen	1.010 Lm / meter
Colour temp.	4.000K (Pure white)
Strip	60 LED / meter
CRI	90
IP rating	IP68
HS-Code	94 05 10 98



HYGIENIC WALL BOOTS



Pipe connections through walls are often insufficiently finished and sealed, resulting in a higher risk of bacterial contamination.

Our **hygienic wall boots** are self-sealing and, in contrast to steel or plastic rosettes, completely flexible. They stay in place and remain permanently sealed, despite pipe vibrations and movements.

The wall boots consist of a silicone-based casing and stainless steel baseplate (316). Their innovative design not only ensures a long-lasting hygienic seal but also simplifies maintenance by preventing dirt and bacteria buildup around the pipe connection. This makes the wall boots ideal for food processing, pharmaceutical, and other industries where strict hygiene standards are critical.

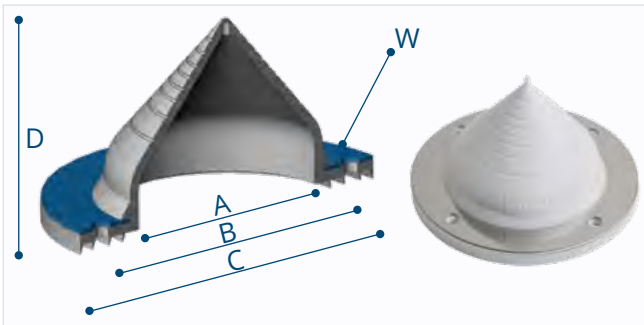

For new installations

	A	B	C	D	W
MD_N_0-25	30 mm	57 mm	70 mm	52 mm	6.2 mm
MD_N_0-65	64 mm	91 mm	106 mm	60 mm	6.2 mm
MD_N_0-95	100 mm	128 mm	147 mm	78 mm	6.2 mm
MD_N_70-135	140 mm	168 mm	187 mm	64 mm	6.2 mm
MD_N_100-180	180 mm	213 mm	237 mm	84 mm	6.2 mm

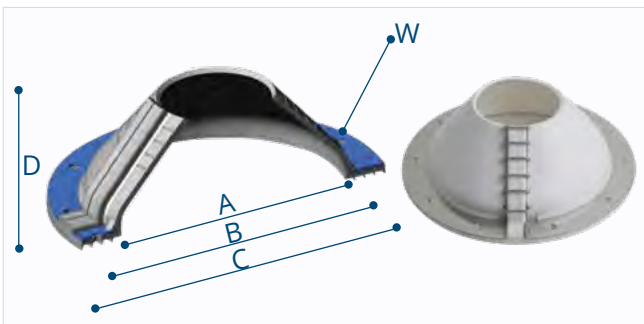

With zipper for renovation

	A	B	C	D	W
MD_R_0-65	64 mm	91 mm	106 mm	60 mm	6.2 mm
MD_R_0-95	100 mm	128 mm	147 mm	78 mm	6.2 mm
MD_R_70-135	140 mm	168 mm	187 mm	64 mm	6.2 mm
MD_R_100-180	180 mm	213 mm	237 mm	84 mm	6.2 mm

HS-Code wall boots

40 16 93 00

HYGICRYSTAL

CLIPS WINDOWS

PolySto clips windows are precision-engineered with extruded aluminum frames in various profiles for perfect fit. Features laminated glass glazing, hygroscopic crystals for condensation prevention, and custom options.



- ✓ Easy installation
- ✓ Clipped on 1 side
- ✓ Custom made
- ✓ Extruded aluminium (Option stainless steel)
- Wall thickness
 - 40 mm
 - 60 mm
 - 80 mm
 - 100 mm



SURFACE MOUNTED WINDOWS

Surface mounted windows provide a suitable solution for interior spaces, including (partition) walls, while adhering to food safety standards. Designed to prevent dirt accumulation and withstand specific conditions such as temperature, humidity, and noise.

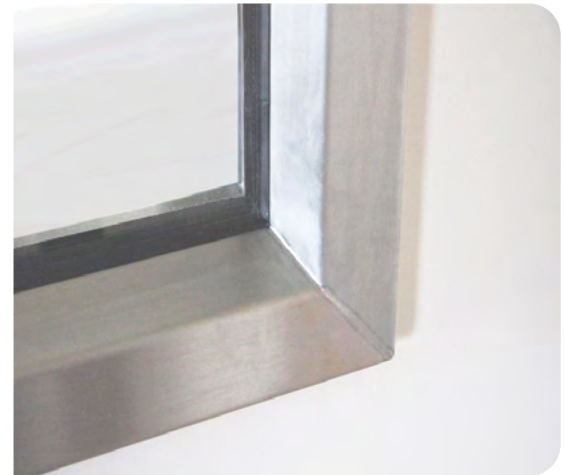

- ✓ Food Safe & easy installation
- ✓ Welded corners
- ✓ Insulating glazing including anti-splinter film
- insulated glazing Rc value 1.3 W/m². K
- Standard size 900 x 1.200 mm (viewing size)
- Custom made sizes possible
- Wall thickness
 - 80 mm
 - 100 mm
 - 120 mm
 - 140 mm
 - 170 mm
 - 200 mm



HYGIDOOR

PolySto industrial (coldroom) doors combine durability, hygiene, and aesthetic appeal, making it a versatile choice for various settings. Constructed from CleanSheet and PU insulation, our doors ensure robustness and easy maintenance. They are ideal for cold, wet and damp environments. The unique frame system caters to different wall thicknesses, ensuring a seamless fit. Double hinged doors are available upon request.



INDUSTRIAL DOOR	
Insulated, durable temperature-controlled areas above 0°C	
Door leaf	Thickness 60 mm
	Stainless steel profile
	CleanSheet surface
Door frame	Stainless steel
	Broken thermal bridge
	Beveled edges
Door fittings	Heavy-duty hinges with disc bearings
	Stainless steel handle
Standard size	Single leaf 900 x 2.300 mm
	Single leaf 1.200 x 2.300 mm
	Double leaf 1.800 x 2.300 mm



INDUSTRIAL SLIDING DOOR	
Insulated, durable for cooling, freezing from -20°C to +12°C	
Door leaf	Thickness 80 mm
	Stainless steel profile
	CleanSheet surface
	U-value 0.264 W/m ²
Door frame	Stainless steel
	Broken thermal bridge
	Welded corners
Railsystem	Included
Standard size	900 x 2.300 mm
	1.000 x 2.300 mm
	1.200 x 2.300 mm
	1.800 x 2.300 mm
	2.000 x 2.500 mm
	2.500 x 3.000 mm

Industrial hingest door with robust design suitable for intensive use in High Care food production and storage areas or as a partition between indoor and outdoor environments.

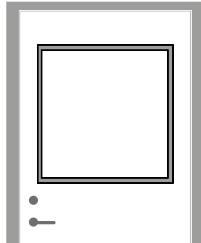

Available option Square window

The industrial sliding door has been developed for daily intensive use in refrigerated, freezer, and temperature-controlled areas with an elevated food safety risk. Design in accordance with hygienic guidelines, featuring beveled edges and rounded components to prevent the accumulation of dirt or rinse water. The robust stainless steel door leaf frame, welded at the corners, provides additional protection against potential damage.





HYGIENIC DOOR	
Hygienic, hard-wearing	
Door leaf	Thickness 40 mm
	Aluminium profile
	CleanSheet RAL 9010
	Core of CFC-free polyurethane
Door frame	Anodized aluminium
	From 74 - 200 mm wall thickness
Door fittings	Hinges: Dorma 4005
	Lock housing: Assa 565
	Handle: Dorma DH 720



HYGIENIC SLIDING DOOR	
Hygienic, hard-wearing	
Door leaf	Thickness 40 mm
	Aluminium profile
	CleanSheet RAL 9010
	Core of CFC-free polyurethane
Frame	Anodized aluminium
	From 70 - 195 mm wall thickness
Railsystem	Included

The Hygienic Door features a CleanSheet (FRP) door leaf with 40mm polyurethane insulation. Available as single or double doors, it can include a vision panel with laminated or thermopane glass.

The Hygienic Sliding Door is fully moisture-proof, featuring a CleanSheet door leaf with a shock-resistant aluminum edge and a polyurethane core. It includes sealing strips and a bottom guide for added functionality. The sliding door can also be equipped with an automation system

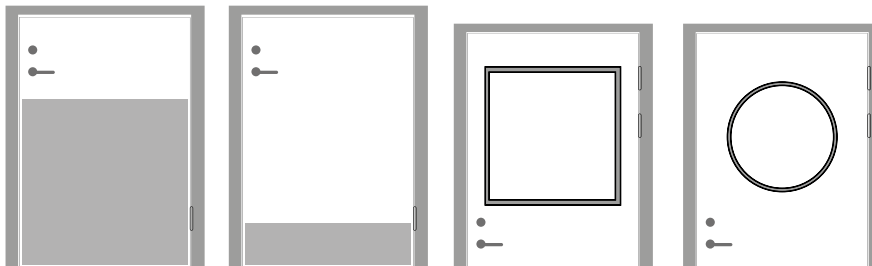

Various options available

Large kickplate

Small kickplate

Square window

Round window





INSTALLATION MATERIALS

GLUE AND SEALANTS

HygiSeal 3.1 is our preferred one-component hybrid polymer sealant, specially designed for durable and hygienic joints in environments with stringent hygiene standards. Ideal applications include cleanrooms, laboratories, production areas, wet rooms, packaging areas, kitchens, and more.

HYGISEAL 3.1	
Chemical welding of joints	
Article code	HS3.1 RAL 9016
	HS3.1_9002 RAL 9002
	HS3.1_7004 RAL 7004
Material	1-component hybrid sealant
Package	Bag 600cc
Weight	1,1 kg
Amount	12 pc / box
	792 pc / pallet
HS-code	32 14 10 10
Suitable for	CleanSheet and panels, kerbs, bollards and barriers, joints between sandwich panels, etc...

RAL 9016
Traffic White

RAL 7004
Signal Grey

RAL 9002
Grey White

HygiSeal 2.0 is the sealing solution when fast curing is essential. With a curing time of approximately 15 minutes, it ensures quick and reliable sealing in environments where speed and efficiency are critical, such as repairs, urgent installations, or time-sensitive projects.

HYGISEAL 2.0		
Chemical welding of joints		
Article code	HS2.0	White
Material	2-component PU sealant	
Package	Cartridge 620cc	
Weight	1,1 kg	
Amount	10 pc / box	
	600 pc / pallet	
HS-code	35 06 10 00	
Suitable for	CleanSheet and panels, kerbs, bollards and barriers, joints between sandwich panels, etc...	
NHS2.0	Set with 10 mixing tubes for HygiSeal 2.0	

White

Food Safe Sealant is our one-component silicone sealant designed for applications requiring permanent elasticity. It is perfect for expansion joints and for sealing the lower connection between floors and PolySto kerbs, ensuring a food-safe finish in compliance with industry standards.

FOOD SAFE SEALANT	
High quality, neutral and elastic silicone	
Article code	SSW_600 RAL 9010
	SS9002_600 RAL 9002
	SSG_600 Transp. grey
Material	Silicone (polysiloxane)
Package	Bag 600cc
Weight	0,64 kg
Amount	12 pc / box
	792 pc / pallet
HS-code	32 14 10 10
Suitable for	Flexible joint in food safe environments

RAL 9010
Traffic White

RAL 9002
Grey White

Transp. Grey

Hard Fix Glue is a high-performance one-component hybrid polymer adhesive delivering strong bonding strength for materials like CleanRock, CleanSheet, PVC, stainless steel, etc... With its lasting flexibility, resistance to moisture, fast curing, and non-toxic formulation, PolySto Hard Fix Glue is perfect for demanding environments, including food, medical, and pharmaceutical industries.

HARD FIX GLUE		
Universal adhesive sealant (glue)		
Article code	HFG_600	White
Material	MS polymer	
Package	Bag 600cc	
Weight	0,92 kg	
Amount	12 pc / box	
	792 pc / pallet	
HS-code	35 06 10 00	
Suitable for	CleanSheet and panels, kerbs and other pre-fab elements.	

White

PERSONAL PROTECTIVE EQUIPMENT



MASK	
FFP3 mask against dust particles arising upon cutting FRP or CleanRock kerbs	
Package	5 pc / box
Weight	0,9kg
HS-Code	63 07 90 95



SAFETY SET	
Set of safety gloves, safety glasses and hearing protection	
Weight	1,5 kg
HS-Code	40 15 90 30

TOOLS AND EQUIPMENT



GM_600	
Manual caulking gun	
Weight	0,98 kg
HS-Code	84 13 20 00
Suitable for	HygiSeal, Hard Fix Glue & Food Safe Sealant



GP_600	
Pneumatic caulking gun	
Weight	0,95 kg
HS-Code	84 67 19 00
Suitable for	HygiSeal, Hard Fix Glue & Food Safe Sealant



GB_600	
5.0 A / 18 V Battery driven caulking gun	
Weight	1,95 kg
HS-Code	84 67 29 90
Suitable for	HygiSeal, Hard Fix Glue & Food Safe Sealant



GM_HS2.0	
Manual two-component caulking gun	
Weight	2,10 kg
HS-Code	82 05 59 80
Suitable for	HygiSeal 2.0



GP_HS2.0	
Pneumatic two-component caulking gun	
Weight	3,37 kg
HS-Code	84 67 19 00
Suitable for	HygiSeal 2.0



ST25	
Sealant tape 20 mm diameter	
Weight	0,50 kg
Package	25 m/box
HS-Code	39 19 10 19
Suitable for	PolySto kerbs



TB50	
Tape for finishing Hygiseal joints on embossed CleanSheet and kerbs	
Package	1 rol = 50 m 44 pc / box
Weight	0,55 kg
HS-Code	39 19 10 12



TG55	
Tape for finishing HygiSeal joints on smooth CleanSheet	
Package	1 rol = 55 m 40 pc / box
Weight	0,34 kg
HS-Code	39 19 10 12





SM_CLEANSHEET	
Scraper tool	
Weight	0,10 kg
HS-Code	39 26 90 97
Suitable for	HygiSeal application CleanSheet walls and ceilings



SM_KERBS	
Set of 5 scraper tools	
Weight	0,30 kg
HS-Code	39 26 90 97
Suitable for	HygiSeal application PolySto kerbs and skirtings

CHEMICAL ANCHORAGE

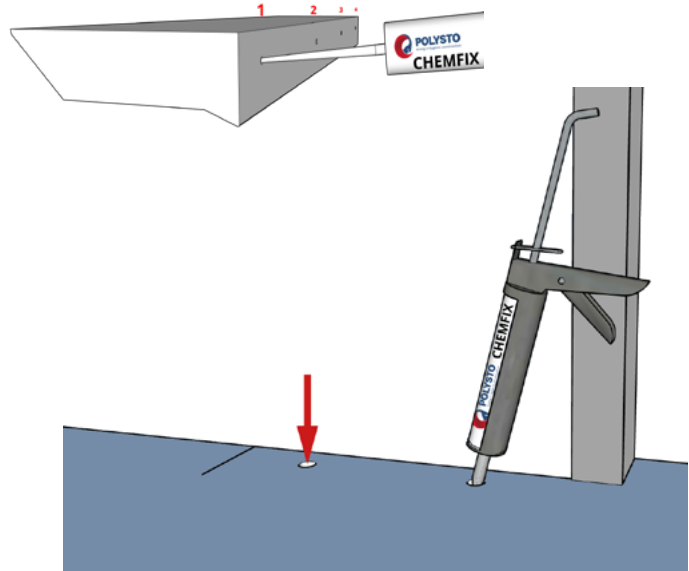
ChemFix is a two-component chemical anchoring injection system. Chemfix is specially developed to anchor threaded rods, stainless steel posts, and barriers into construction floors. With its high-strength bonding properties, ChemFix ensures a long-lasting and robust solution for industrial and hygienic environments.

CHEMFIX	
Chemical anchorage	
Article code	CHEM
Material	Polyester resin
Package	Tube 410 cc
Weight	0,85 kg
Amount	12 pc / box 1.344 pc / pallet
HS-Code	38 16 00 00
Suitable for	Kerbs, bollards and barriers

MIXED GREY



GM_410	
Manual caulking gun	
Weight	1 kg
HS-Code	84 13 20 00
Suitable for	Chemfix



GP_410	
Pneumatic caulking gun	
Weight	1 kg
HS-Code	84 67 19 00
Suitable for	Chemfix



BM		
Drilling mold		
Article	Length	Weight
BM-50	500 mm	1,1 kg
BM-100	1.000 mm (IBR35)	1,9 kg
BM-150	1.500 mm	2,88 kg
HS-Code	72 16 21 00	

KERB INSTALLATION EQUIPMENT



TROLLEY	
Trolley for kerb installation	
Weight	25 kg
HS-Code	84 27 90 00
Suitable for	Kerbs impact level 3,4 and 5



VACUUM	
Vacuum system for lifting kerbs	
Lift to	250 kg
Power	12V battery
HS-Code	84 28 90 90
Suitable for	Kerbs

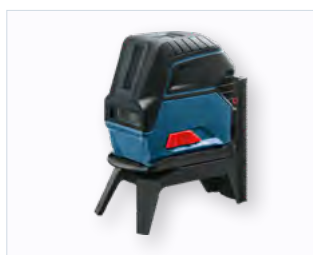

LASER	
Alignment laser	
Weight	1,2 kg
HS-Code	90 13 20 00
Suitable for	CleanSheet walls and ceilings, PE wall ledges, kerbs



PEGS	
Installation pegs 100 mm	
Package	100 pc / bag
Weight	0,7 kg
HS-Code	39 26 90 97
Suitable for	All kerbs and skirtings



COMPR	
Air compressor	
Motor	230V - 2,5PK
Output	360L/min - 25L
Weight	15 kg
HS-Code	84 14 40 10
Suitable for	Pneumatic caulking guns



CROWBAR_S	
Plastic pinch bar to level kerbs and skirtings	
Weight	1 kg
HS-Code	82 05 20 00
Suitable for	Kerbs and skirtings with impact level 1 and 2



CROWBAR_L	
Steel pinch bar to level kerbs	
Weight	1,5 kg
HS-Code	82 05 59 80
Suitable for	Kerbs with impact level 3 and 5



CUTMACH45 350	
Cutting machine 45°	
Motor	2.2 KW - 3.0 hp 220V
Saw blade	ø350 mm
Maximum cutting depth	110 mm 45° max 80 mm
Weight	80 kg
HS-Code	84 64 10 00
Suitable for	Kerbs up to 100 mm thickness (at foot)
DIAM350	Diamant cutting blade 350 mm



CUTMACH45 700	
Cutting machine 45°	
Motor	4 kW - 5.5 hp 400V
Saw blade	ø700 mm
Maximum cutting depth	275 mm 45° max 180 mm
Weight	118 kg
HS-Code	84 64 10 00
Suitable for	Kerbs up to 115 mm thickness (at foot)
DIAM700	Diamant cutting blade 700 mm



ROLCUT	
Rolling conveyor table for cutting machine	
Weight	25 kg
HS-Code	84 61 50 11
Suitable for	CUTMACH45 350 CUTMACH45 700

Other sizes of cutting machinery and spare parts are available on request

CLEANSHEETS AND PANELS - INSTALLATION EQUIPMENT



PRS	
Rubber pressure roller	
Adjustable from 17" to 27"	
Weight	1,2 kg
HS-Code	96 03 40 90
Suitable for	FRP sheets and panels



PRL	
Rubber pressure roller	
Adjustable from 36" to 68"	
Weight	1,86 kg
HS-Code	96 03 40 90
Suitable for	FRP sheets and panels

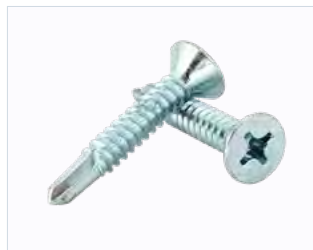

SDS_3,5*16	
Self-drilling screws	
Package	200 pc / box
Weight	0,2 kg
HS-Code	73 18 14 99
Suitable for	Installation of full PVC round coving



HFGP	
Primer for Hard Fix Glue	
Package	Bottle of 1 L
Weight	1,42 kg
HS-Code	29 15 31 00
Suitable for	Improves adhesion of hybrid sealants on several surfaces



NP30	
Nylon plug for quick fastening of FRP sheets in concrete, brick stone, sandwich panels and other materials.	
Package	500pc / box
Length	30 mm
Weight	0,52 kg
HS-Code	73 18 19 00



NP40	
Nylon plug quick fastening of RenoPanel and RamPanel in concrete, brick stone, sandwich panels and other materials.	
Package	400pc / box
Length	40 mm
Weight	0,52 kg
HS-Code	73 18 19 00



NP50	
Nylon plug for quick fastening of InsuPanel (max 30 mm thickness) in concrete, brick stone, sandwich panels and other materials.	
Package	300pc / box
Length	50 mm
Weight	0,52 kg
HS-Code	73 18 19 00



ACHS	
Cutting blade for RamPanel	
Article	Diameter
ACHS_DIA160_1	Ø 160 mm
ACHS_DIA190_1	Ø 190 mm
ACHS_DIA225_1	Ø 225 mm
ACHS_DIA300_1	Ø 300 mm
HS-Code	82 02 99 20

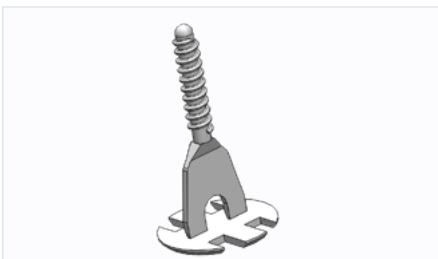

SPACER_BASE	
Spacer to level CleanSheet laminated panels	
Adjustable from 3 to 23 mm	
Package	250 pc / box
Suitable for	RamPanel and RenoPanel



SPACER_CAP	
Spacer to level CleanSheet laminated panels	
Adjustable from 3 to 23 mm	
Package	250 pc / box
Suitable for	RamPanel and RenoPanel



OTHER INSTALLATION EQUIPMENT

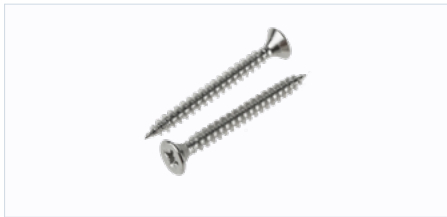

PESCREW5X60	
Screw Inox A2 - 5x60 mm	
Material	Stainless steel
Package	200 pc per box
Weight	0,615 kg
HS-Code	73 18 15 30
Suitable for	Polyethylene strips (model 2-5)



PESCREW5X100	
Screw Inox A2 - 5x100 mm	
Material	Stainless steel
Package	100 pc per box
Weight	0,60 kg
HS-Code	73 18 15 30
Suitable for	Polyethylene strips (model 1)



PEPLUG	
Nylon plug 6x50mm	
Material	Plastic
Package	100 pc per box
Weight	0,30 kg
HS-Code	39 26 90 97
Suitable for	Screw Inox A2

MAINTENANCE & REPAIR



HYGICLEAN1	
Cleaner for organic soiling	
Base	Cleaning agent, alcohol, additives, fragrance and demineralised water
Package	Bottle of 1 L + dispen
Weight	1,1 kg
HS-Code	34 02 90 10
Suitable for	FRP sheets and panels, kerbs and skirtings



DEGREASER	
Degreaser for removal of dust, adhesive residues and other markings	
Base	Mixed aliphatic hydrocarbons
Package	Bottle of 1 L
Weight	1 kg
HS-Code	34 02 90 10
Suitable for	See TDS



STAINLESS STEEL CLEANER	
Stainless steel cleaner	
Package	Bottle of 500 ml
Weight	1 kg
HS-Code	29 15 31 00
Suitable for	Stainless steel kerbs, profiles and bollards and barriers



HYGIGUM	
Cleaning sponge to remove soiling from hard surfaces	
Base	Compressed melamine
Package	10 pc / package
Weight	0,08 kg
HS-Code	39 24 90 00
Suitable for	FRP sheets and panels, kerbs and skirtings



HYGISWIPES	
Hygi Swipes to clean hands, tools or surfaces	
Base	Pre-moistened wipes
Package	72 pc per container
Weight	1,20 kg
HS-Code	34 01 19 00

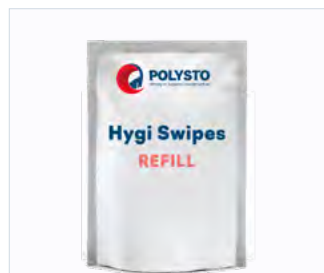

HYGISWIPES_REFILL	
Refill for container Hygi Swipes	
Base	Pre-moistened wipes
Package	Bag with 72 swipes
Weight	1,05 kg
HS-Code	34 01 19 00



REP_SANICOAT_1kg	
Repair kit for Sanicoat kerbs	
Base	2-component kit with gelcoat resin with hardener
Package	Bottle of 1 kg
Weight	1,06 kg
HS-Code	39 07 91 10



REP_NATURAL_1kg	
Repair kit for Natural kerbs	
Base	2-component kit with CleanRock resin with hardener
Package	Bottle of 1 kg
Weight	1,06 kg
HS-Code	39 07 91 10

200 gram repair kits are available on request.

POLYSTO COMMUNITY

Join the **PolySto community** and gear up with our range of **workwear** including T-shirts, hoodies, high-visibility vests, and safety helmets to stand out on the job site. Our apparel comes in all sizes from Small to XXXL, ensuring a perfect fit for everyone.

T-shirts



Sweatshirts



High-visibility vests

Tip for our Master Installers

3M Safety helmets



Conference binders



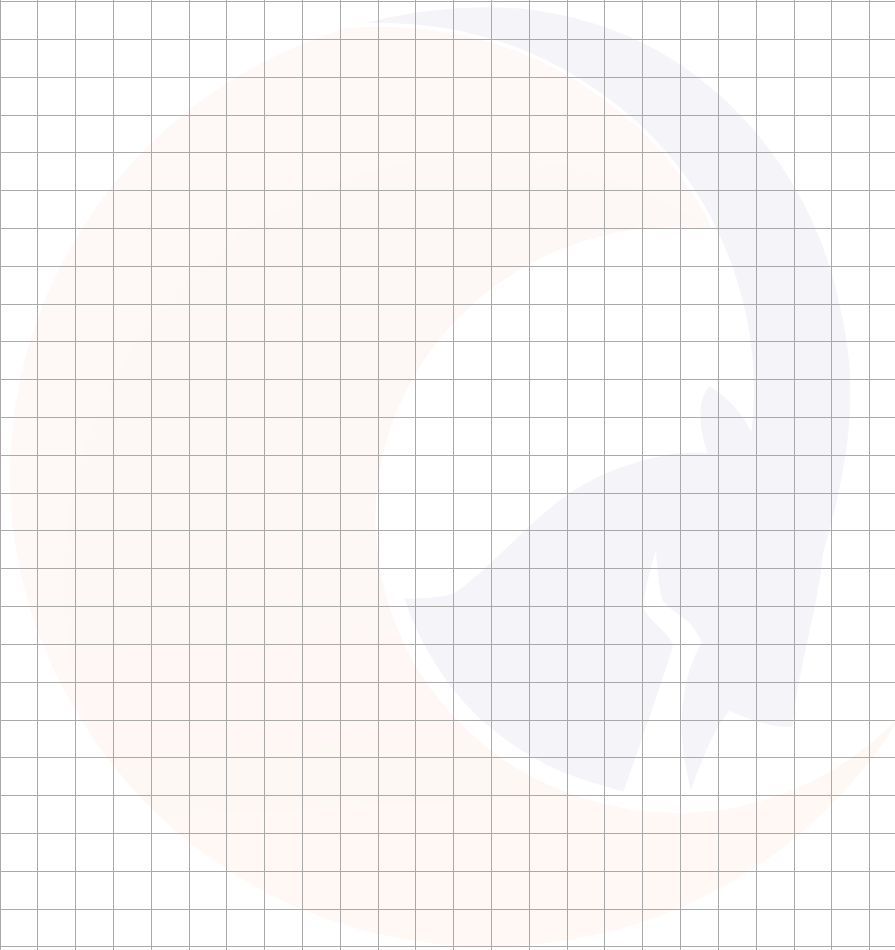

Distributed by

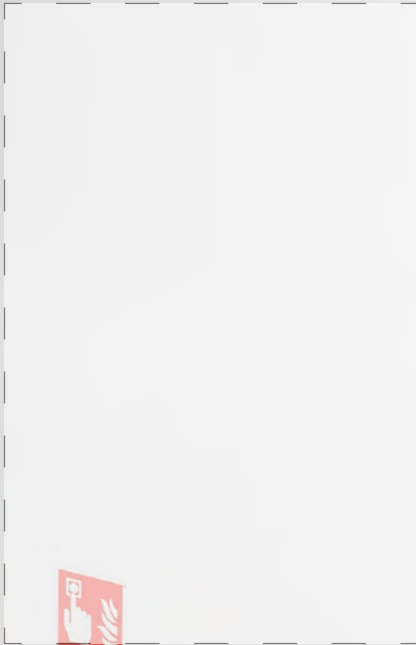

POLYSTO GROUP BV
Maesbossen 3
9160 Lokeren
Belgium

Tel: +32 (0) 9 33 77 66 0
VAT: BE 0895.050.870
www.polysto.com

Contact us:
info@polysto.com
quotations@polysto.com
orders@polysto.com

